

FINAL SURVEY	DATE
SURVEYED	BY
PLOTTED	
NOTE BOOK	
AREAS CHECKED	
NO.	

ORIGINAL SURVEY	DATE
SURVEYED	BY
PLOTTED	
NOTE BOOK	
AREAS CHECKED	
NO.	

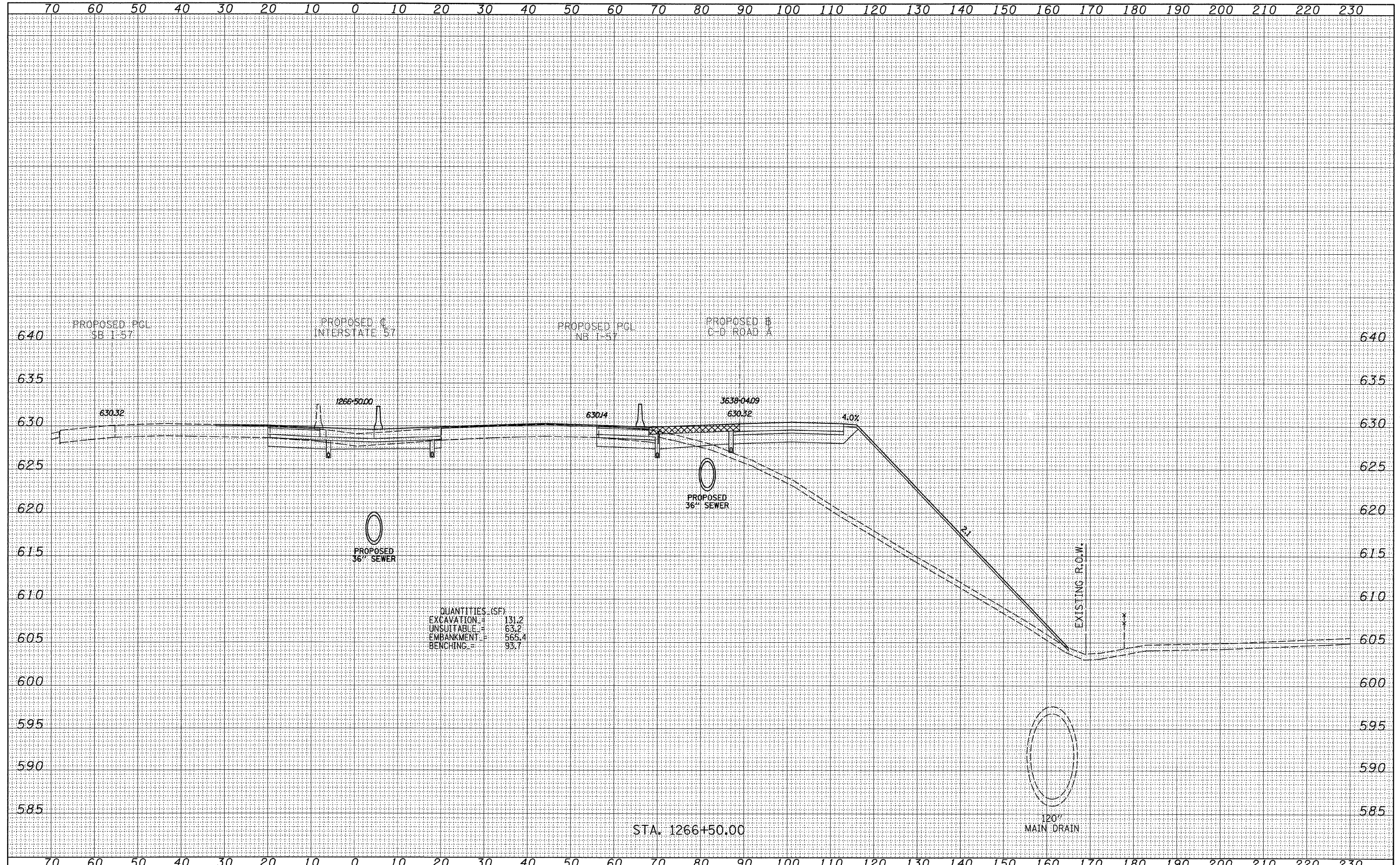

QUANTITIES (SF)

EXCAVATION	=	131.2
UNSUITABLE	=	63.2
EMBANKMENT	=	565.4
BENCHING	=	93.7

STA. 1266+50.00

TYLIN INTERNATIONAL

USER NAME =	DESIGNED - JDF	REVISED - 4/29/2010
PLLOT SCALE =	DRAWN - JDF	REVISED -
PLLOT DATE =	CHECKED - JPM	REVISED -
	DATE - 3/18/2010	REVISED -

**STATE OF ILLINOIS
DEPARTMENT OF TRANSPORTATION**

I-57 AT I-294 INTERCHANGE PROJECT		F.A.I. RTE.	SECTION	COUNTY	TOTAL SHEETS	SHEET NO.
SCALE: 1" = 10' V		57	1414.2B	COOK	516	514
SHEET NO. OF SHEETS		STA. 1266+50.00 TO STA. 1266+50.00		CONTRACT NO. 60J27		

F.A.I. RTE.	SECTION	COUNTY	TOTAL SHEETS	SHEET NO.
57	1414.2B	COOK	516	514
FED. ROAD DIST. NO. ILLINOIS FED. AID PROJECT				

P:\602540(57-294)\Road\PI.157 BR\PI.57XS_SHT_R.dgn