

DATE	
BY	
FINAL SURVEY	
SURVEYED	
PLOTTED	
NOTE BOOK	
AREAS CHECKED	
NO.	

DATE	
BY	
ORIGINAL SURVEY	
SURVEYED	
PLOTTED	
NOTE BOOK	
AREAS CHECKED	
NO.	

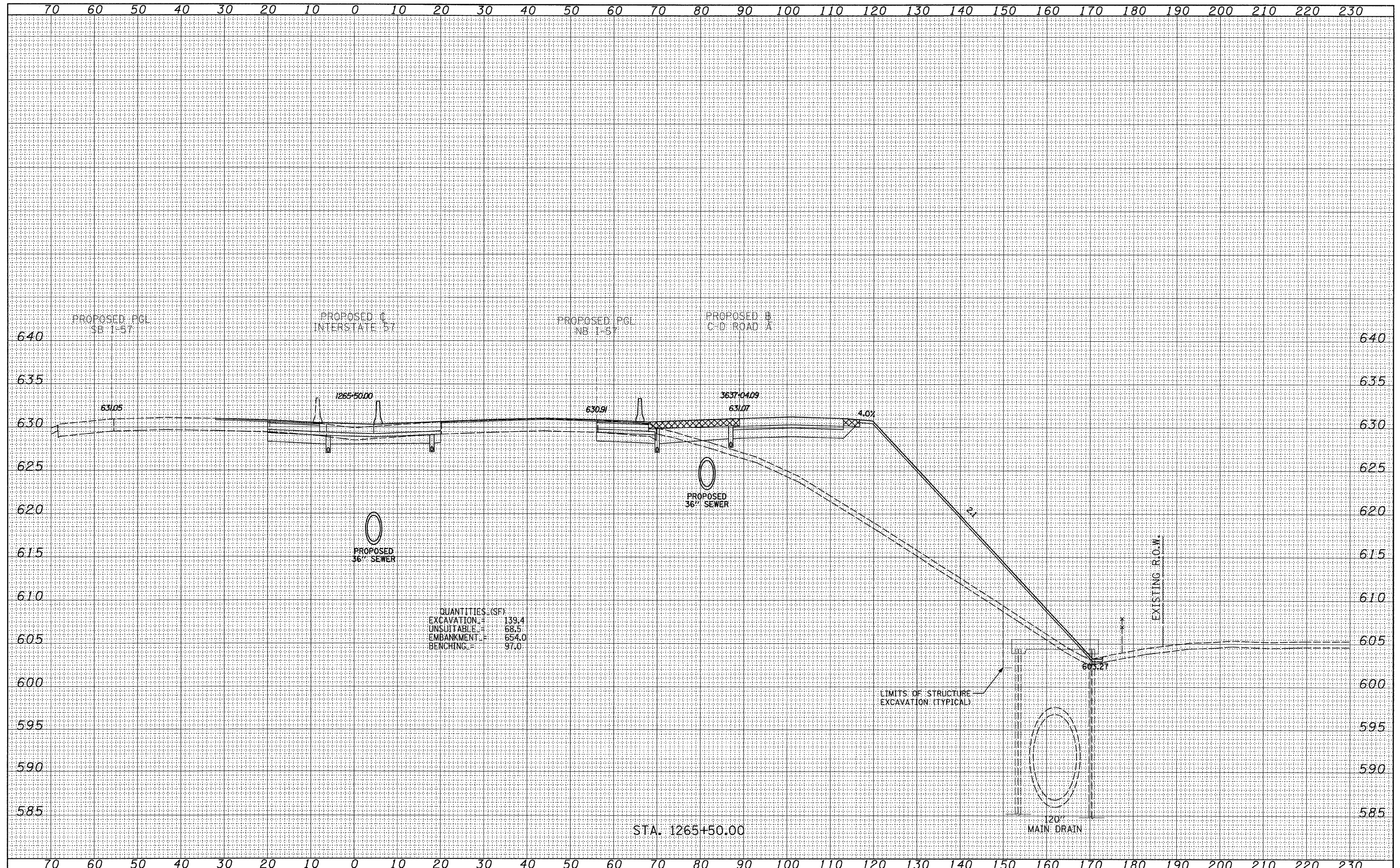

QUANTITIES (SF)

EXCAVATION	=	139.4
UNSUITABLE	=	68.5
EMBANKMENT	=	654.0
BENCHING	=	97.0

STA. 1265+50.00

TYLIN INTERNATIONAL USER NAME = PLOT SCALE = PLOT DATE =	DESIGNED - JDF	REVISED - 4/29/2010	STATE OF ILLINOIS DEPARTMENT OF TRANSPORTATION	I-57 AT I-294 INTERCHANGE PROJECT PROPOSED I-57 CROSS SECTIONS		F.A.I. RTE. 57	SECTION 1414.2B	COUNTY COOK	TOTAL SHEETS 516	SHEET NO. 512	
	DRAWN - JDF	REVISED -		SCALE: 1/4" = 10' V	SHEET NO. OF SHEETS	STA. 1265+50.00 TO STA. 1265+50.00	FED. ROAD DIST. NO.	ILLINOIS	FED. AID PROJECT	CONTRACT NO. 60J27	
	CHECKED - JPM	REVISED -									
	DATE - 3/18/2010	REVISED -									

P:\602540(57-294)\Road\PI_157 BR\PI_57XS_SHT_R.dgn