

|               |      |
|---------------|------|
| FINAL SURVEY  | DATE |
| SURVEYED      | BY   |
| NOTE BOOK     |      |
| AREAS CHECKED |      |
| NO.           |      |

|                 |      |
|-----------------|------|
| ORIGINAL SURVEY | DATE |
| SURVEYED        | BY   |
| NOTE BOOK       |      |
| AREAS CHECKED   |      |
| NO.             |      |

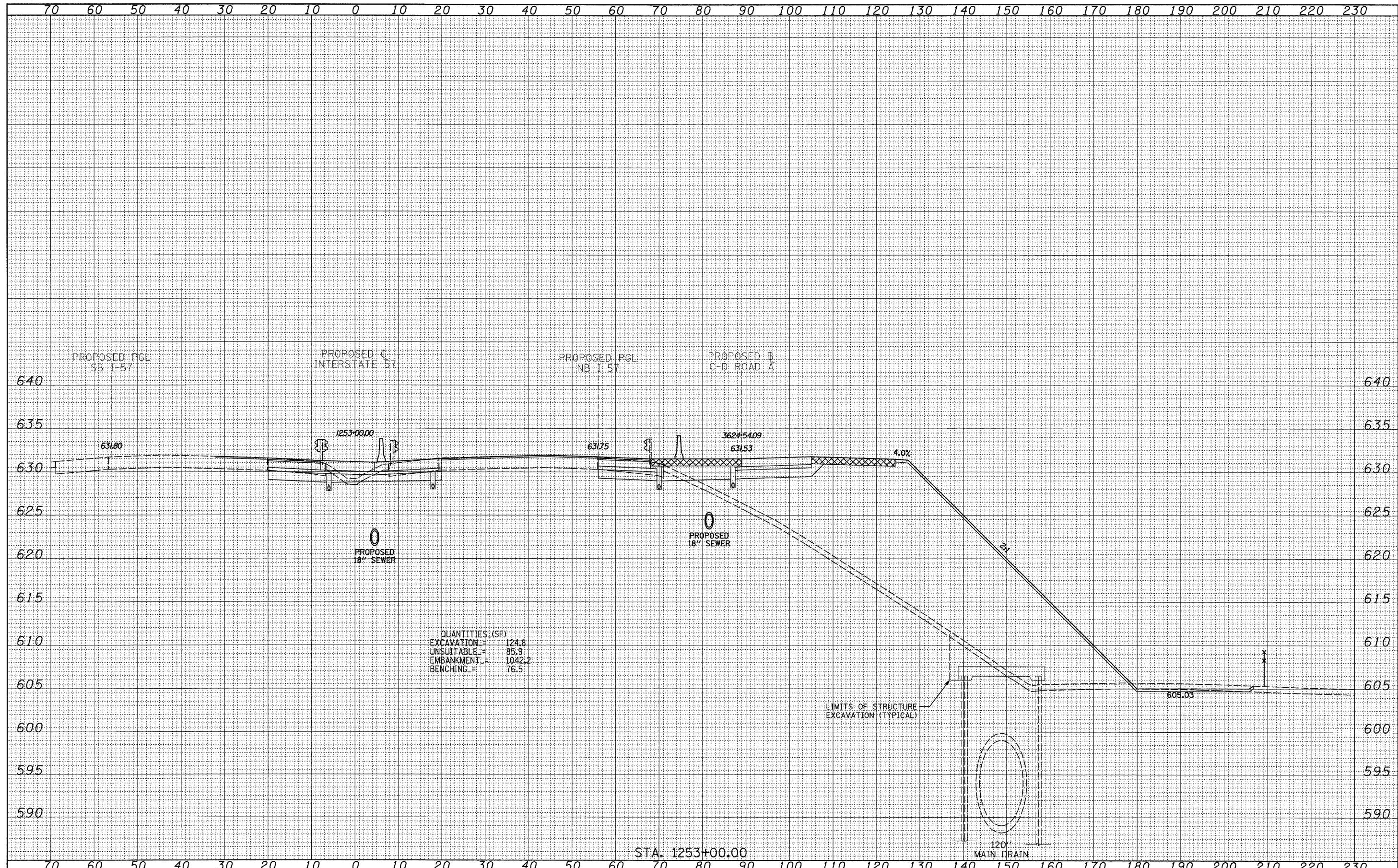

|  |                  |                     |   |  |                 |             |                  |               |
|--|------------------|---------------------|---|--|-----------------|-------------|------------------|---------------|
| <b>TYLIN INTERNATIONAL</b><br>USER NAME =<br>PLOT SCALE =<br>PLOT DATE = | DESIGNED - JDF   | REVISED - 4/29/2010 | <b>STATE OF ILLINOIS</b><br><b>DEPARTMENT OF TRANSPORTATION</b><br><b>I-57 AT I-294 INTERCHANGE PROJECT</b><br><b>PROPOSED I-57 CROSS SECTIONS</b><br>SCALE: 1" = 10' V | F.A.I. RTE. 57   | SECTION 1414.2B | COUNTY COOK | TOTAL SHEETS 516 | SHEET NO. 497 |
|  | DRAWN - JDF      | REVISED -           |   | CONTRACT NO. 60J27                                     |                 |             |                  |               |
|  | CHECKED - JPM    | REVISED -           |   | FED. ROAD DIST. NO. ILLINOIS FED. AID PROJECT          |                 |             |                  |               |
|  | DATE - 3/18/2010 | REVISED -           |   | SHEET NO. OF SHEETS STA. 1253+00.00 TO STA. 1253+00.00 |                 |             |                  |               |

P:\602540(57-294)\Road\PI\_157 BR\PI\_57XS\_SHT\_R.dgn