

FINAL SURVEY	SURVEYED	DATE
NOTE BOOK	PLOTTED	BY
NO.	TEMPLATE	
	AREAS CHECKED	

ORIGINAL SURVEY	SURVEYED	DATE
NOTE BOOK	PLOTTED	BY
NO.	TEMPLATE	
	AREAS CHECKED	

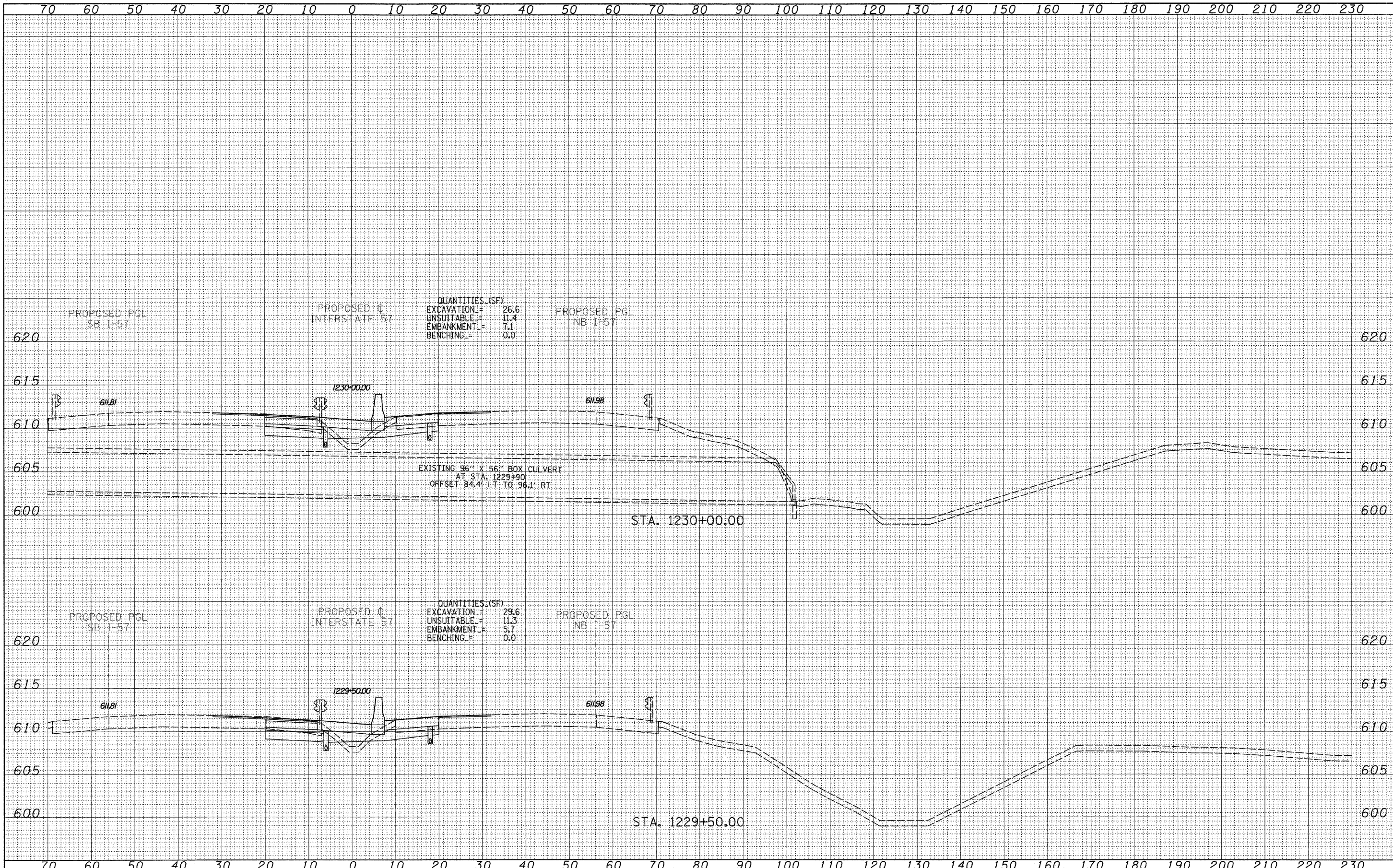

QUANTITIES (SF)

EXCAVATION	=	26.6
UNSUITABLE	=	11.4
EMBANKMENT	=	7.1
BENCHING	=	0.0

QUANTITIES (SF)

EXCAVATION	=	29.6
UNSUITABLE	=	11.3
EMBANKMENT	=	5.7
BENCHING	=	0.0

TYLIN INTERNATIONAL

USER NAME =	DESIGNED - JDF	REVISED -
PLLOT SCALE =	DRAWN - JDF	REVISED -
PLLOT DATE =	CHECKED - JPM	REVISED -
	DATE - 3/18/2010	REVISED -

**STATE OF ILLINOIS
DEPARTMENT OF TRANSPORTATION**

**I-57 AT I-294 INTERCHANGE PROJECT
PROPOSED I-57 CROSS SECTIONS**

SCALE: 1" = 10' H
SHEET NO. OF SHEETS STA. 1229+50.00 TO STA. 1230+00.00

F.A.T. RTE.	SECTION	COUNTY	TOTAL SHEETS	SHEET NO.
57	1414.2B	COOK	516	466
FED. ROAD DIST. NO. ILLINOIS FED. AID PROJECT			CONTRACT NO. 60J27	

P:\602540(57-294)\Road\PI_157 BR\PI_57XS_SHT.dgn