

FINAL SURVEY NO.	DATE
SURVEYED	
PLOTTED	
TEMPLATE	
AREAS CHECKED	

ORIGINAL SURVEY NO.	DATE
SURVEYED	
PLOTTED	
TEMPLATE	
AREAS CHECKED	

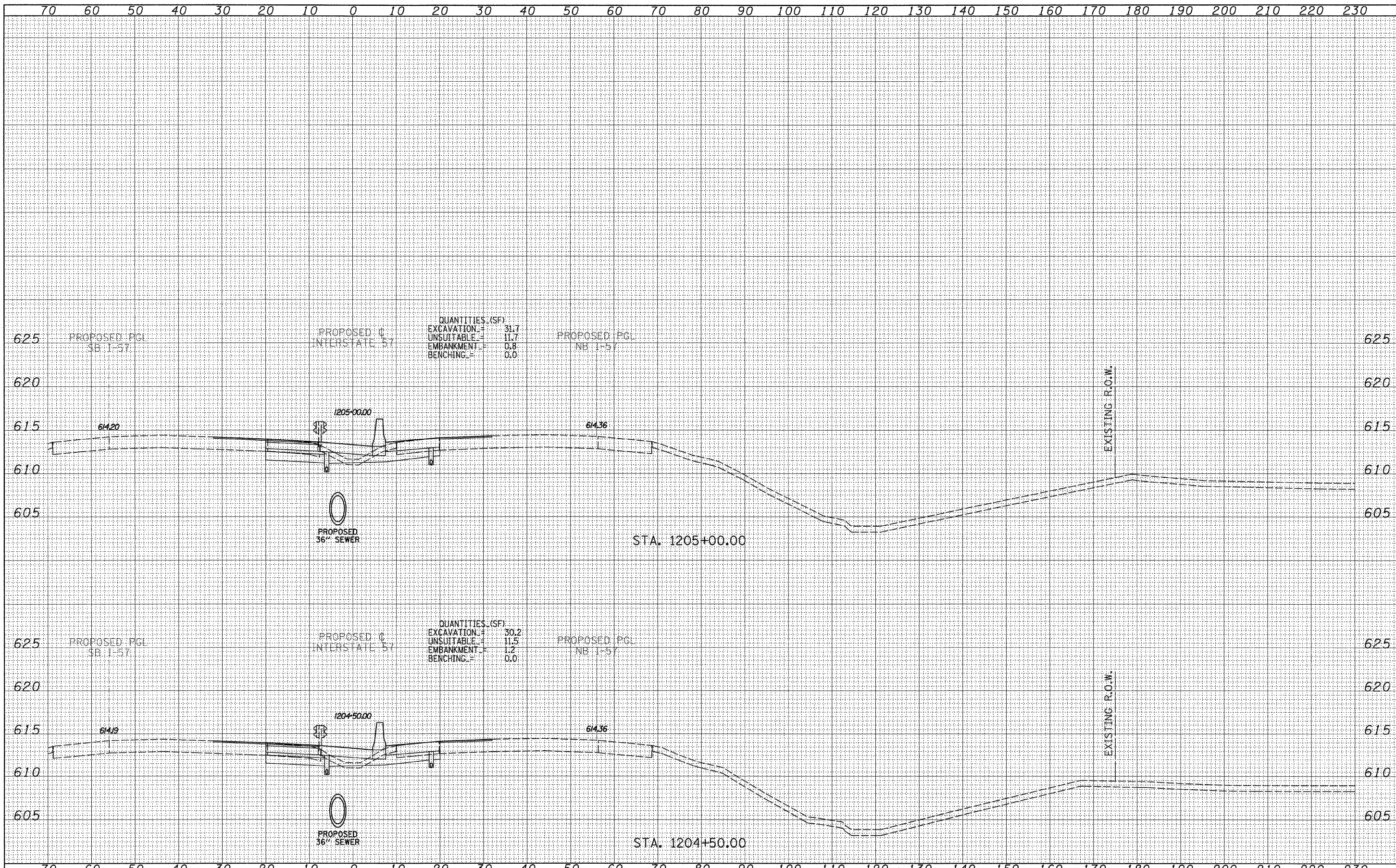

TYLIN INTERNATIONAL USER NAME = PLOT SCALE = PLOT DATE =	DESIGNED - JDF DRAWN - JDF CHECKED - JPM DATE - 3/18/2010	REVISED - REVISED - REVISED - REVISED -	STATE OF ILLINOIS DEPARTMENT OF TRANSPORTATION	I-57 AT I-294 INTERCHANGE PROJECT PROPOSED I-57 CROSS SECTIONS SCALE: 1" = 10' V, 1" = 100' H SHEET NO. OF SHEETS STA. 1204+50.00 TO STA. 1205+00.00	F.A.I. RTE. 57 SECTION 1414.2B COUNTY COOK TOTAL SHEETS 516 SHEET NO. 443 CONTRACT NO. 60J27	FED. ROAD DIST. NO. ILLINOIS FED. AID PROJECT
--	--	--	---	---	---	---

P:\602540\57-294\Road\PI_157 BR\PI_57XS_SHT.dgn