

FINAL SURVEY	DATE
SURVEYED	
PLOTTED	
NOTE BOOK	
AREAS CHECKED	
NO.	

ORIGINAL SURVEY	DATE
SURVEYED	
PLOTTED	
NOTE BOOK	
AREAS CHECKED	
NO.	

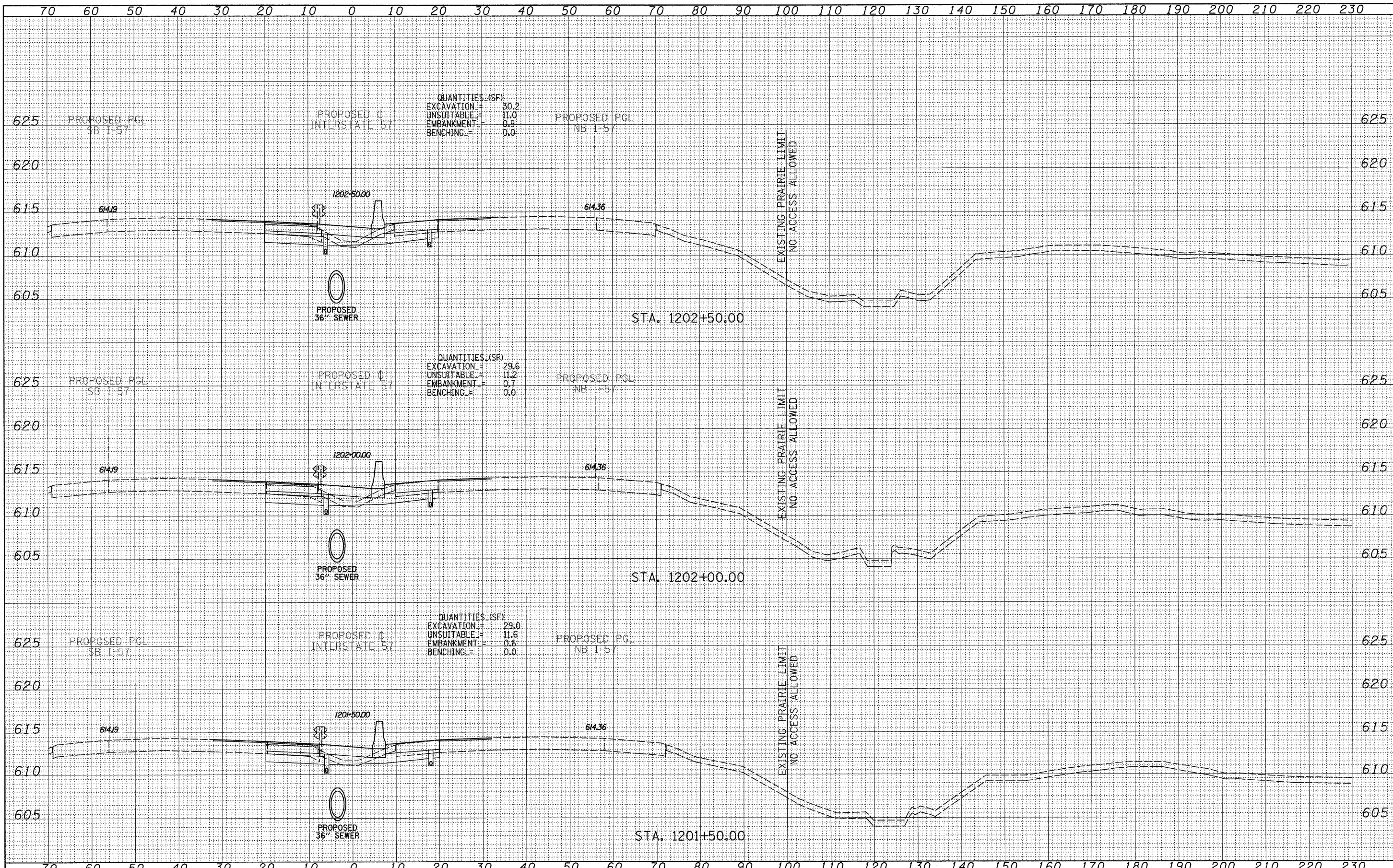

QUANTITIES (SF)
 EXCAVATION = 30.2
 UNSUITABLE = 11.0
 EMBANKMENT = 0.9
 BENCHING = 0.0

QUANTITIES (SF)
 EXCAVATION = 29.6
 UNSUITABLE = 11.2
 EMBANKMENT = 0.7
 BENCHING = 0.0

QUANTITIES (SF)
 EXCAVATION = 29.0
 UNSUITABLE = 11.6
 EMBANKMENT = 0.6
 BENCHING = 0.0

TYLIN INTERNATIONAL

USER NAME =
 PLOT SCALE =
 PLOT DATE =

DESIGNED - JDF
 DRAWN - JDF
 CHECKED - JPM
 DATE - 3/18/2010

REVISED -
 REVISED -
 REVISED -
 REVISED -

STATE OF ILLINOIS
 DEPARTMENT OF TRANSPORTATION

I-57 AT I-294 INTERCHANGE PROJECT
 PROPOSED I-57 CROSS SECTIONS
 SCALE: 1" = 10' V, 1" = 100' H
 SHEET NO. OF SHEETS STA. 1201+50.00 TO STA. 1202+50.00

F.A.I. RTE.	SECTION	COUNTY	TOTAL SHEETS	SHEET NO.
57	1414.2B	COOK	516	441
FED. ROAD DIST. NO. ILLINOIS FED. AID PROJECT			CONTRACT NO. 60J27	