

DATE	
BY	
FINAL SURVEY	
SURVEYED	
PLOTTED	
NOTE BOOK	
TEMPLATE	
AREAS CHECKED	
NO.	

DATE	
BY	
ORIGINAL SURVEY	
SURVEYED	
PLOTTED	
NOTE BOOK	
TEMPLATE	
AREAS CHECKED	
NO.	

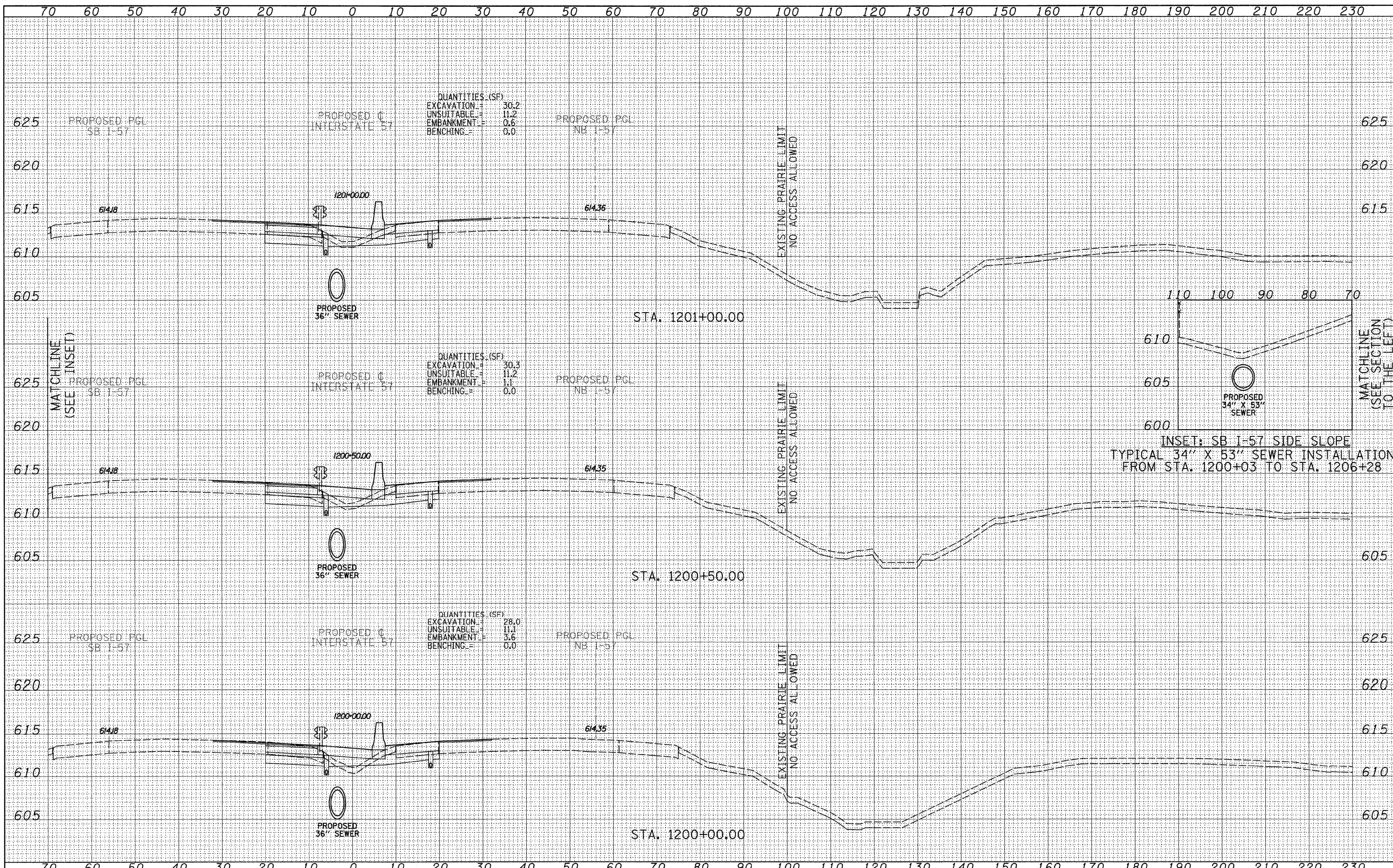

QUANTITIES (SF)

EXCAVATION	=	30.2
UNSUITABLE	=	11.2
EMBANKMENT	=	0.6
BENCHING	=	0.0

QUANTITIES (SF)

EXCAVATION	=	30.3
UNSUITABLE	=	11.2
EMBANKMENT	=	1.1
BENCHING	=	0.0

QUANTITIES (SF)

EXCAVATION	=	28.0
UNSUITABLE	=	11.1
EMBANKMENT	=	3.6
BENCHING	=	0.0

TYLIN INTERNATIONAL

USER NAME =	DESIGNED - JDF	REVISED -
PLLOT SCALE =	DRAWN - JDF	REVISED -
PLLOT DATE =	CHECKED - JPM	REVISED -
	DATE - 3/18/2010	REVISED -

STATE OF ILLINOIS
DEPARTMENT OF TRANSPORTATION

I-57 AT I-294 INTERCHANGE PROJECT			
PROPOSED I-57 CROSS SECTIONS			
SCALE: 1" = 10' V, 1" = 100' H	SHEET NO.	OF SHEETS	STA. 1200+00.00 TO STA. 1201+00.00

F.A.I. RTE. 57	SECTION 1414.2B	COUNTY COOK	TOTAL SHEETS 516	SHEET NO. 440
CONTRACT NO. 60J27			ILLINOIS FED. AID PROJECT	