

STATE OF ILLINOIS  
DEPARTMENT OF TRANSPORTATION

**NORTH EDGE OF SHOULDER - SB I-57**

Location	Station	Offset	Theoretical Grade Elevations
End W. Appr. Pav't	1260+37.80	-12.00	634.88
A	1260+47.80	-12.00	634.84
B	1260+57.80	-12.00	634.79
Begin W. Appr. Pav't	1260+67.80	-12.00	634.73

**P.G.L. - SB I-57**

Location	Station	Offset	Theoretical Grade Elevations
End W. Appr. Pav't	1260+36.36	0.00	635.14
A	1260+46.36	0.00	635.09
B	1260+56.36	0.00	635.04
Begin W. Appr. Pav't	1260+66.36	0.00	634.99

**CROWN - SB I-57**

Location	Station	Offset	Theoretical Grade Elevations
End W. Appr. Pav't	1260+34.93	12.00	635.33
A	1260+44.93	12.00	635.29
B	1260+54.93	12.00	635.24
Begin W. Appr. Pav't	1260+64.93	12.00	635.19

**CROSS SLOPE BREAK - SB I-57**

Location	Station	Offset	Theoretical Grade Elevations
End W. Appr. Pav't	1260+33.50	24.00	635.15
A	1260+43.50	24.00	635.11
B	1260+53.50	24.00	635.06
Begin W. Appr. Pav't	1260+63.50	24.00	635.01

**SOUTH EDGE OF PAVEMENT - SB I-57**

Location	Station	Offset	Theoretical Grade Elevations
End W. Appr. Pav't	1260+30.63	48.00	634.67
A	1260+40.63	48.00	634.62
B	1260+50.63	48.00	634.57
Begin W. Appr. Pav't	1260+60.63	48.00	634.52

**SOUTH EDGE OF SHOULDER - SB I-57**

Location	Station	Offset	Theoretical Grade Elevations
End W. Appr. Pav't	1260+29.13	60.50	634.41
A	1260+39.13	60.50	634.37
B	1260+49.13	60.50	634.32
Begin W. Appr. Pav't	1260+59.13	60.50	634.27

**NORTH EDGE OF SHOULDER - NB I-57**

Location	Station	Offset	Theoretical Grade Elevations
End W. Appr. Pav't	1260+28.78	-48.50	634.57
A	1260+38.78	-48.50	634.52
B	1260+48.78	-48.50	634.47
Begin W. Appr. Pav't	1260+58.78	-48.50	634.42

**NORTH EDGE OF PAVEMENT - NB I-57**

Location	Station	Offset	Theoretical Grade Elevations
End W. Appr. Pav't	1260+27.29	-36.00	634.83
A	1260+37.29	-36.00	634.79
B	1260+47.29	-36.00	634.74
Begin W. Appr. Pav't	1260+57.29	-36.00	634.69

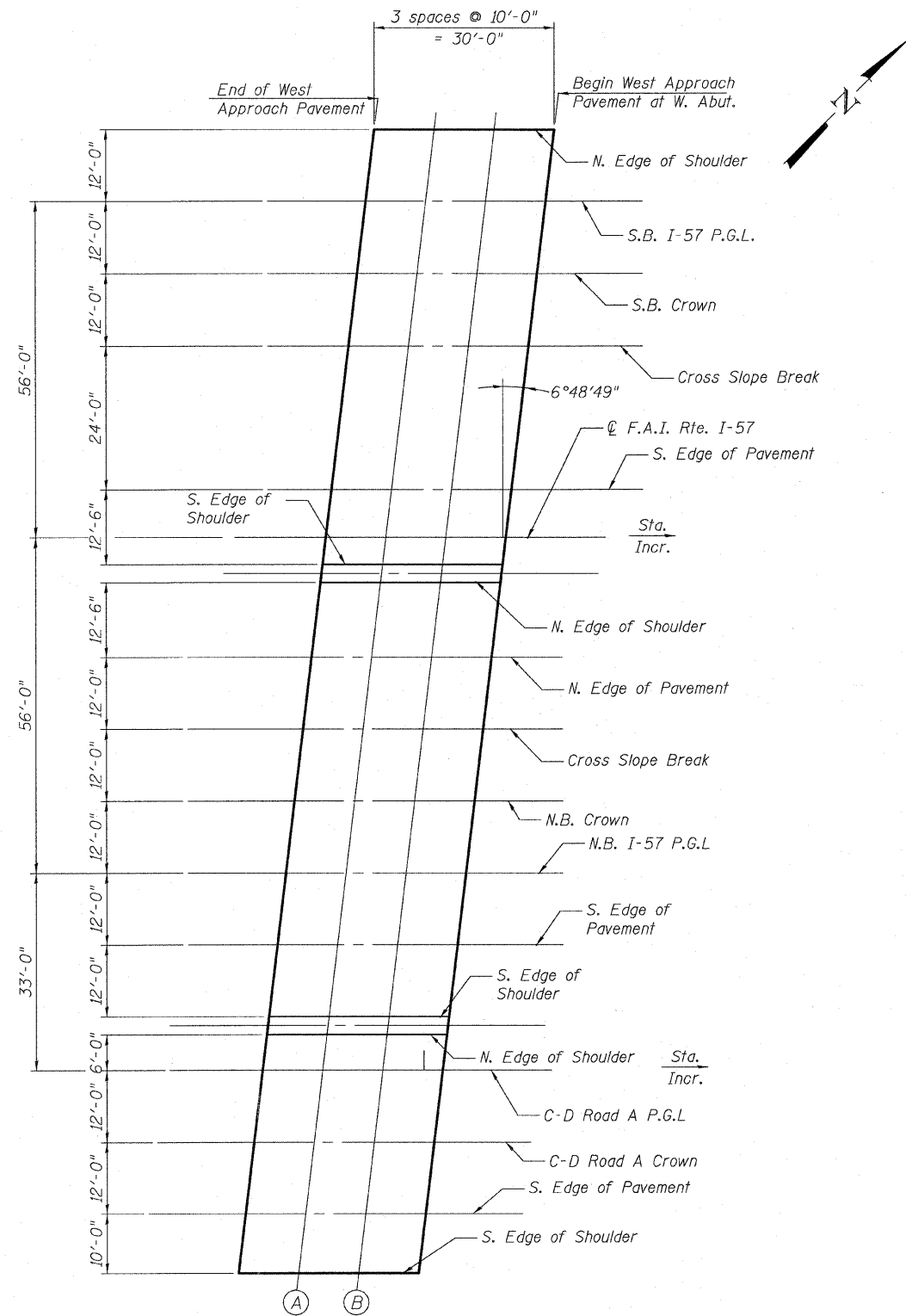

**PLAN**

**TOP OF WEST APPROACH SLAB ELEVATIONS - 1  
SN. 016-1252**

**TYLIN INTERNATIONAL**

DESIGNED -	DY	REVISIONS	
CHECKED -	AD,LS	NAME	DATE
DRAWN -	DY,EI		
CHECKED -	LS,SP,PDF		
DATE -	03/18/10		

SHEET NO. 13 62 SHEETS	F.A.I. RTE. 57	SECTION 1414.2B	COUNTY COOK	TOTAL SHEETS 516	SHEET NO. 326
	CONTRACT NO. 60J27			FED. ROAD DIST. NO. 1 ILLINOIS FED. AID PROJECT	

P:\602540\57-294\STRUCTURAL\I-57 OVER RAMP.BX\Final.submittal\_03-17-2010\Final.submittal\_03172010\0161252-60J27-013-W.TOP\_APPR.ELEV1.dgn 9:53:52 AM 3/18/2010