

STATE OF ILLINOIS
DEPARTMENT OF TRANSPORTATION

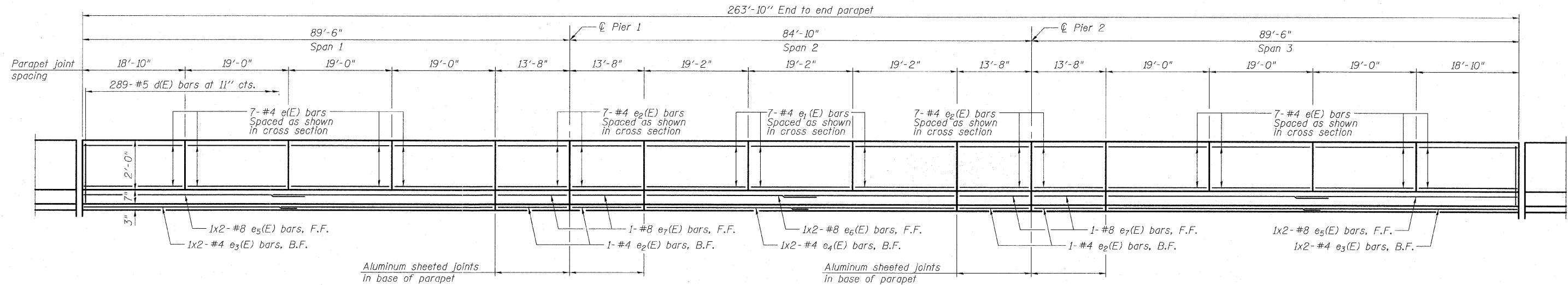

INSIDE ELEVATION OF PARAPET

(Outside parapet S.B. I-57 & inside parapet of C-D Road A shown. Outside parapet of CD Road A opposite hand. Applies to the north parapet of N.B. and S.B. I-57 and each parapet on C-D Road A.)

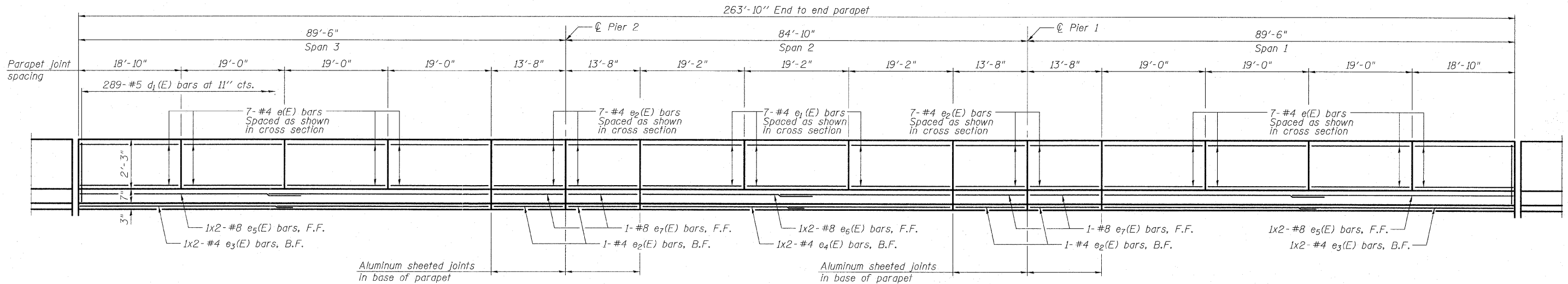

INSIDE ELEVATION OF PARAPET

(Applies to south parapet of N.B. & S.B. I-57 as indicated on Sheets 18 & 19 of 68.)

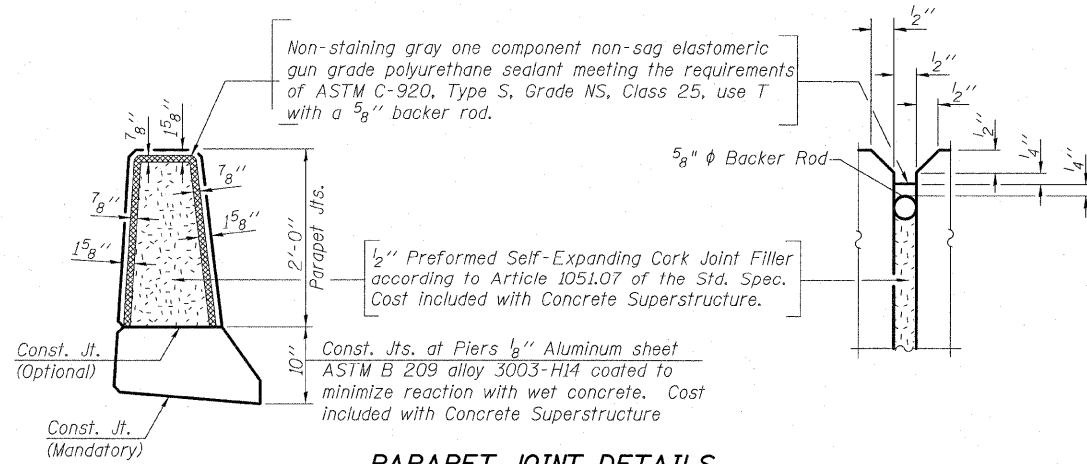

PARAPET JOINT DETAILS

MINIMUM BAR LAP

(Parapet)
#4 bar = 2'-0"
#8 bar = 5'-2"

NOTE

For parapet with embedded conduit, provide expansion/deflection couplings at each deck expansion joint location.

**PARAPET ELEVATIONS
STRUCTURE NO. 016-1251**

TYLIN INTERNATIONAL	DESIGNED - PK	REVISIONS		SHEET NO. 21	F.A.I RTE. 57	SECTION 1414.2B	COUNTY COOK	TOTAL SHEETS 516	SHEET NO. 266
	CHECKED - SP,	NAME	DATE						
	DRAWN - PK								
	CHECKED - SP,PDF								
	DATE - 03/18/10								
				68 SHEETS	CONTRACT NO. 60J27				
				FED. ROAD DIST. NO. 1 ILLINOIS FED. AID PROJECT					

P:\60254067-294\STRUCTURAL\I-57_OVER_1294_0161251-60J27-021-PARAPET1.dgn 3/17/2010 6:57:18 PM