

MATCHLINE STA. 1218+00.00

MATCHLINE STA. 1232+50.00

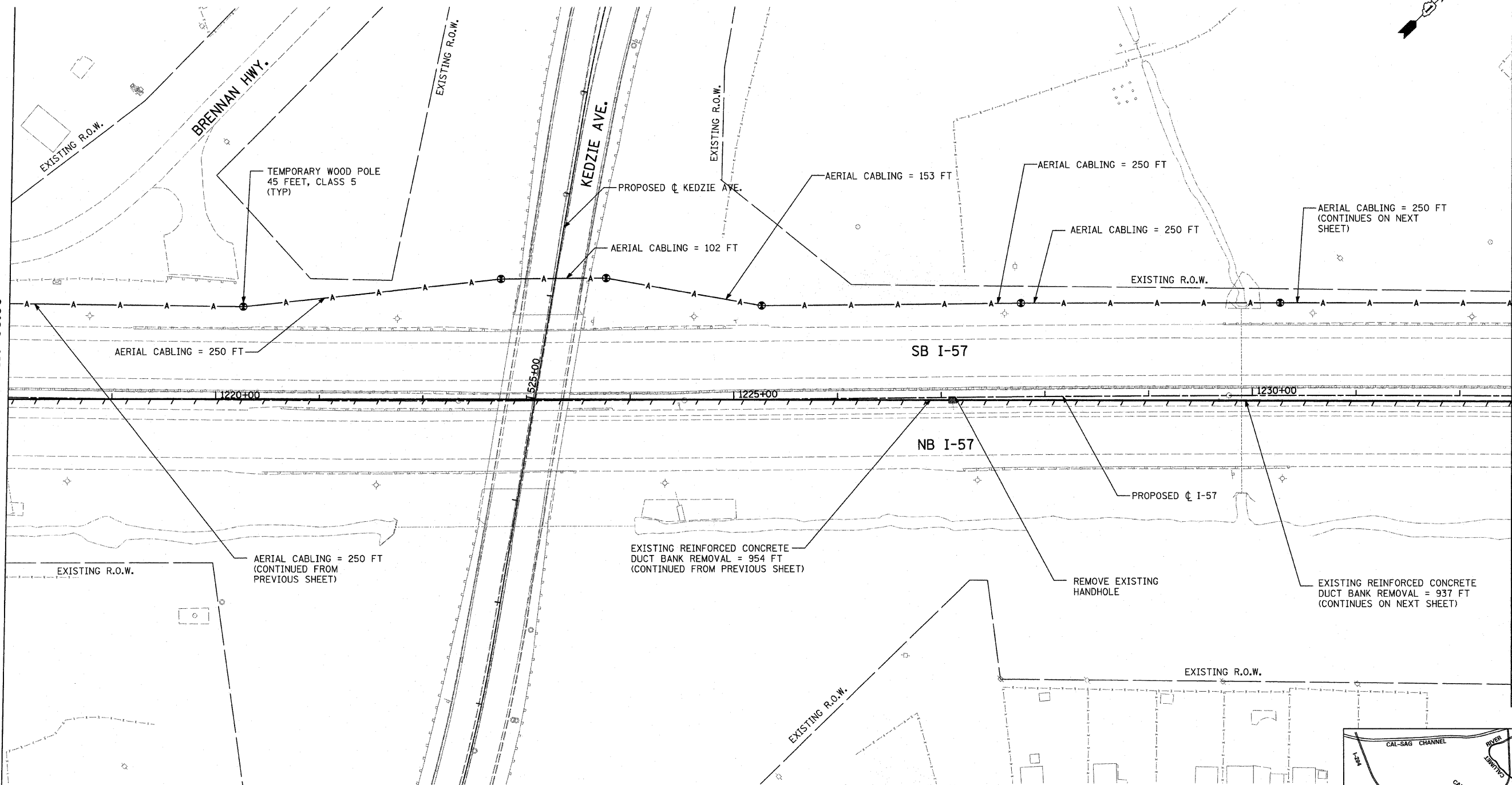

NOTES:

1. SEE WIRING DIAGRAM SHEETS FOR AERIAL CABLING DETAILS ON TEMPORARY WOOD POLES.
2. REMOVAL OF EXISTING CONDUIT SHALL BE INCLUDED IN THE COST OF THE ASSOCIATED REPLACEMENT ITEMS - SEE PROPOSED TRAFFIC SURVEILLANCE PLAN SHEETS

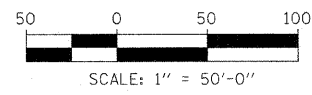
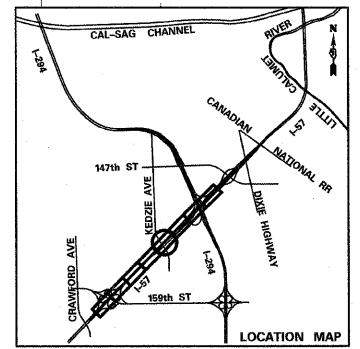

TYLIN INTERNATIONAL	USER NAME =	DESIGNED - JDF	REVISED -	STATE OF ILLINOIS DEPARTMENT OF TRANSPORTATION	I-57 AT I-294 INTERCHANGE PROJECT			F.A.I. RTE. =	SECTION	COUNTY	TOTAL SHEETS	SHEET NO.
	PLOT SCALE =	DRAWN - CAC	REVISED -		57	1414.2B	COOK	516	221			
	PLOT DATE =	CHECKED - DAJ	REVISED -		PROPOSED TEMPORARY TRAFFIC SURVEILLANCE PLAN AND REMOVALS			CONTRACT NO. 60J27				
		DATE - 3/18/2010	REVISED -		SCALE: 1"=50'	SHEET NO. 5 OF 8 SHEETS	STA. 1218+00 TO STA. 1232+50	FED. ROAD DIST. NO.	ILLINOIS FED. AID PROJECT			