

P:\602540(57-294)\road\mot\mot\_project\I-57\_MOT\_W\_SHT03.dgn  
 3/23/2010 9:41:52 AM

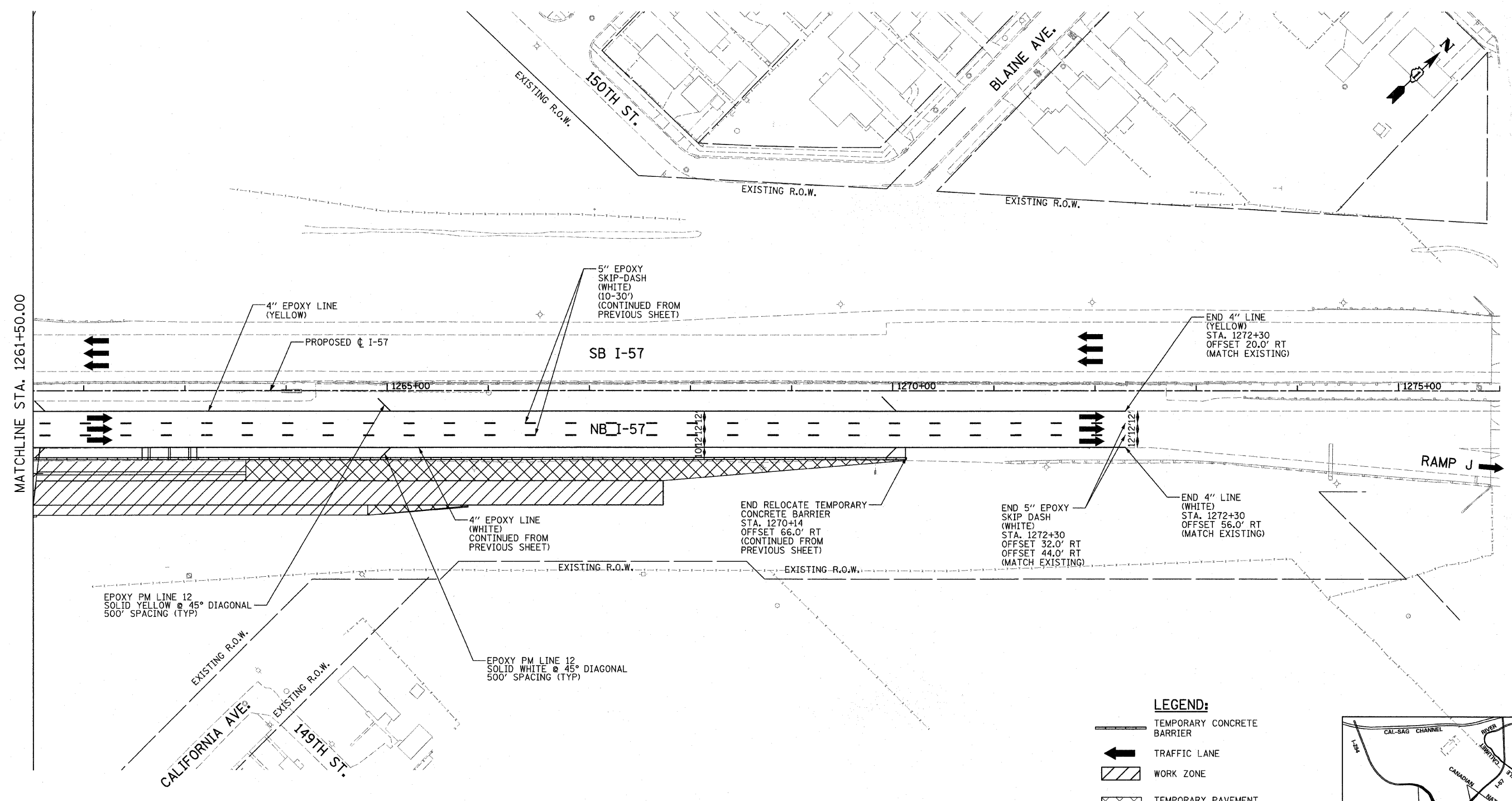

- LEGEND:**
- TEMPORARY CONCRETE BARRIER
  - TRAFFIC LANE
  - WORK ZONE
  - TEMPORARY PAVEMENT (INTERSTATE)
  - BARRICADE, TYPE III
  - DRUM WITH MONO-DIRECTIONAL STEADY BURNING LIGHT
  - ARROW BOARD

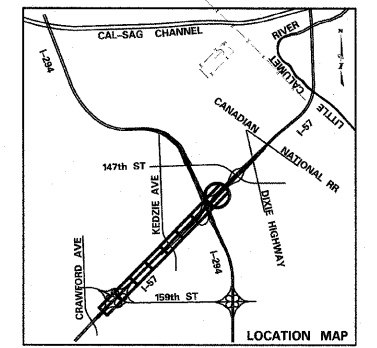
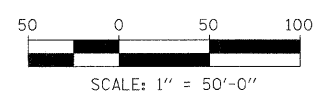

<b>TYLIN INTERNATIONAL</b>	USER NAME =	DESIGNED - DM	REVISED -
	PLOT SCALE =	DRAWN - DM	REVISED -
	PLOT DATE =	CHECKED - JPM	REVISED -
		DATE - 3/18/2010	REVISED -

**STATE OF ILLINOIS**  
**DEPARTMENT OF TRANSPORTATION**

**I-57 AT I-294 INTERCHANGE PROJECT**  
**MAINTENANCE OF TRAFFIC - I-57 WINTER SHUTDOWN I**  
 SCALE: 1"=50' SHEET NO. 3 OF 3 SHEETS STA. 1261+50 TO STA.1276+00

F.A.I. RTE. 57	SECTION 1414.2B	COUNTY COOK	TOTAL SHEETS 516	SHEET NO. 101
FED. ROAD DIST. NO. ILLINOIS			FED. AID PROJECT	
CONTRACT NO. 60J27				