

FOR INDEX OF SHEETS SEE SHEET 2

ROUTE	SECTION	COUNTY	TOTAL SHEETS	SHEET NUMBER
FAU 0297	2009-107 I	WILL	9	1

**STATE OF ILLINOIS  
DEPARTMENT OF TRANSPORTATION  
DIVISION OF HIGHWAYS  
DISTRICT ONE  
PROPOSED HIGHWAY PLANS**

FAU ROUTE 0297: JACKSON ST.  
OVER DES PLAINES RIVER  
SECTION 2009-107 I  
BRIDGE REPAIR: REPLACE PINION RACK  
WILL COUNTY  
C-91-162-10  
SN 099-0239

**CONTRACT NO. 60J06**

D-91-162-10

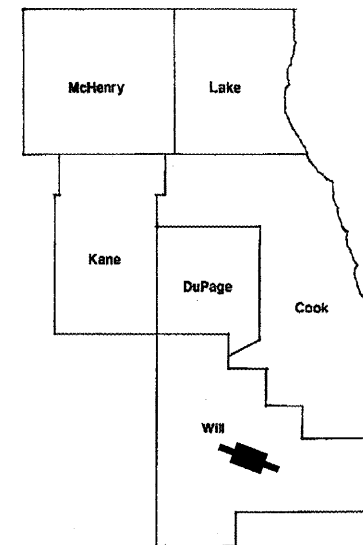

LOCATION OF IMPROVEMENT INDICATED THUS:

**IMPROVEMENT IS LOCATED IN  
THE CITY OF JOLIET**

**LOCATION OF  
IMPROVEMENT  
SN 099-0239**

**TRAFFIC DATA:**

POSTED SPEED LIMIT = 30 MPH  
2008 ADT = 3450

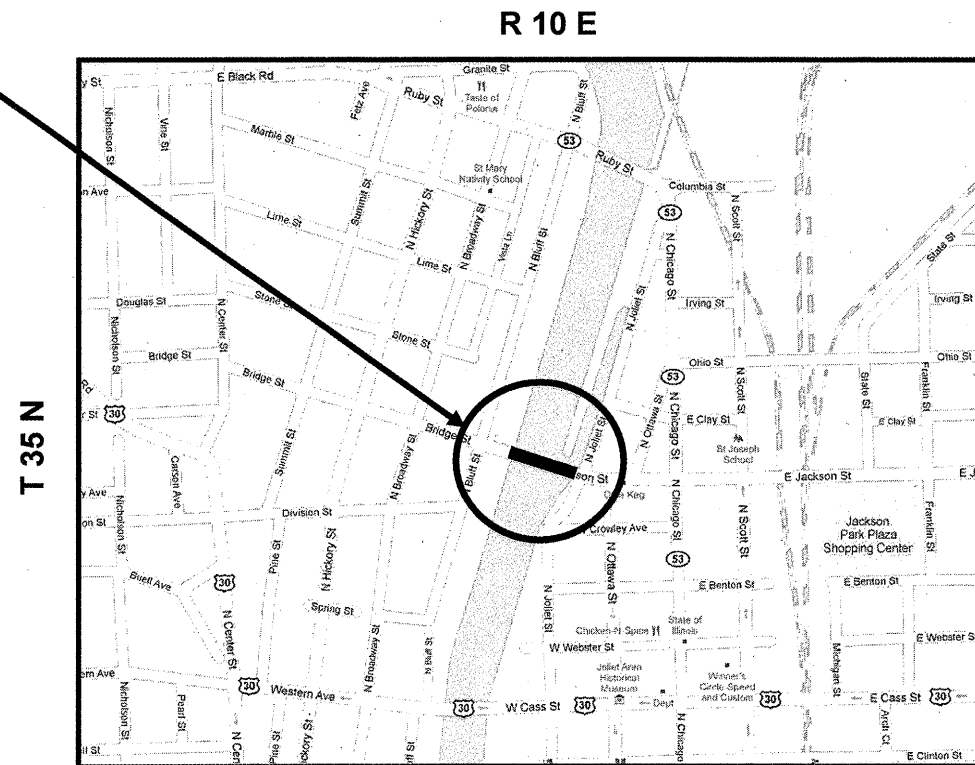

JOLIET TOWNSHIP

**STATE OF ILLINOIS  
DEPARTMENT OF TRANSPORTATION  
DIVISION OF HIGHWAYS**

SUBMITTED: FEBRUARY 11, 2010  
*Diane M. O'Keefe*  
DEPUTY DIRECTOR OF HIGHWAYS, REGION ENGINEER

May 7 2010  
*Scott E. Stitt, P.E.*  
acting ENGINEER OF DESIGN AND ENVIRONMENT

May 7 2010  
*Christina M. Reader*  
DIRECTOR, DIVISION OF HIGHWAYS

**PRINTED BY THE AUTHORITY  
OF THE STATE OF ILLINOIS**

J.U.L.I.E.: JOINT UTILITY LOCATION  
INFORMATION FOR EXCAVATION  
(800) 892-0123 OR 811

**PROJECT ENGINEER    ROBERT BORO (847) 705-4178**  
**PROJECT MANAGER    KEN ENG**

**CONTRACT NO. 60J06**

ROUTE	SECTION	COUNTY	TOTAL SHEETS	SHEET NUMBER
FAU 0297	2009-107 I	WILL	9	2

CONTRACT 60J06

### GENERAL NOTES

BEFORE STARTING ANY EXCAVATION, THE CONTRACTOR SHALL CALL "J.U.L.I.E." AT (800) 892-0123 OR 811 FOR FIELD LOCATIONS OF BURIED ELECTRIC, TELEPHONE AND GAS UTILITIES. 48 HOUR NOTIFICATION IS REQUIRED.

THE CONTRACTOR SHALL COORDINATE CONSTRUCTION ACTIVITIES WITH UTILITY COMPANIES AND THE CITY OF JOLIET.

THE CONTRACTOR WILL NOT BE ALLOWED TO SET UP A YARD OR FIELD OFFICE ON STATE PROPERTY WITHOUT WRITTEN PERMISSION FROM THE DEPARTMENT.

THE CONTRACTOR SHALL CONTACT THE DISTRICT ONE TRAFFIC CONTROL SUPERVISOR AT (847)705-4470 A MINIMUM OF 72 HOURS IN ADVANCE OF BEGINNING WORK.

THE CONTRACTOR SHALL BE REQUIRED TO PROVIDE ACCESS TO ABUTTING PROPERTY AT ALL TIMES DURING THE CONSTRUCTION OF THIS PROJECT.

THE CONTRACTOR SHALL BE RESPONSIBLE FOR THE NOTIFICATION OF ALL EMERGENCY SERVICES, SCHOOL DISTRICTS, I.D.O.T.'S COMMUNICATIONS CENTER, SPRINGFIELD TRUCK PERMIT SECTION AND OTHER AGENCIES AFFECTED BY THE CLOSURE. THE CONTRACTOR SHALL ALSO BE RESPONSIBLE FOR POSTING SIGNS THAT WILL INDICATE THE DATES THE CLOSURE WILL BE IN PLACE.

DO NOT SCALE PLANS FOR CONSTRUCTION DIMENSIONS.

PLAN DIMENSIONS AND DETAILS RELATIVE TO EXISTING PLANS ARE SUBJECT TO NOMINAL CONSTRUCTION VARIATIONS. THE CONTRACTOR SHALL FIELD VERIFY EXISTING DIMENSIONS AND DETAILS AFFECTING NEW CONSTRUCTION AND MAKE NECESSARY APPROVED ADJUSTMENTS PRIOR TO CONSTRUCTION OR ORDERING OF MATERIALS. SUCH VARIATIONS SHALL NOT BE CAUSE FOR ADDITIONAL COMPENSATION FOR A CHANGE IN SCOPE OF THE WORK, HOWEVER, THE CONTRACTOR WILL BE PAID FOR THE QUANTITY ACTUALLY FURNISHED BASED AT THE UNIT PRICE BID FOR THE WORK.

THE CONTRACTOR SHALL FABRICATE TWO (2) RACKS. ONE (1) RACK SHALL BE ERECTED AS SHOWN IN THE PLANS AND ONE (1) RACK SHALL BE STORED AT THE MOVABLE BRIDGE YARD LOCATED AT:

105 BRIDGE ST  
JOLIET, IL 60435

CONTACT HIRAM WHITE AT (815) 726-7495

ILLINOIS DEPARTMENT OF  
TRANSPORTATION  
  
JACKSON ST BRIDGE  
SN 099-0239  
INDEX OF SHEETS, STATE STANDARDS  
GENERAL NOTES

### INDEX OF SHEETS

SHEET NO	DESCRIPTION
1	COVER SHEET
2	INDEX OF SHEETS, STATE STANDARDS GENERAL NOTES
3	SUMMARY OF QUANTITIES
4 - 7	BRIDGE REPAIR PLANS
8	DETOUR PLANS
9	ARTERIAL ROAD INFORMATION SIGN (TC22)

### LIST OF STATE STANDARDS

STANDARD NO	DESCRIPTION
701301-03	LANE CLOSURE, 2L, 2W (SHORT TIME OPERATIONS)
701801-04	URBAN LANE CLOSURE, MULTILANE, 1W OR 2W CROSSWALK OR SIDEWALK CLOSURE
701901-01	TRAFFIC CONTROL DEVICES

ROUTE	SECTION	COUNTY	TOTAL SHEETS	SHEET NUMBER
FAU 0297	2009-107 I	WILL	9	3

CONTRACT NO.: 60J06

SUMMARY OF QUANTITIES		CONSTRUCTION TYPE CODE:		
CODE NO.	ITEMS	UNITS	TOTAL QUANTITIES	URBAN SFTY - 2A 100% STATE
50501140	STRUCTURAL STEEL REPAIR	L SUM	1	1
67100100	MOBILIZATION	L SUM	1	1
70102550	TRAFFIC CONTROL AND PROTECTION FOR TEMPORARY DETOUR	EACH	1	1
70102640	TRAFFIC CONTROL AND PROTECTION, STANDARD 701801	L SUM	1	1
X0320622	FIELD MEASUREMENTS	L SUM	1	1
X0322256	TEMPORARY INFORMATION SIGNING	SQ FT	51.4	51.4

ILLINOIS DEPARTMENT OF TRANSPORTATION  
 JACKSON ST BRIDGE  
 SN 099-0239  
 SUMMARY OF QUANTITIES

ROUTE	SECTION	COUNTY	TOTAL SHEETS	SHEET NUMBER
FAU 0297	2009-1071	WILL	9	4

CONTRACT 60J06

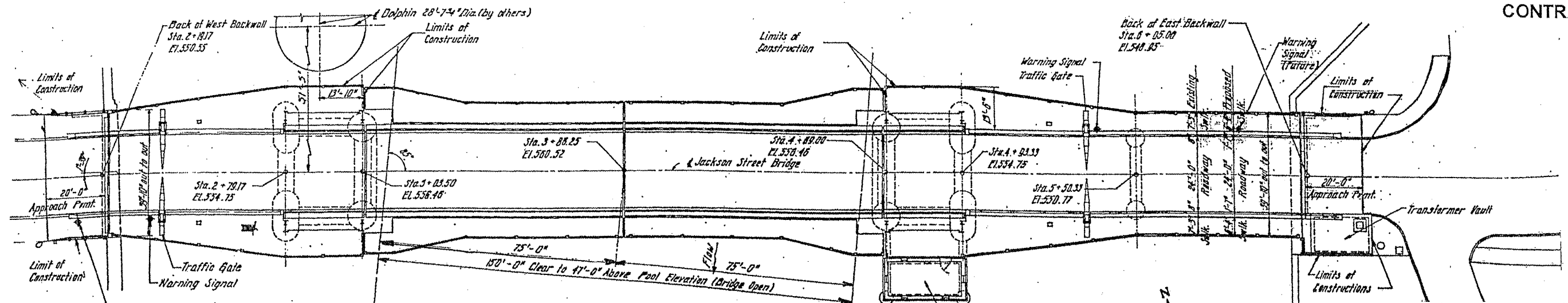

PLAN

**SEQUENCE OF CONSTRUCTION**

1. SET UP DETOUR.
2. RAISE BRIDGE TO FULL OPEN POSITION.
3. REMOVE EXISTING FILLET WELDS FROM RACK BY AIR-ARC GOUGING. CARE SHALL BE TAKEN NOT TO DAMAGE EXISTING RACK SUPPORT.
4. GRIND RACK SUPPORT SMOOTH AFTER ARC-GOUGING TO REMOVE SPATTERS, DEBRIS OR HIGH SPOTS. RACK SUPPORT SURFACE SHALL HAVE A ROUGHNESS AVERAGE (Ra) OF 250 μin OR LESS. GRINDING EQUIPMENT SHALL BE APPROVED BY THE ENGINEER THE GRINDING OPERATION SHALL NOT GOUGE THE RACK SUPPORT.
5. UNBOLT AND REMOVE EXISTING RACK.
6. REPLACE NEW RACK.

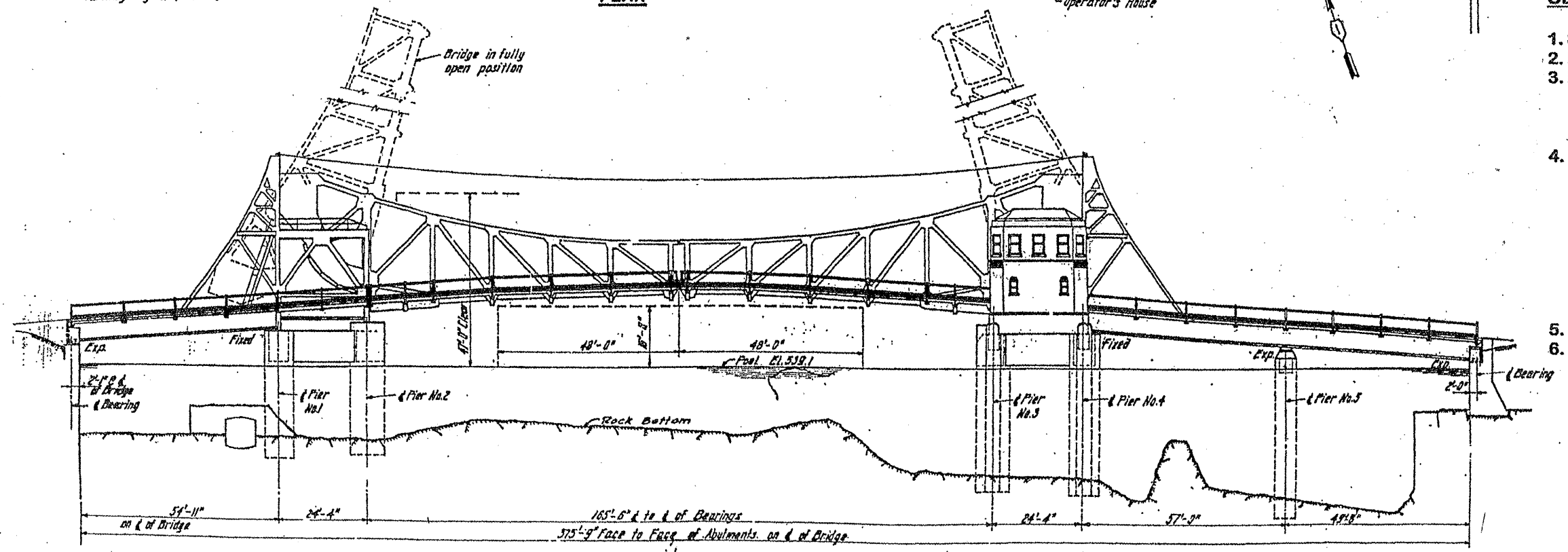

ELEVATION

ILLINOIS DEPARTMENT OF  
TRANSPORTATION

JACKSON ST. BRIDGE  
OVER DES PLAINS RIVER  
GENERAL PLAN AND ELEVATION  
S.N. 099-0239

ROUTE	SECTION	COUNTY	TOTAL SHEETS	SHEET NUMBER
FAU 0297	2009-107 I	WILL	9	5

CONTRACT 60J06

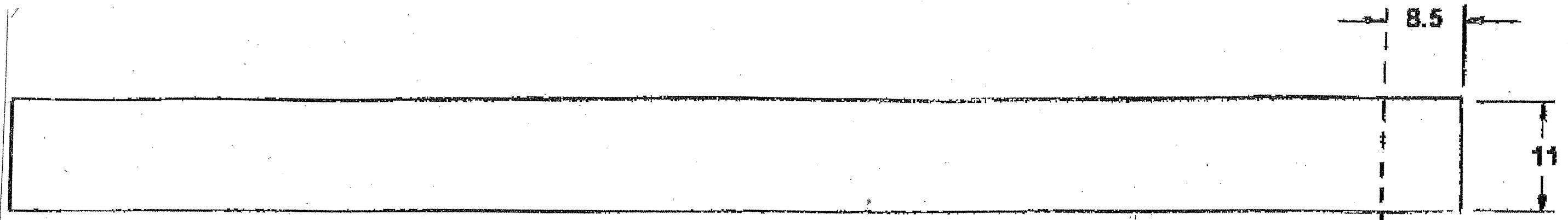

PLAN

CUT  
LINE

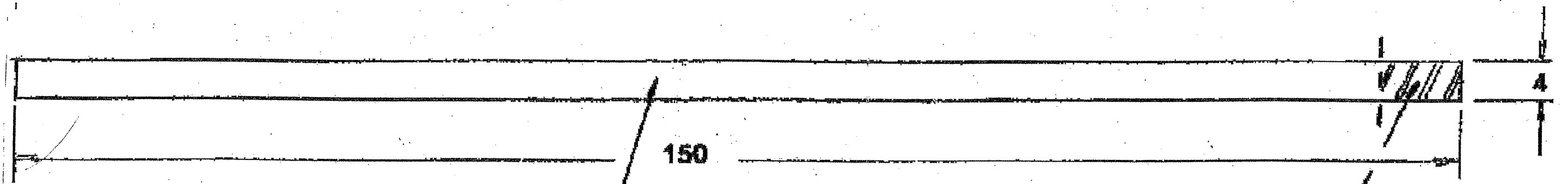

ELEVATION

Test Section for  
Mechanical Properties

**RACK PLATE STARTING MATERIAL**  
*(Including Test Section)*

**AISI 620 Annealed Plate or  
ASTM A572 Grade 50 Plate**  
Tensile Strength 65 ksi min  
Yield Strength 50 ksi min  
21% Elongation min  
CVN Impact Toughness, 30 ft-lbs at 40°F

**Starting Plate Material for Rack**  
All dimensions in inches except for  
surface roughness in microinches

ILLINOIS DEPARTMENT OF  
TRANSPORTATION

JACKSON ST. BRIDGE  
OVER DES PLAINS RIVER  
STARTING PLATE MATERIAL FOR RACK  
S.N. 099-0239

ROUTE	SECTION	COUNTY	TOTAL SHEETS	SHEET NUMBER
FAU 0297	2009-107 I	WILL	9	6

CONTRACT 60J06

Drill through 7/8" dia holes and counterbore 1 1/32 dia x 0.875 deep.  
Align rack with existing rack support holes, redrilling or reaming to 7/8".  
Insert 7/8"—9UNC x 3" long ASTM A574 socket head cap screws.  
Torque requirements to be determined by the Engineer.

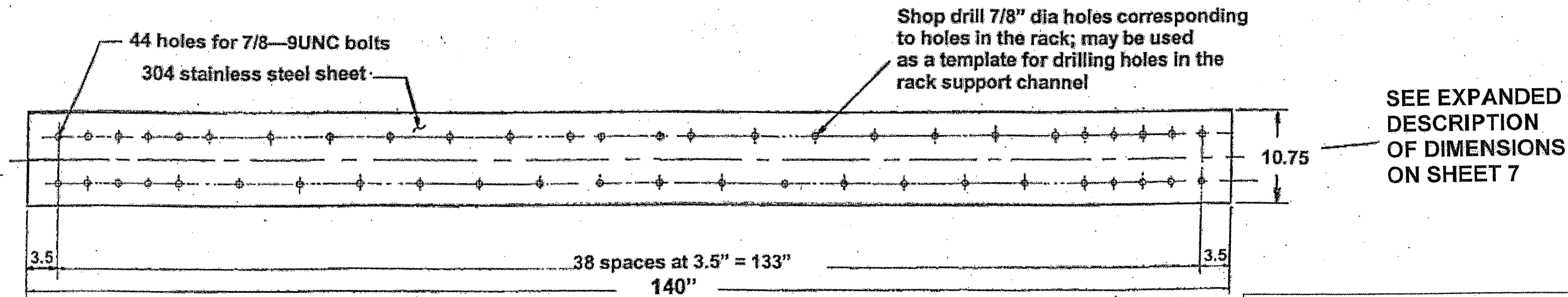
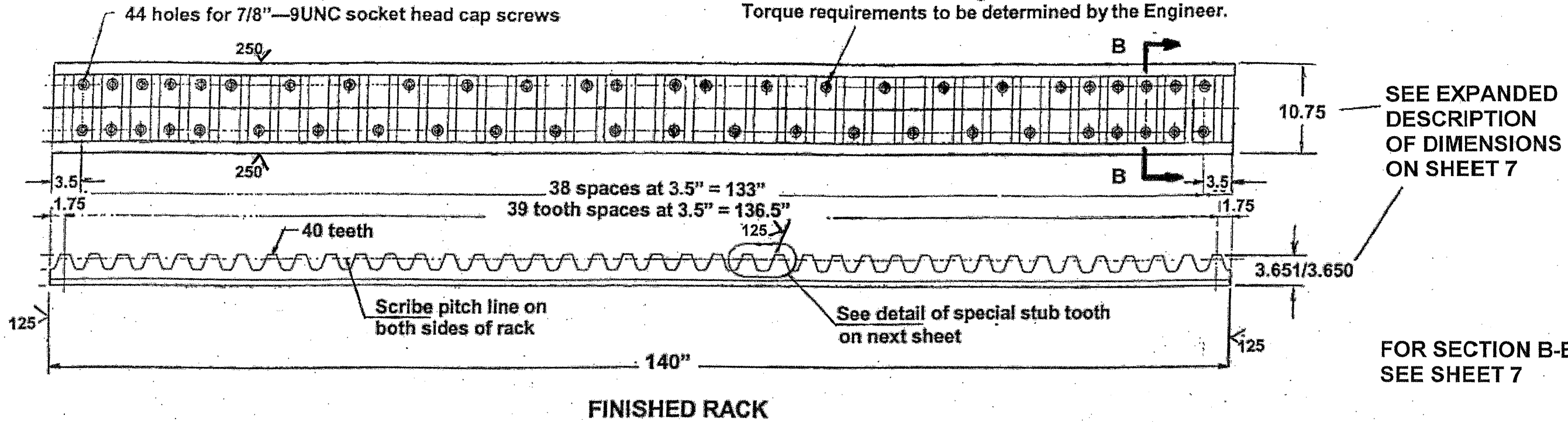

All dimensions in inches except for surface roughness in microinches

**RACK SHIM**  
Thickness to be determined by field measurements as required

ILLINOIS DEPARTMENT OF TRANSPORTATION

JACKSON ST. BRIDGE  
OVER DES PLAINS RIVER  
OVERALL RACK LAYOUT  
S.N. 099-0239

ROUTE	SECTION	COUNTY	TOTAL SHEETS	SHEET NUMBER
FAU 0297	2009-107 I	WILL	9	7

CONTRACT 60J06

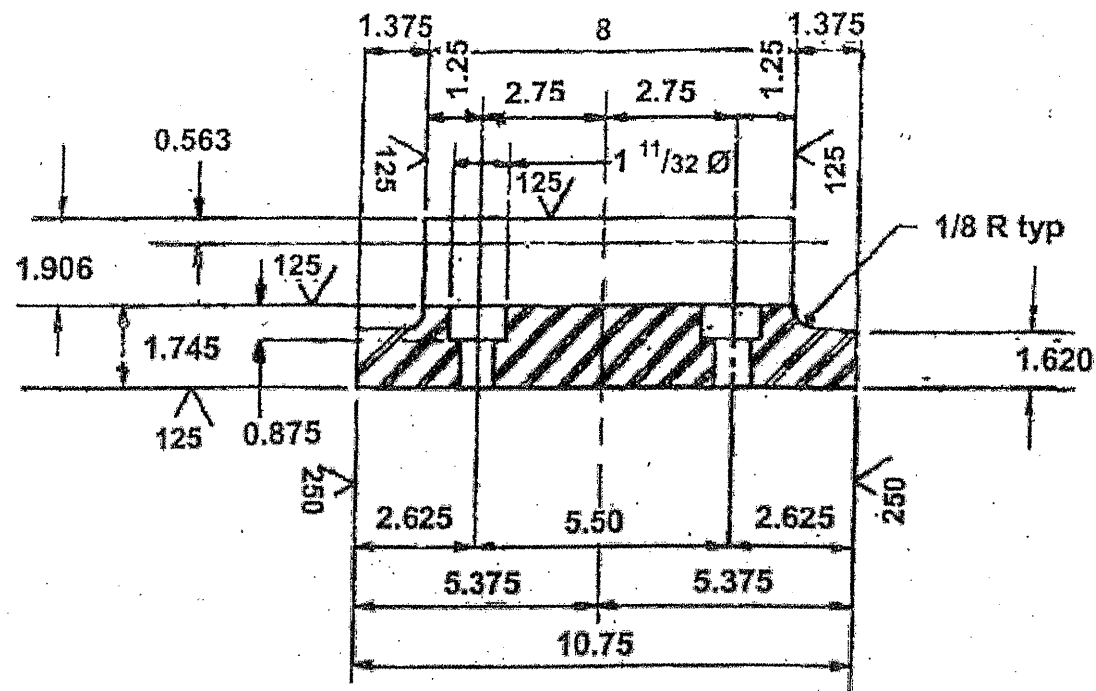

SECTION B - B

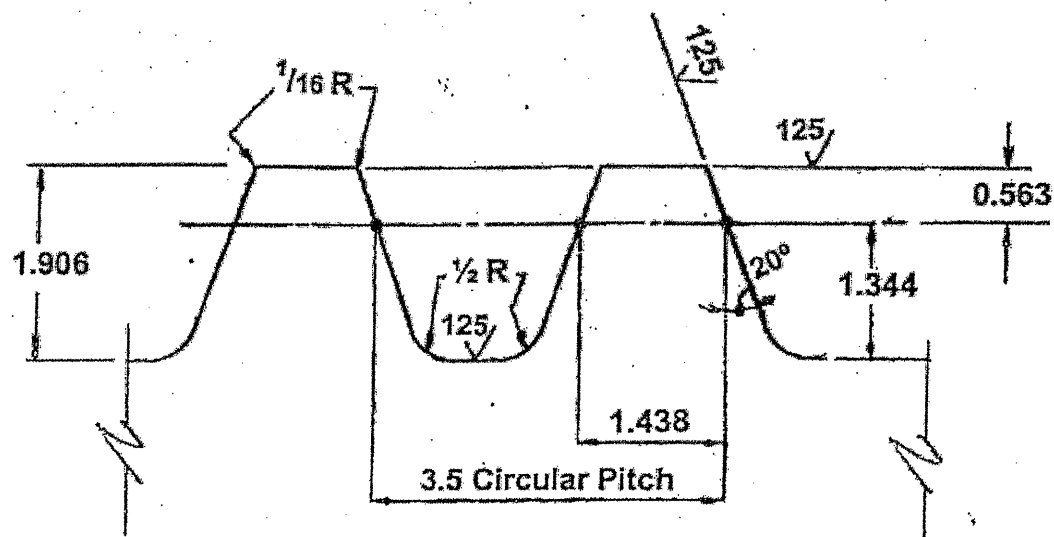

DETAIL OF SPECIAL STUB TOOTH

All dimensions in inches except for surface roughness in microinches

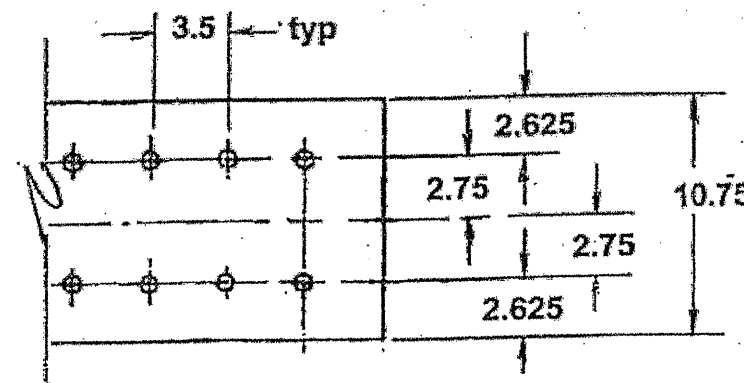
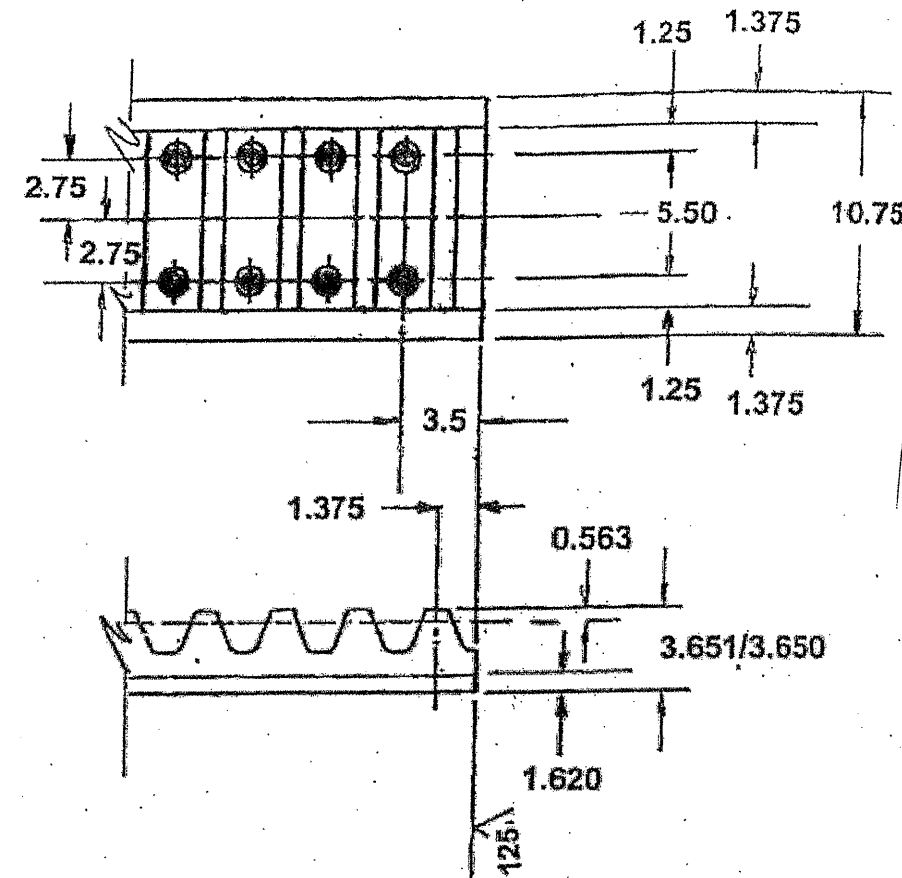

ILLINOIS DEPARTMENT OF  
TRANSPORTATION

JACKSON ST. BRIDGE  
OVER DES PLAINS RIVER  
RACK DETAILS  
S.N. 099-0239



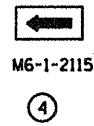
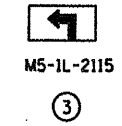
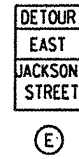

DETOUR M4-8-2412

EAST M3-2-2412

WEST M3-4-2412

JACKSON STREET 24" x 18" 4" BLACK ON WHITE MI-50-2424

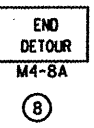
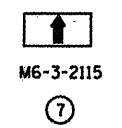
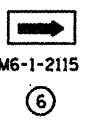
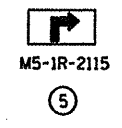

MOUNTED ABOVE TYPE III BARRICADE \*

**SYMBOLS**

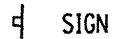

TWO (2) OR MORE TYPE III BARRICADES W/2 STEADY BURN LIGHTS

\* IF A TYPE III BARRICADE WITH AN ATTACHED SIGN PANEL WHICH MEETS NCHRP 350 REQUIREMENTS IS NOT AVAILABLE, THE SIGNS SHALL BE MOUNTED, ABOVE THE BARRICADES, OR SEPARATE SIGNS SUPPORTS THAT MEET NCHRP 350 REQUIREMENTS.

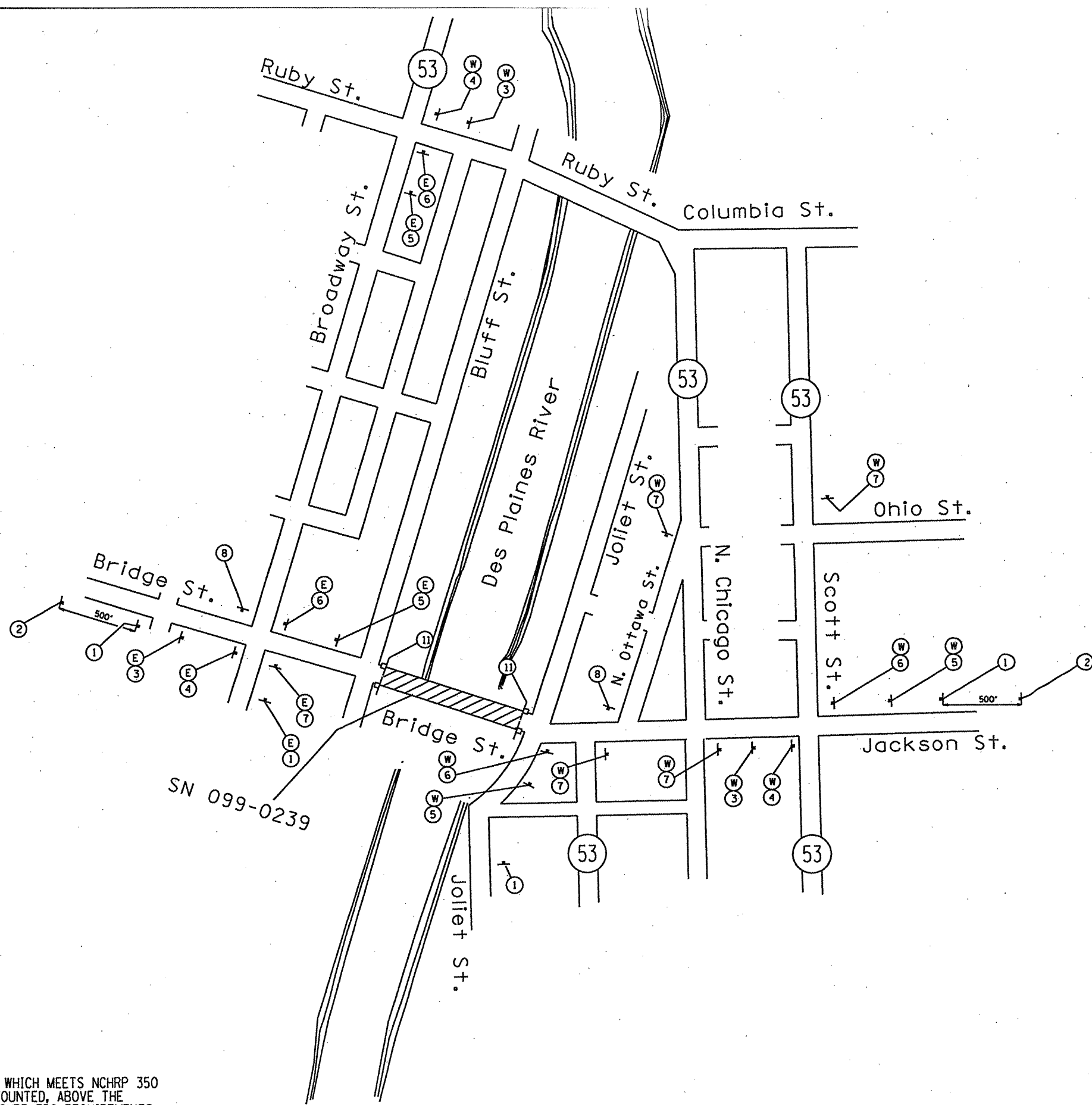

FILE NAME =	USER NAME = tmskosmv	DESIGNED -	REVISED -
ca:\pwwork\pwwd01\TINIAKOSMV\d0101671\09-0171.dgn		DRAWN -	REVISED -
PLOT SCALE = 100.0000' / IN.		CHECKED -	REVISED -
PLOT DATE = 1/27/2010		DATE -	REVISED -

**STATE OF ILLINOIS  
DEPARTMENT OF TRANSPORTATION**

**JACKSON ST. BRIDGE OVER DES PLAINES RIVER  
DETOUR PLAN**

SCALE: SHEET NO. 8 OF SHEETS STA. TO STA.

F.A.U. RTE.	SECTION	COUNTY	TOTAL SHEETS	SHEET NO.
0297	2009-107 I	WILL	9	8
CONTRACT NO. 60J06			ILLINOIS FED. AID PROJECT	



F.A. RTE.	SECTION	COUNTY	TOTAL SHEETS	SHEET NO.
		Will	9	9
STA.		TO STA.		
FED. ROAD DIST. NO.	ILLINOIS	FED. AID PROJECT		

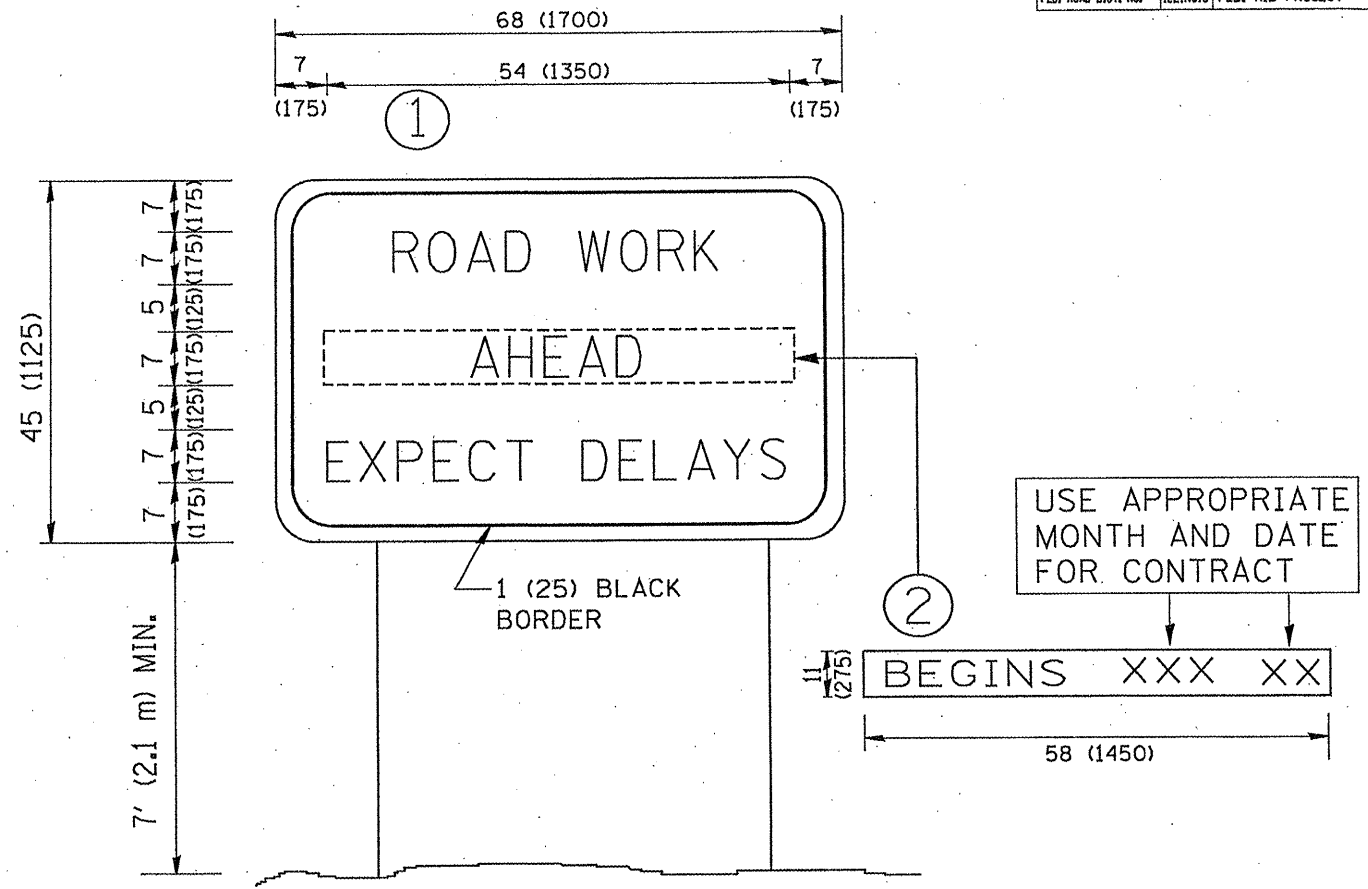

**NOTES:**

1. USE BLACK LETTERING ON ORANGE BACKGROUND.
2. ERECT SIGNS IN ADVANCE OF THE LOCATION FOR THE "ROAD CONSTRUCTION AHEAD" SIGN AT LOCATIONS AS DIRECTED BY THE ENGINEER.
3. ERECT SIGN ① WITH INSTALLED PANEL ② ONE WEEK PRIOR TO THE START OF CONSTRUCTION.
4. REMOVE PANEL ② SOON AFTER THE START OF CONSTRUCTION.
5. SEE SPECIAL PROVISION FOR "TEMPORARY INFORMATION SIGNING" FOR ADDITIONAL INFORMATION.
6. ONE SIGN ASSEMBLY EQUALS 25.70 SQ. FT. (2.3 SQ. M.)
7. SHALL BE PAID FOR AS TEMPORARY INFORMATION SIGNING.

ALL DIMENSIONS ARE IN INCHES (MILLIMETERS) UNLESS OTHERWISE SHOWN.

REVISIONS	
NAME	DATE
R. MIRS	9-16-97
R. MIRS	12-11-97
T. RAMMACHER	2-2-99
C. JUCIUS	1-31-07

ILLINOIS DEPARTMENT OF TRANSPORTATION  
 ARTERIAL ROAD  
 INFORMATION SIGN

SCALE: NONE

DRAWN BY DESIGN  
 CHECKED BY  
 TC22