

F.A.I. RTE.	SECTION	COUNTY	TOTAL SHEETS	SHEET NO.
94		COOK	916	916
STA. 190+65 (NB I-57) TO STA. 2316+00 (NB RYAN)				
FED. ROAD DIST. NO. ILLINOIS FED. AID PROJECT				
* (516.1, 1717, & 1818) R-4				
				62304

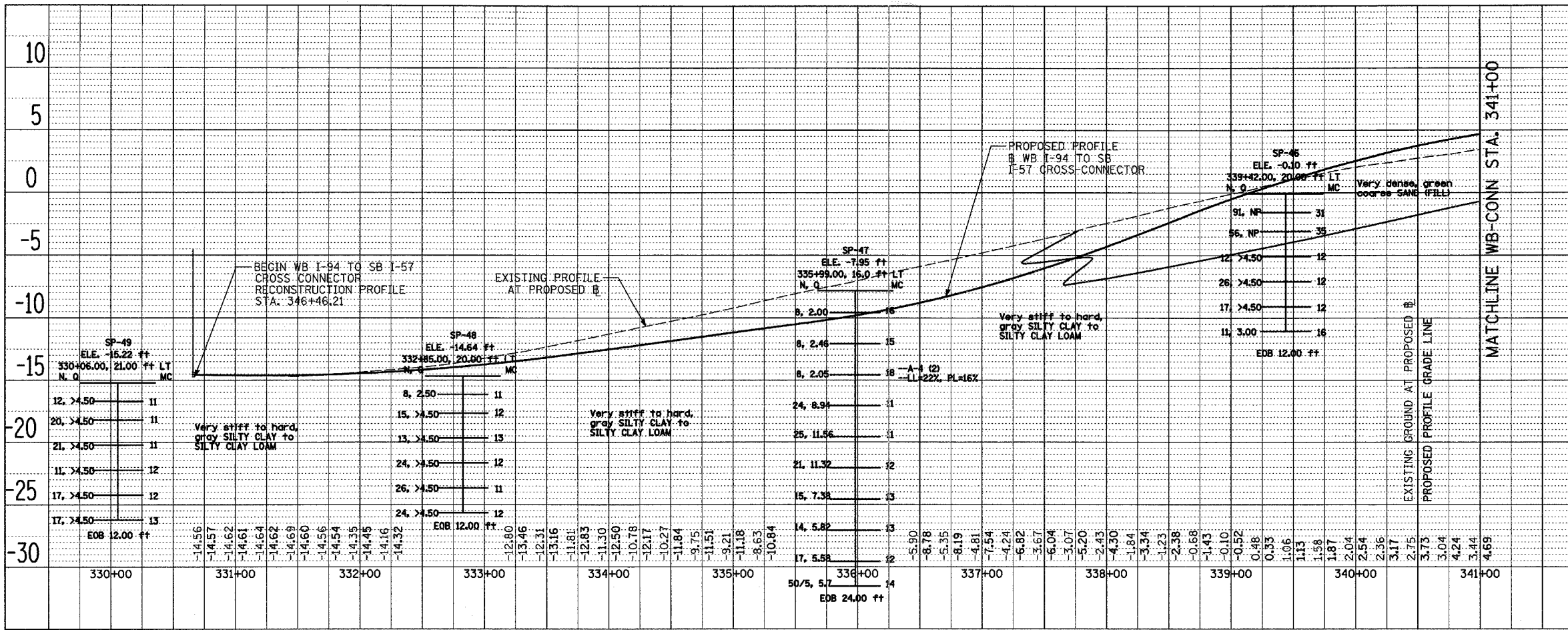

WB I-94 TO SB I-57 (WB) CROSS-CONNECTOR

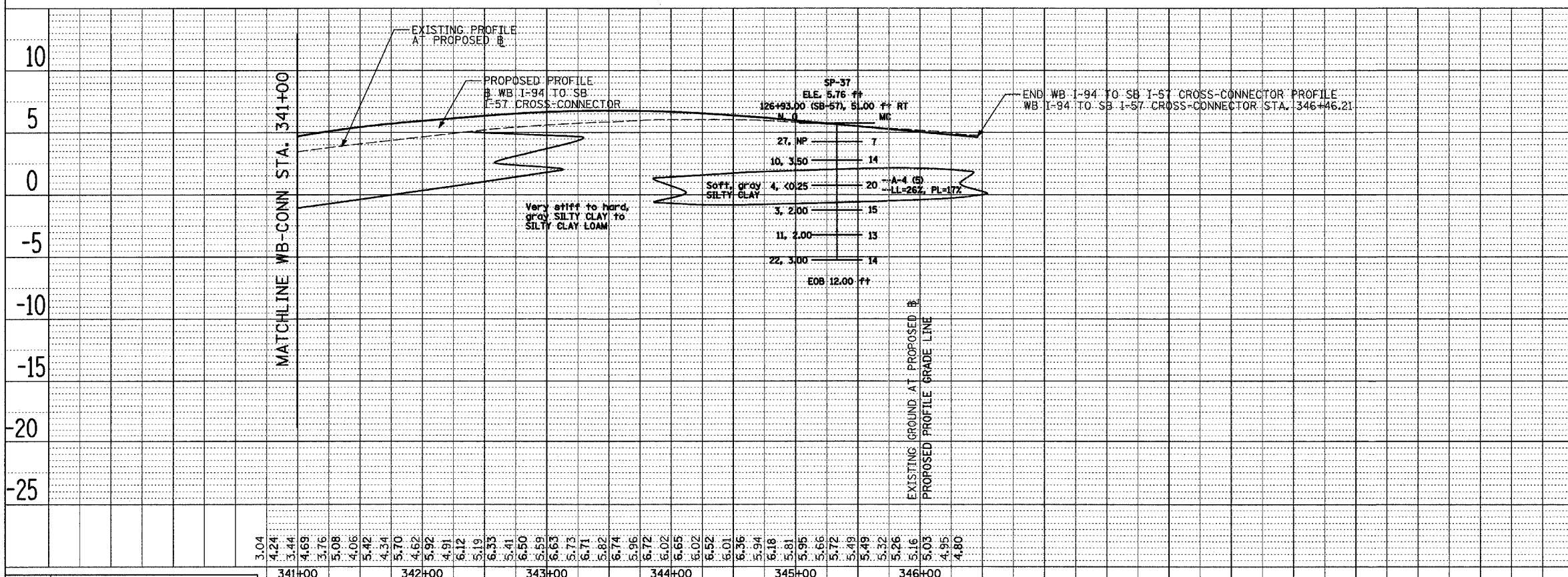

WB I-94 TO SB I-57 (WB) CROSS-CONNECTOR

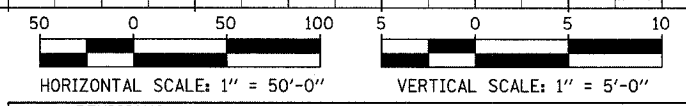

REVISIONS	
NAME	DATE

ILLINOIS DEPARTMENT OF TRANSPORTATION
F.A.I. 94 (DAN RYAN EXPRESSWAY)
SOIL BORING PROFILES
WB CROSS-CONNECTOR (WB I-94 TO SB I-57)
SHEET 1 OF 1 - STA. 330+65.46 TO 346+46.21

SCALE: 1"=50' HORIZ.
1"=5' VERT.
DATE: MARCH 7, 2006
DRAWN BY: WW
CHECKED BY: MLS

DATE	
BY	
PLAN	
SURVEYED	
PLOTTED	
ALIGNED	
CHECKED	
NOTE BOOK	
NO.	
CADD FILE NAME	

DATE	
BY	
PLAN	
SURVEYED	
PLOTTED	
ALIGNED	
CHECKED	
NOTE BOOK	
NO.	
CADD FILE NAME	