

PROFILE SURVEYED _____ DATE _____
 BT _____
 NOTE BOOK _____
 GRADES CHECKED _____
 BAL. NO. _____
 PILING DATE NOTATION: CPND

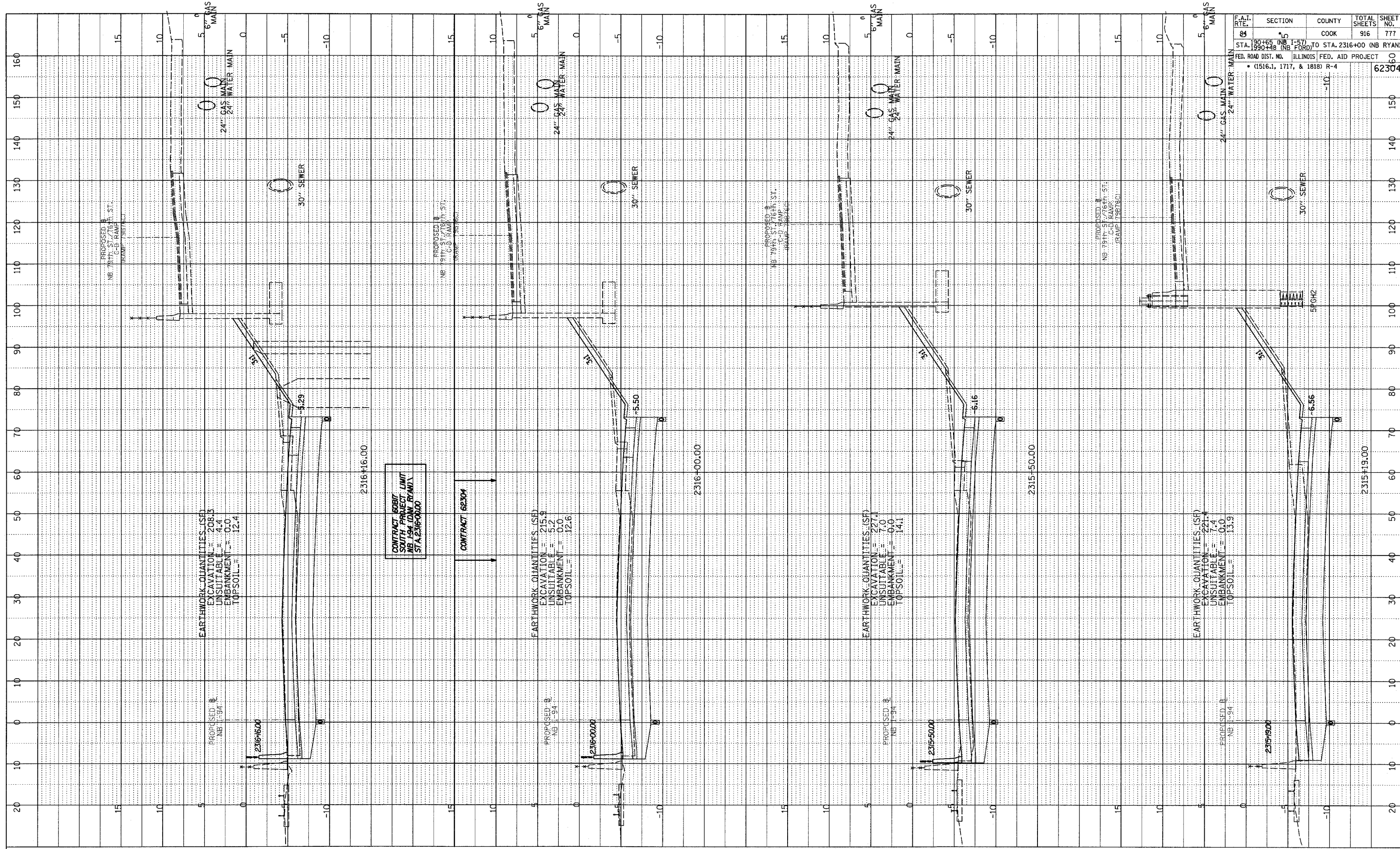

| F.A.I. RTE. | SECTION | COUNTY | TOTAL SHEETS | SHEET NO. |
|-------------|---------|--------|--------------|-----------|
| 84 | 15 | COOK | 916 | 777 |

STA. 190+45 (NB I-57) TO STA. 2316+00 (NB RYAN)
 STA. 190+48 (NB I-57) TO STA. 2316+00 (NB RYAN)
 FED. ROAD DIST. NO. ILLINOIS FED. AID PROJECT
 • (1516.1, 1717, & 1818) R-4

TYLIN INTERNATIONAL

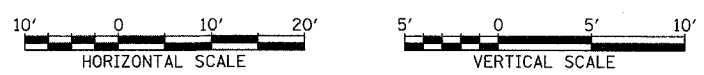

NORTHBOUND I-94 (DAN RYAN EXPWY)
 STA. 2315+19 TO STA. 2316+16

03/03/2006 04:04 PM