

PROFILE SURVEYED
 GRADES CHECKED
 DATE: _____
 BY: _____
 NOTE BOOK NO. _____
 DATE: _____
 SURVEYOR'S NAME AND FIRM: _____
 PROJECT TITLE: _____

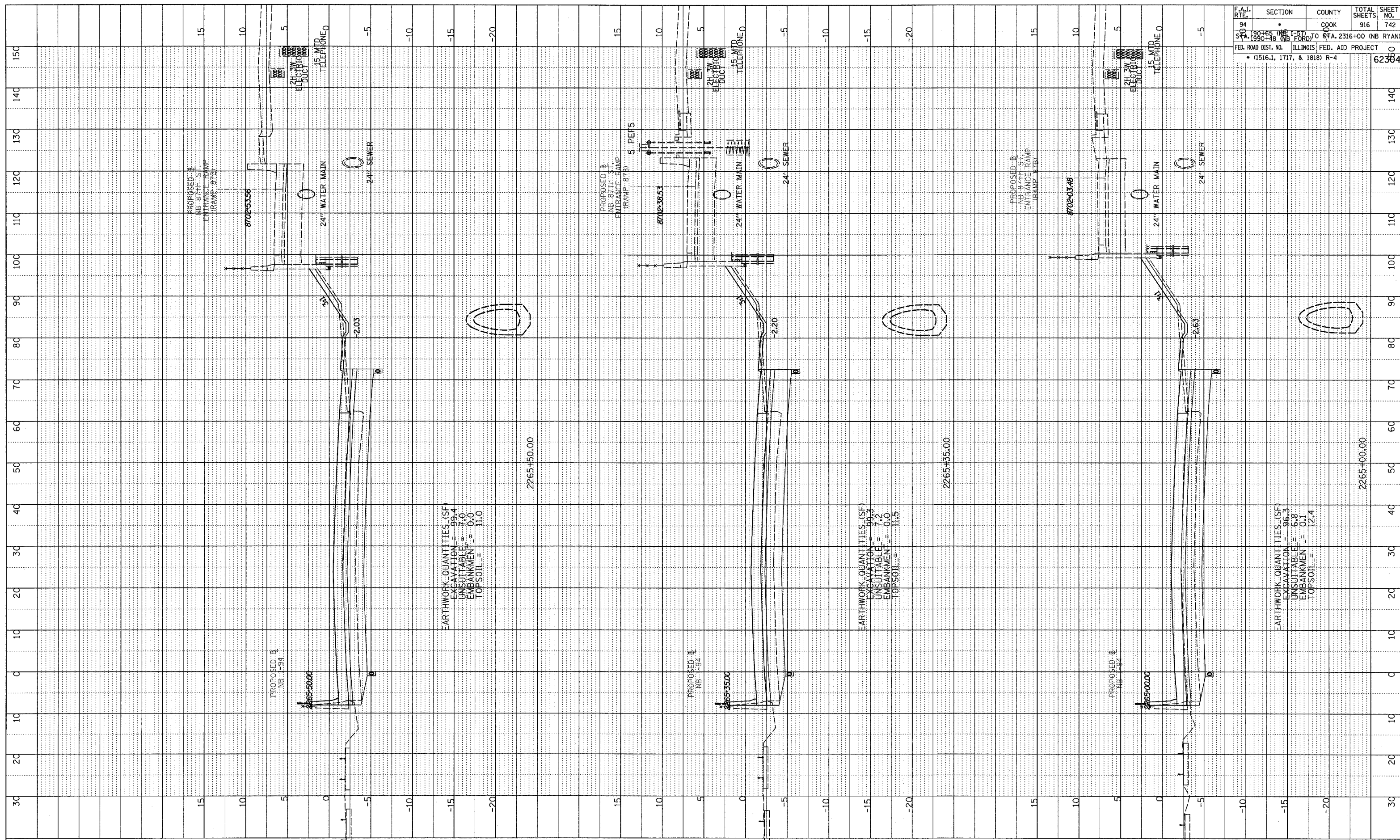

EARTHWORK QUANTITIES (SF)
 EXCAVATION = 99.4
 UNSUITABLE = 7.0
 EMBANKMENT = 0.0
 TOPSOIL = 11.0

EARTHWORK QUANTITIES (SF)
 EXCAVATION = 99.3
 UNSUITABLE = 7.2
 EMBANKMENT = 0.0
 TOPSOIL = 11.5

EARTHWORK QUANTITIES (SF)
 EXCAVATION = 96.3
 UNSUITABLE = 6.8
 EMBANKMENT = 0.1
 TOPSOIL = 12.4

TYLIN INTERNATIONAL

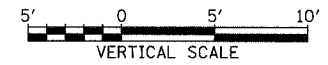
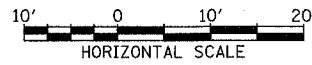

NORTHBOUND I-94 (DAN RYAN EXPWY)
 STA. 2265+00 TO STA. 2265+50

F.A.I. RTE.	SECTION	COUNTY	TOTAL SHEETS	SHEET NO.
94	190+65 (NB I-94) TO STA. 2316+00 (NB RYAN)	COOK	916	742
FED. ROAD DIST. NO. ILLINOIS FED. AID PROJECT • (1516.1, 1717, & 1818) R-4				

03/03/2006 04:48:30 PM