

DATE	BY
PROFILE SURVEYED _____ GRADES CHECKED _____ NOTE BOOK _____ NO. _____ DATE _____ NO. _____	

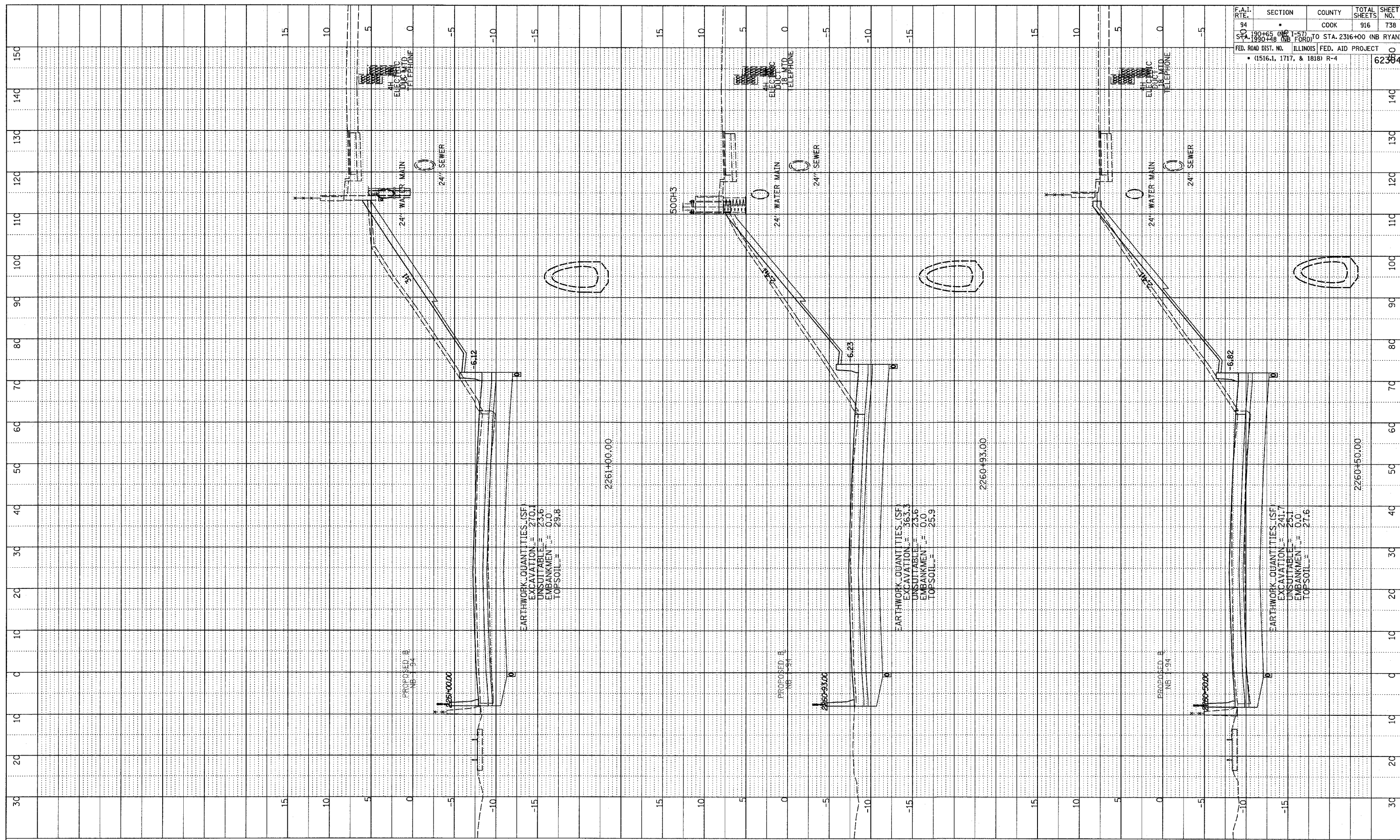

F.A.I. RTE.	SECTION	COUNTY	TOTAL SHEETS	SHEET NO.
94		COOK	916	738
STA. 190+65 (NB I-57) TO STA. 2316+00 (NB RYAN) STA. 190+48 (NB I-57) TO STA. 2316+00 (NB RYAN)				
FED. ROAD DIST. NO. ILLINOIS FED. AID PROJECT • (1516.1, 1717, & 1818) R-4				

TYLIN INTERNATIONAL

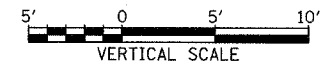
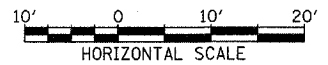

NORTHBOUND I-94 (DAN RYAN EXPWY)  
 STA. 2260+50 TO STA. 2261+00

03/03/2006 04:48:28 PM