

PROFILE SURVEYED BY _____ DATE _____
 GRADES CHECKED BY _____
 NOTE BOOK NO. _____
 STRUCTURE NO. _____

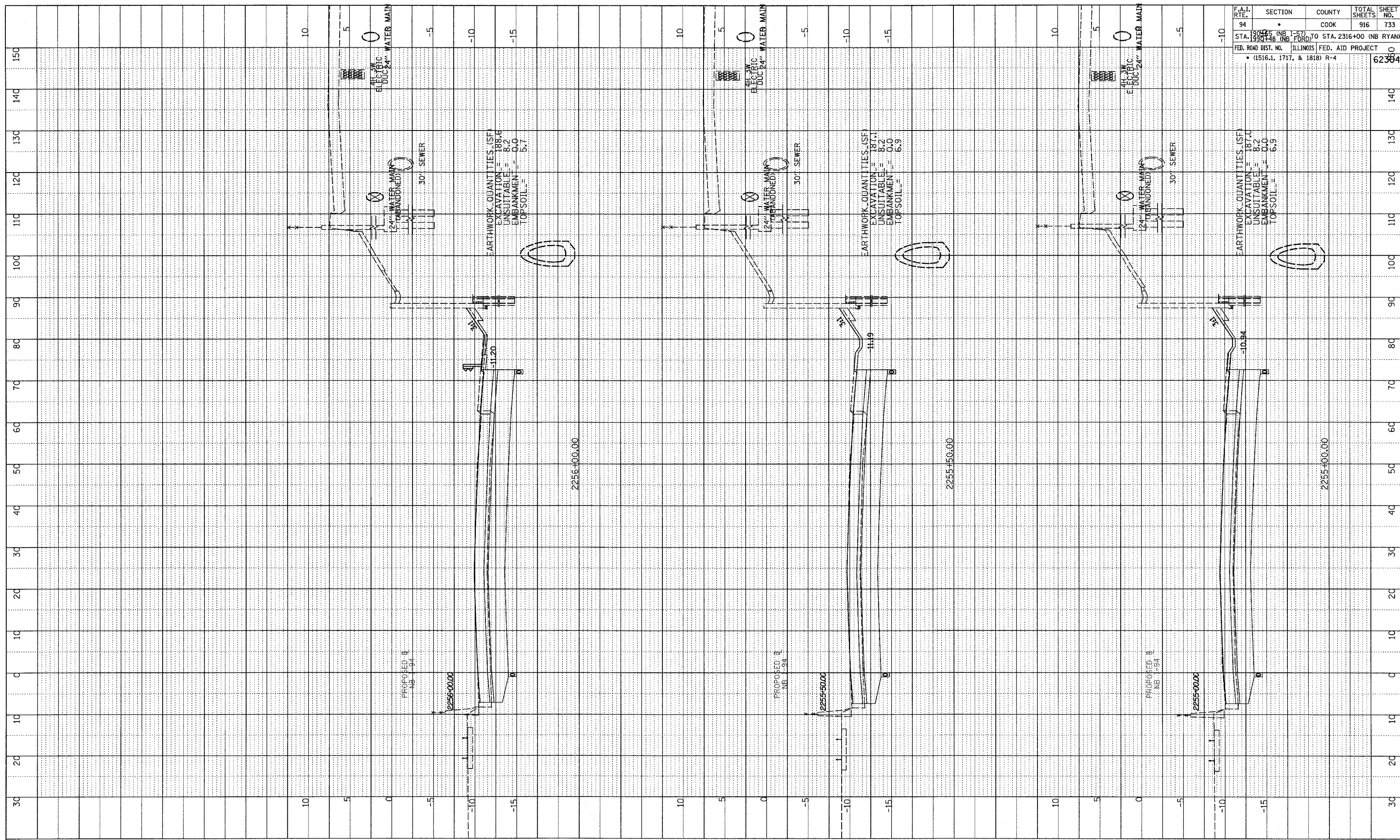

F.A.I. RTE.	SECTION	COUNTY	TOTAL SHEETS	SHEET NO.
94	1950+00 (NB I-57) TO STA. 2316+00 (NB RYAN)	COOK	916	733
STA. 1950+00 (NB I-57) TO STA. 2316+00 (NB RYAN) FED. ROAD DIST. NO. ILLINOIS FED. AID PROJECT (1516.1, 1717, & 1818) R-4				
				62384

TYLIN INTERNATIONAL

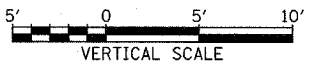
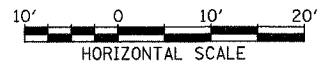

NORTHBOUND I-94 (DAN RYAN EXPWY)
 STA. 2255+00 TO STA. 2256+00

03/03/2006 04:44:15 PM