

PROFILE
 SUBMITTED BY _____ DATE _____
 PLOTTED BY _____
 GRADES CHECKED BY _____
 STRUCTURE NOTATIONS CHECKED BY _____
 NO. _____

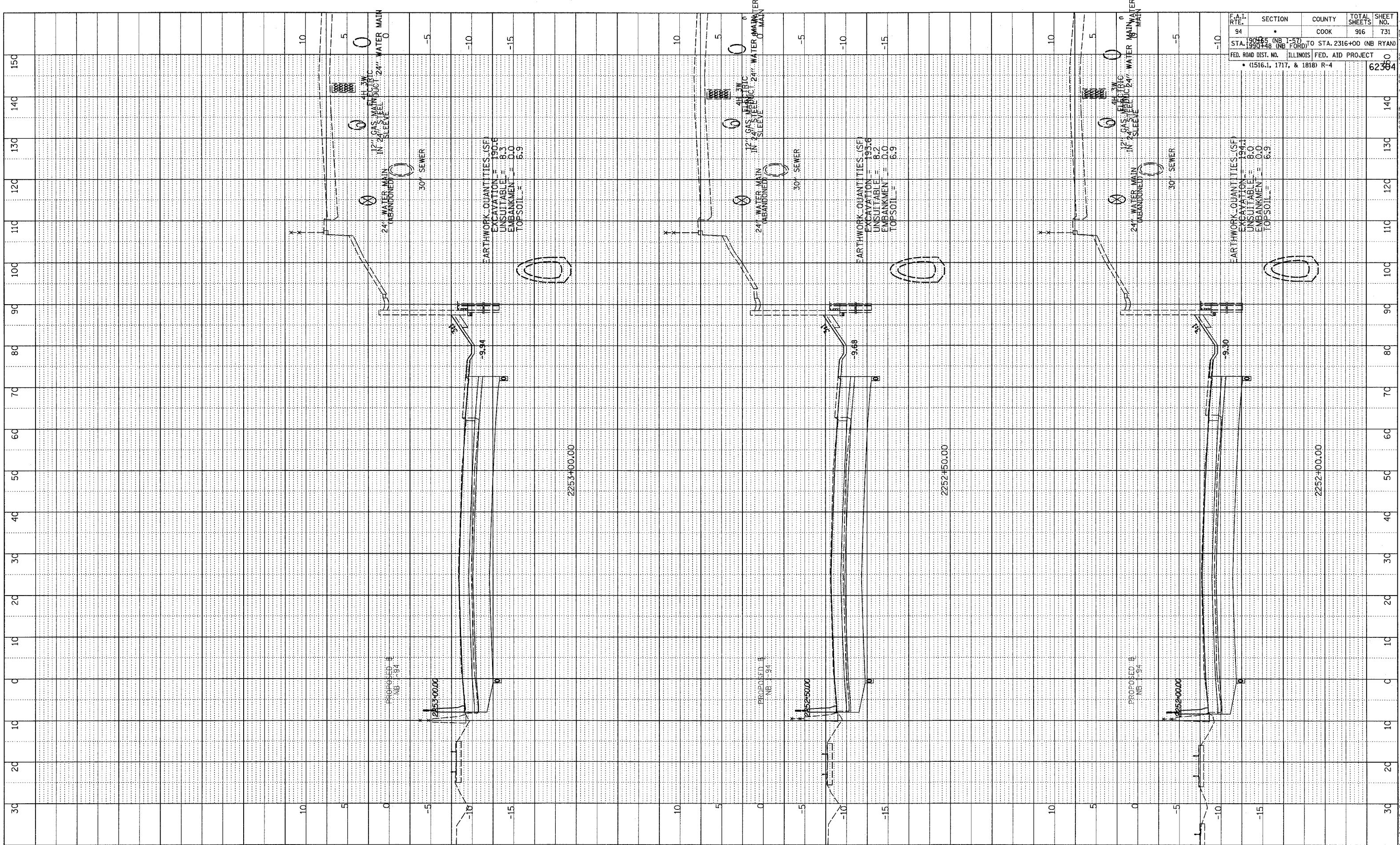

F.A.I. RTE.	SECTION	COUNTY	TOTAL SHEETS	SHEET NO.
94	1904+05 (NB I-57) TO STA. 2316+00 (NB RYAN)	COOK	916	731
STA. 1904+05 (NB I-57) TO STA. 2316+00 (NB RYAN) FED. ROAD DIST. NO. ILLINOIS FED. AID PROJECT • (1516.1, 1717, & 1818) R-4				

TYLIN INTERNATIONAL

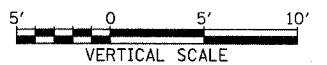

NORTHBOUND I-94 (DAN RYAN EXPWY)
 STA. 2252+00 TO STA. 2253+00

03/03/2006 04:11:15 PM