

PROFILE SURVEYED
 PLOTTED
 NOTE BOOK GRADES CHECKED
 NO. _____ STRUCTURE NOTATIONS OK'D

BY _____ DATE _____

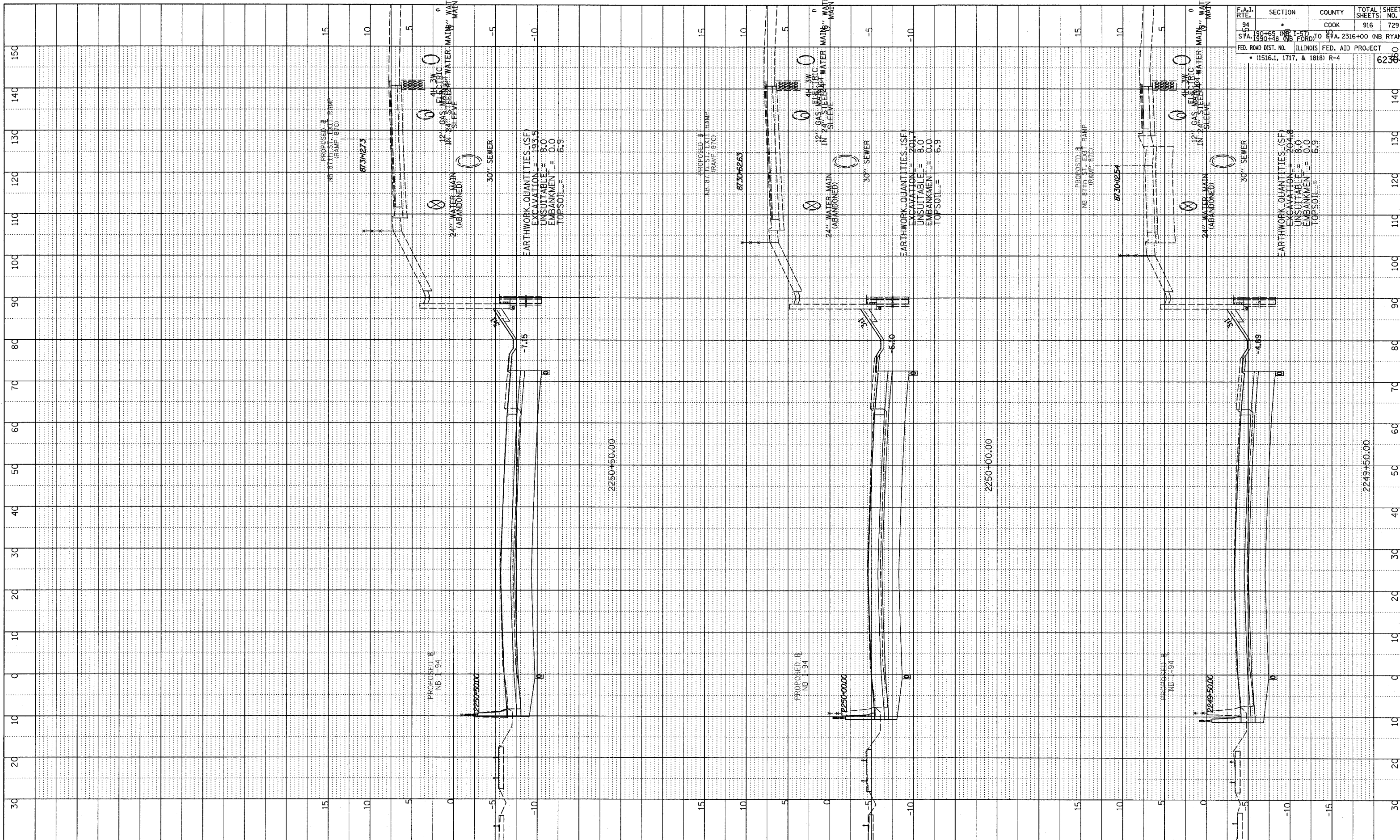

F.A.I. RTE.	SECTION	COUNTY	TOTAL SHEETS	SHEET NO.
94	1-57	COOK	916	729
STA. 199+55 TO 204+80	1-57	FORD	2316+00	(NB RYAN)
FED. ROAD DIST. NO. ILLINOIS FED. AID PROJECT				
• (1516.1, 1717, & 1818) R-4				

TYLIN INTERNATIONAL

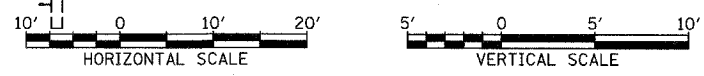

NORTHBOUND I-94 (DAN RYAN EXPWY)
 STA. 2249+50 TO STA. 2250+50

03/03/2006 04:10:09 PM R:\0231\3\road\220\pk20\ss\B1.cad