

PROFILE SUBMITTED BY: _____ DATE: _____
 NOTE BOOK GRADES CHECKED BY: _____
 NO. _____ DATE: _____

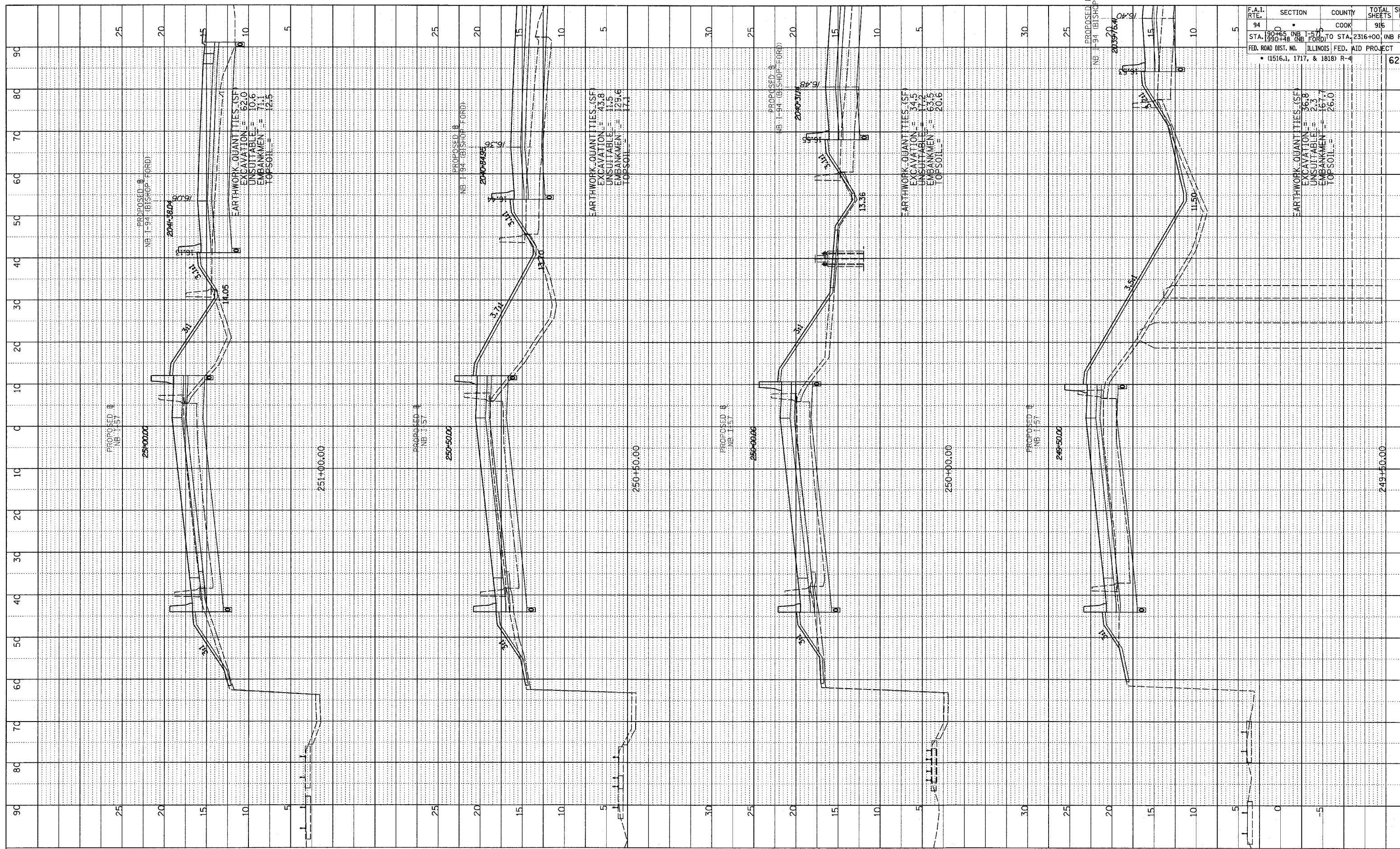

F.A.I. RTE.	SECTION	COUNTY	TOTAL SHEETS	SHEET NO.
94	190+00	COOK	916	690
STA. 190+00 (NB I-57) TO STA. 2316+00 (NB RYAN)				
FED. ROAD DIST. NO. ILLINOIS FED. AID PROJECT				
• (1516.1, 1717, & 1818) R-4				
				62304

EARTHWORK QUANTITIES (SF)
 EXCAVATION = 62.0
 UNSUITABLE = 10.6
 EMBANKMENT = 71.1
 TOP SOIL = 12.5

EARTHWORK QUANTITIES (SF)
 EXCAVATION = 43.8
 UNSUITABLE = 11.5
 EMBANKMENT = 129.6
 TOP SOIL = 17.1

EARTHWORK QUANTITIES (SF)
 EXCAVATION = 34.5
 UNSUITABLE = 17.3
 EMBANKMENT = 63.5
 TOP SOIL = 20.6

EARTHWORK QUANTITIES (SF)
 EXCAVATION = 36.8
 UNSUITABLE = 2.3
 EMBANKMENT = 167.7
 TOP SOIL = 26.0

TYLIN INTERNATIONAL

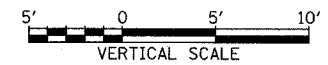
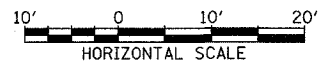

NORTHBOUND I-57
 STA. 249+50 TO STA. 251+00

03/03/2006 04:04:42 PM