

PROFILE SURVEYED BY \_\_\_\_\_ DATE \_\_\_\_\_  
 GRADES CHECKED BY \_\_\_\_\_  
 NOTE BOOK NO. \_\_\_\_\_  
 STRUCTURE NOTATIONS CHECKED BY \_\_\_\_\_

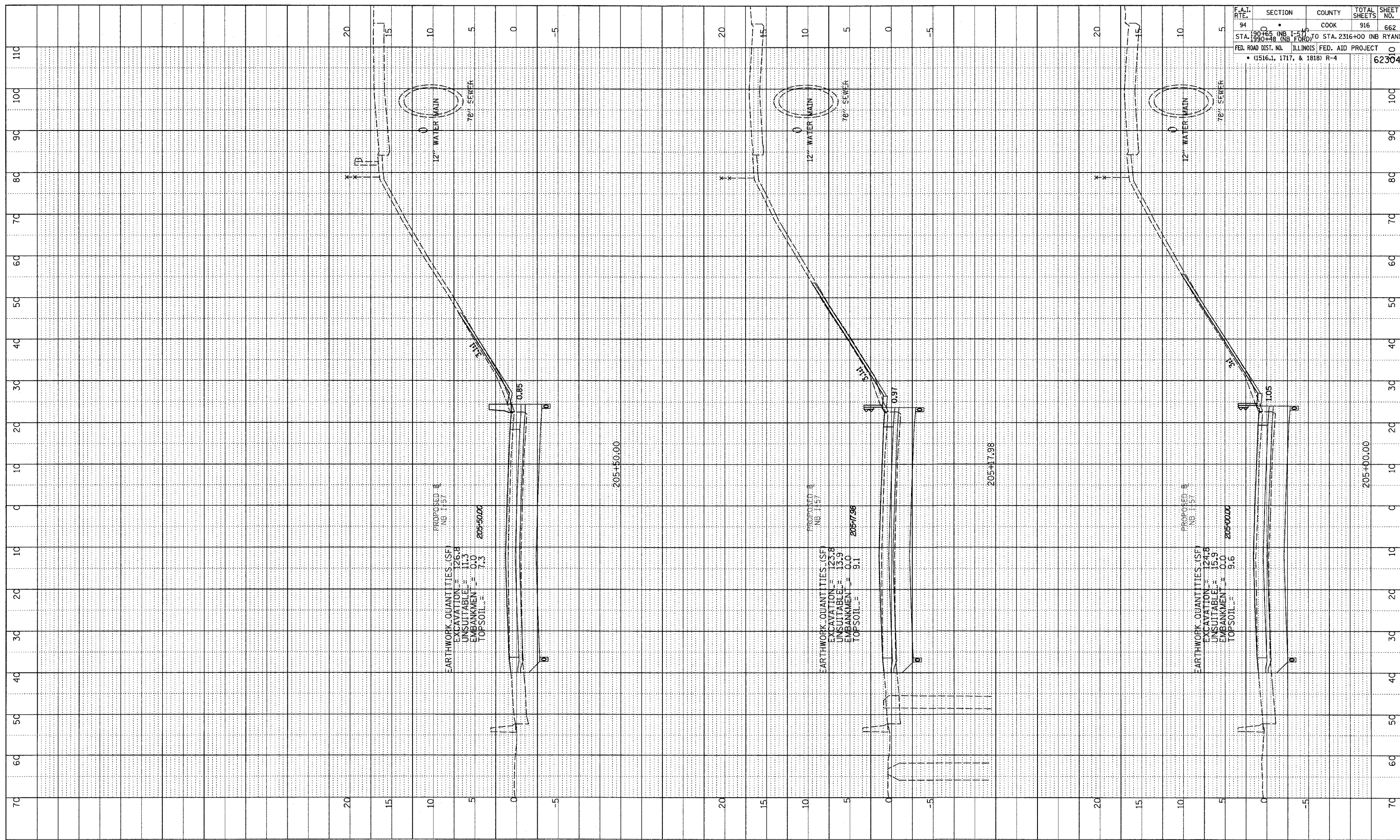

F.A.T. RTE.	SECTION	COUNTY	TOTAL SHEETS	SHEET NO.
94	190+00	COOK	916	662
STA. 190+00 (NB I-57) TO STA. 2316+00 (NB RYAN)				
FED. ROAD DIST. NO. ILLINOIS FED. AID PROJECT				
• (1516.1, 1717, & 1818) R-4				
				62304

TYLIN INTERNATIONAL

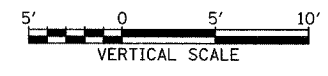
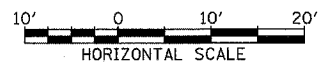

NORTHBOUND I-57  
 STA. 205+00 TO STA. 205+50

03/03/2006 04:04:23 PM