

F.A.I. RTE.	SECTION	COUNTY	TOTAL SHEETS	SHEET NO.
94		COOK	916	297
STA. 190+65 (NB I-57) TO STA. 2316+00 (NB RYAN)				
FED. ROAD DIST. NO. ILLINOIS FED. AID PROJECT				
• (1516.1, 1717, & 1818) R-4 62304				

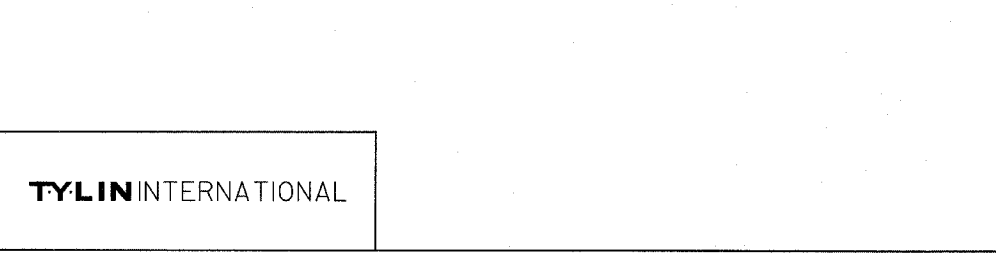

- LEGEND:**
- TEMPORARY EROSION CONTROL SEEDING
  - SEDIMENT CONTROL, SILT FENCE
  - INLET FILTER, TO BE INSTALLED IN OFF PROJECT DRAINAGE STRUCTURES ACCEPTING STORMWATER RUNOFF
  - TEMPORARY FENCE
  - TEMPORARY DITCH CHECK
  - PROPOSED DRAINAGE SWALE (SEE DRAINAGE PLANS)
  - EXISTING DRAINAGE SWALE
  - TEMPORARY FENCE FOR TREE PROTECTION (15 FEET PER SIDE = 60 FEET TOTAL)

TOTAL NUMBER OF INLET FILTERS THIS SHEET: 5  
TOTAL NUMBER OF TEMPORARY DITCH CHECKS THIS SHEET: 6  
TOTAL NUMBER OF TREES TO BE PROTECTED THIS SHEET: 0

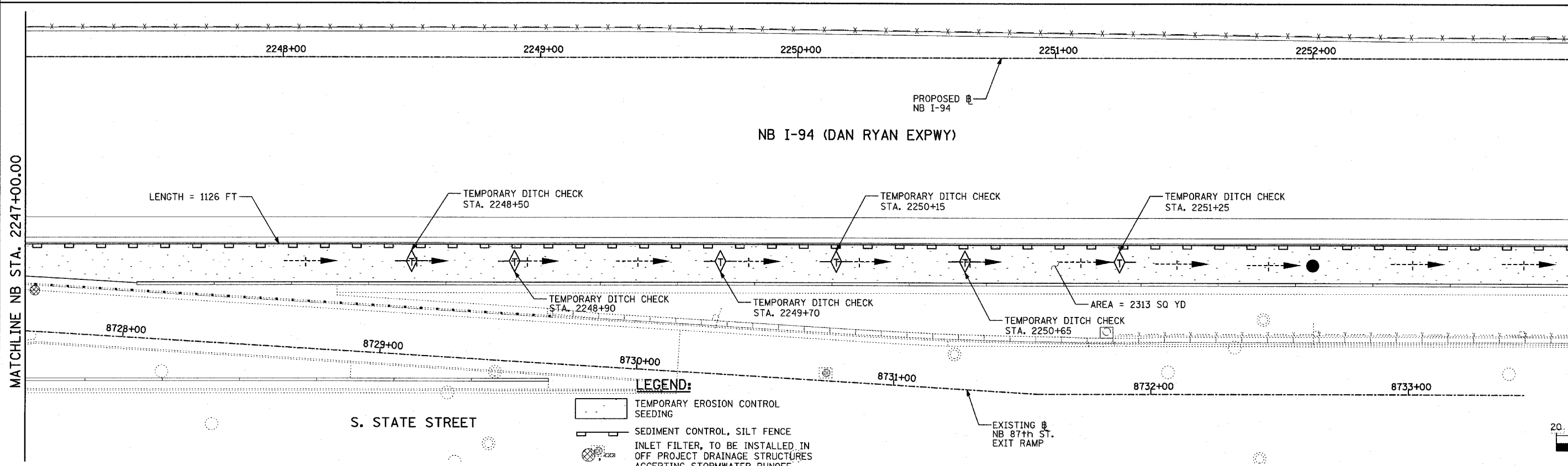
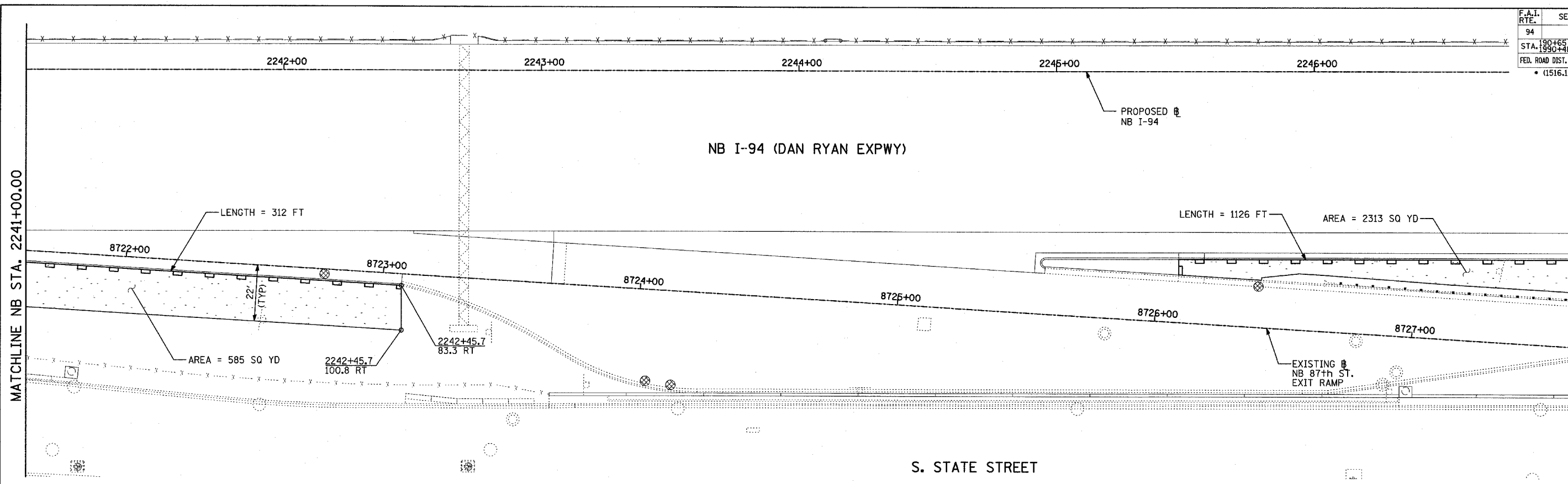
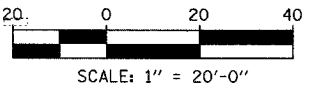
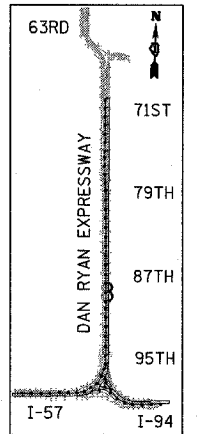
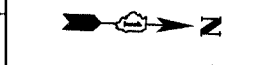

REVISIONS	
NAME	DATE

ILLINOIS DEPARTMENT OF TRANSPORTATION  
F.A.I. 94 (DAN RYAN EXPRESSWAY)  
**EROSION CONTROL PLAN**  
NB I-94 (DAN RYAN EXPRESSWAY)  
STA. 2241+00.00 TO 2253+00.00  
(SHEET 15 OF 28)  
SCALE: 1"=20'  
DATE: MARCH 7, 2006  
DRAWN BY: JJS  
CHECKED BY: MPG

**TYLIN INTERNATIONAL**

P:\02373\road\020\ec\020615.dgn