

TRUCKS LEAVING HIGHWAY

W21-I105

**SUGGESTED ACCESS FROM EXPRESS LANES**

- LEGEND:**
- TEMPORARY CONCRETE BARRIER
  - TRAFFIC LANE
  - CONSTRUCTION TRAFFIC
  - WORK ZONE
  - DRUM WITH MONO-DIRECTIONAL STEADY BURNING LIGHT
  - ARROW BOARD

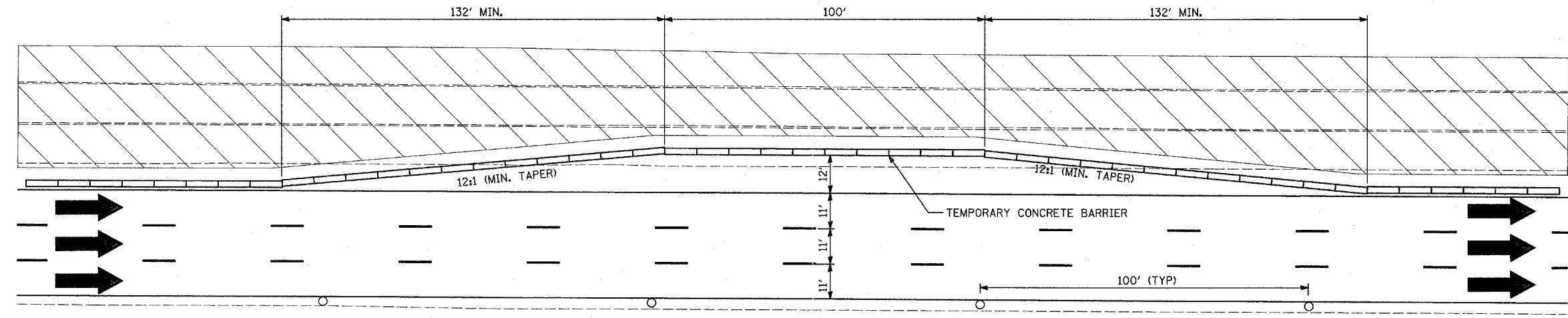

**MAINTENANCE OF TRAFFIC EMERGENCY TURNOUT DETAIL**  
EMERGENCY TURNOUTS WILL BE LOCATED APPROXIMATELY EVERY HALF MILE

**NOTES:**

1. THERE CAN BE NO MORE THAN TWO (2) WORK ZONE ACCESS/EGRESS COMBINATIONS AND THE CONTRACTOR MUST MAINTAIN AT LEAST ONE (1) EXPRESS LANE ACCESS DURING STAGE 2 CONSTRUCTION.
2. THE CONTRACTOR SHALL NOT ENTER OR EXIT THE HAUL ROAD WITHIN THE 100' BARREL-SPACING AREA. WORK ZONE ACCESS AND EGRESS WILL ONLY BE PERMITTED AT THE DESIGNATED LOCATIONS.
3. FOR EXPRESS LANE WORK ZONE EGRESS, TAPER LENGTHS SHALL FOLLOW DISTRICT 1 STANDARD TC-18.
4. THE CONTRACTOR SHALL CLOSE OPENINGS WITH BARRELS WHEN NOT BEING USED FOR ACCESS.
5. TEMPORARY PAVEMENT MARKINGS SHALL BE CARRIED THRU THE OPENING.

TYLIN INTERNATIONAL

REVISIONS	
NAME	DATE

ILLINOIS DEPARTMENT OF TRANSPORTATION  
F.A.I. 94 (DAN RYAN EXPRESSWAY)  
GENERAL NOTES  
CONSTRUCTION STAGING NOTES  
MAINTENANCE OF TRAFFIC DETAILS  
SHEET 13 OF 13

SCALE: NO SCALE      DRAWN BY: RTM  
DATE: MARCH 7, 2006      CHECKED BY: TGB

3/3/2006 3:35:59 PM