

EXISTING CONDITIONS
PROPOSED IMPROVEMENTS

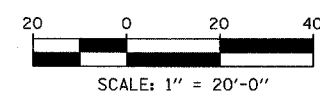
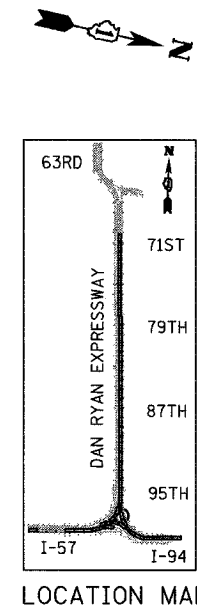
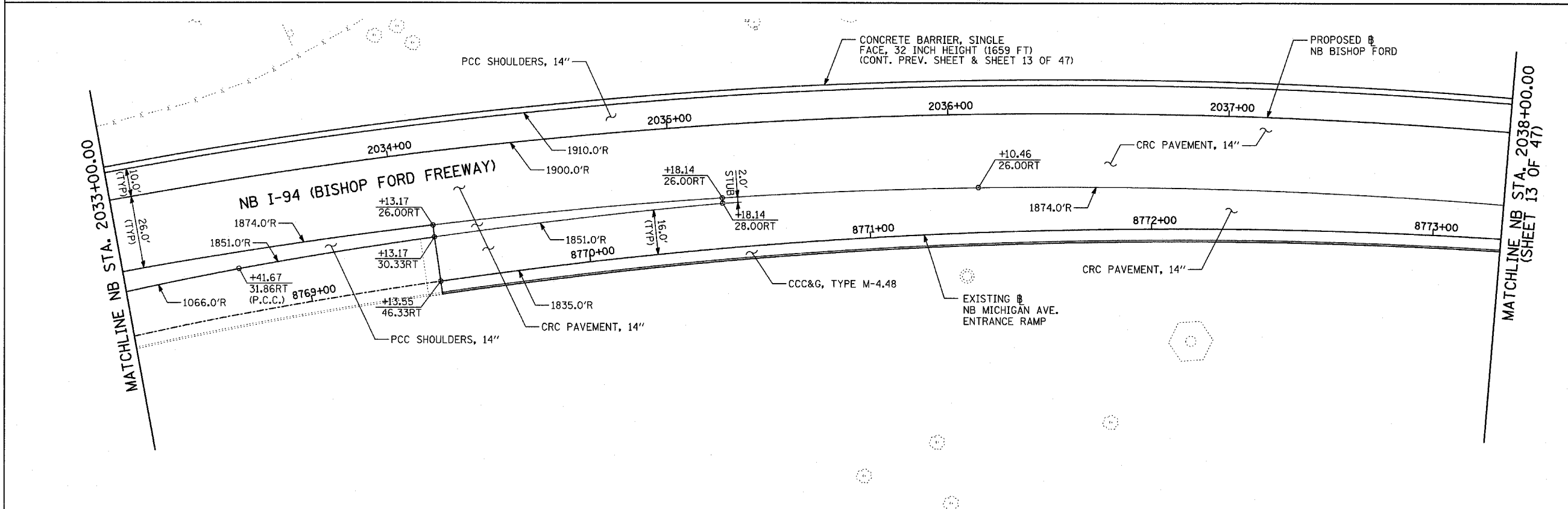

LEGEND:

- ===== COMB CONC CURB & GUTTER REMOVAL
- ~~~~~ CHAIN LINK FENCE REMOVAL
- XXXXXX CONCRETE BARRIER/GUARDRAIL REMOVAL
- ⊗10 TREE REMOVAL (UNITS) (NO UNIT SHOWN = <6)
- ⊕ SOIL BORING LOCATIONS

- [Hatched Box] PAVEMENT REMOVAL
- [Hatched Box] PAVED SHOULDER REMOVAL
- [Hatched Box] PAVEMENT/SHOULDER REMOVAL, SPECIAL
- [Hatched Box] BITUMINOUS SURFACE REMOVAL, 4"
- [Hatched Box] BITUMINOUS SURFACE REMOVAL, 1 1/2" OR 1 3/4" (SEE CALLOUT)

- ⊛ LIGHT POLE FOUNDATION REMOVAL (SEE ROADWAY LIGHTING & SURVEILLANCE PLANS)
- +XX.XX MAINLINE Ⓢ
- XX.XXRT STATION/OFFSET

PLAN NOTES:

- ALL STATION/OFFSET/RADIUS CALLOUTS MEASURED TO EDGE OF PAVEMENT UNLESS OTHERWISE NOTED.
- EXACT LOCATIONS OF EXISTING PIERS/ABUTMENTS TO BE FIELD VERIFIED

TYLIN INTERNATIONAL

SHEET 43 OF 47

REVISIONS	
NAME	DATE

ILLINOIS DEPARTMENT OF TRANSPORTATION
F.A.I. 94 (DAN RYAN EXPRESSWAY)
EXISTING AND PROPOSED PLAN
NB I-94 (BISHOP FORD FREEWAY)
NB STA. 2033+00.00 TO 2038+00.00

SCALE: 1"=20'
DATE: MARCH 7, 2006

DRAWN BY: RTM
CHECKED BY: MPG