

| | | | | |
|---|---------|--------|--------------|-----------|
| F.A.I. RTE. | SECTION | COUNTY | TOTAL SHEETS | SHEET NO. |
| 94 | | COOK | 916 | 83 |
| STA. 190+65 (NB I-57) TO STA. 2316+00 (NB RYAN) | | | | |
| FED. ROAD DIST. NO. ILLINOIS FED. AID PROJECT | | | | |
| (1516.1, 1717, & 1818) R-4 | | | | |

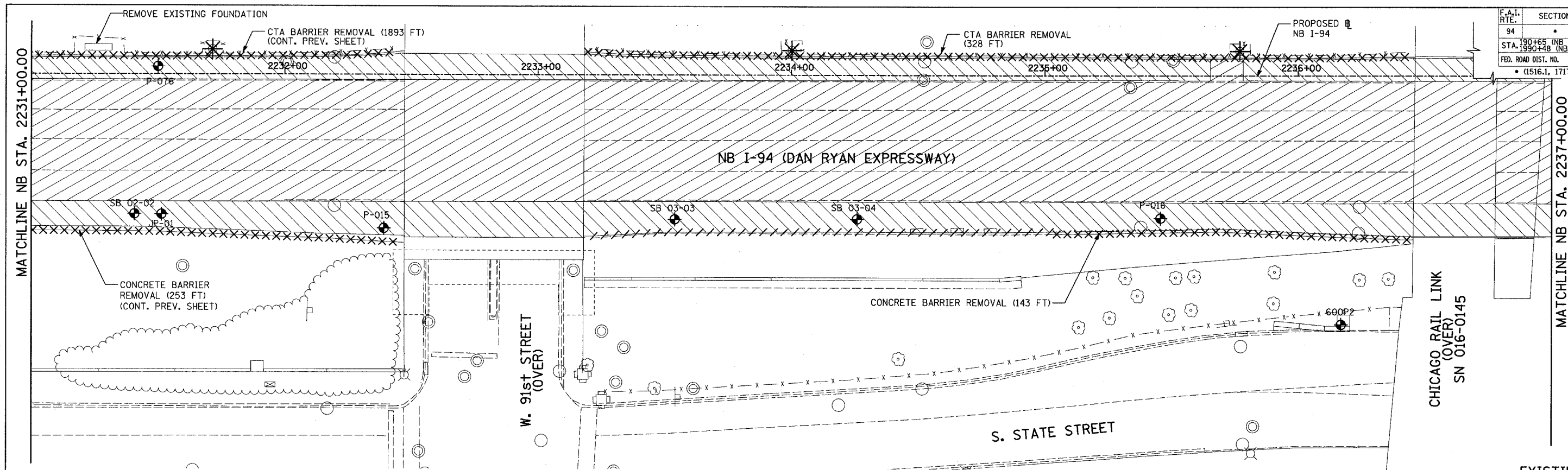

EXISTING CONDITIONS
PROPOSED IMPROVEMENTS

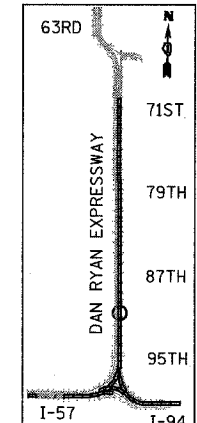
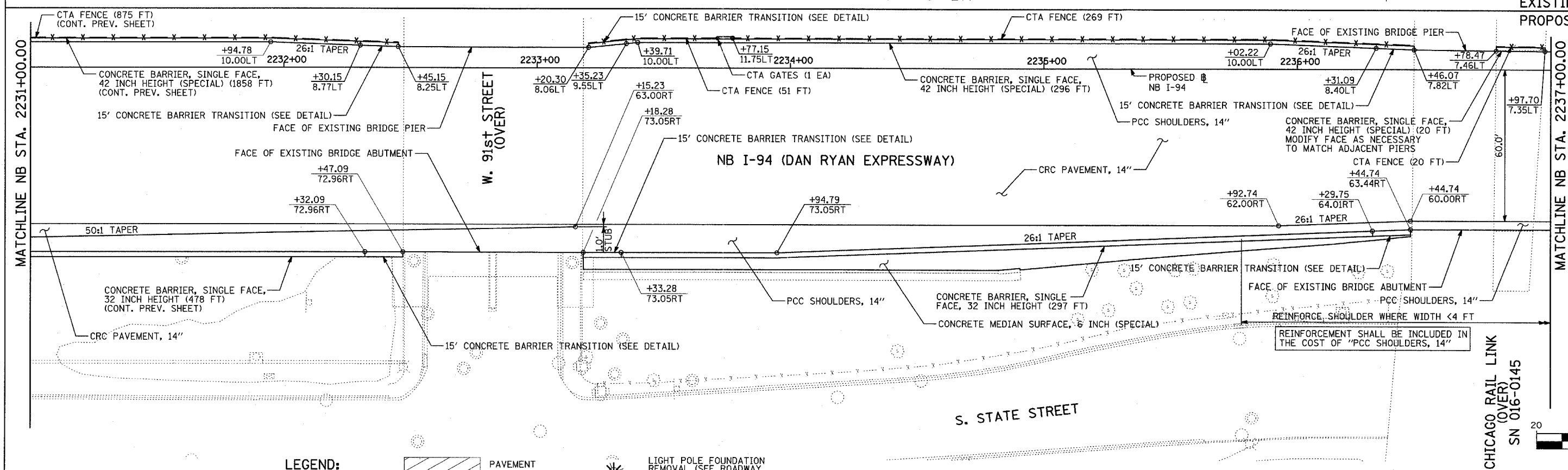

LOCATION MAP

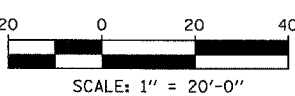

LEGEND:

- ==== COMB CONC CURB & GUTTER REMOVAL
- ~~~~~ CHAIN LINK FENCE REMOVAL
- XXXXXX CONCRETE BARRIER/GUARDRAIL REMOVAL
- ⊗10 TREE REMOVAL (UNITS) (NO UNIT SHOWN = <6)
- ⊕ SOIL BORING LOCATIONS

- [Hatched Box] PAVEMENT REMOVAL
- [Hatched Box] PAVED SHOULDER REMOVAL
- [Hatched Box] PAVEMENT/SHOULDER REMOVAL, SPECIAL
- [Hatched Box] BITUMINOUS SURFACE REMOVAL, 4"
- [Hatched Box] BITUMINOUS SURFACE REMOVAL, 1/2" OR 1/4" (SEE CALLOUT)

- ⊗ LIGHT POLE FOUNDATION REMOVAL (SEE ROADWAY LIGHTING & SURVEILLANCE PLANS)
 - +XX.XX MAINLINE #
 - XX.XXRT STATION/OFFSET
- PLAN NOTES:**
- ALL STATION/OFFSET/RADIUS CALLOUTS MEASURED TO EDGE OF PAVEMENT UNLESS OTHERWISE NOTED.
 - EXACT LOCATIONS OF EXISTING PIERS/ABUTMENTS TO BE FIELD VERIFIED

TYLIN INTERNATIONAL

| REVISIONS | |
|-----------|------|
| NAME | DATE |
| | |
| | |
| | |
| | |
| | |
| | |

ILLINOIS DEPARTMENT OF TRANSPORTATION
F.A.I. 94 (DAN RYAN EXPRESSWAY)
EXISTING AND PROPOSED PLAN
NB I-94 (DAN RYAN EXPRESSWAY)
NB I-94 STA. 2231+00.00 TO 2237+00.00

SCALE: 1"=20'
DATE: MARCH 7, 2006

DRAWN BY: RTM
CHECKED BY: MPG