

| F.A.P. RTE.           | SECTION       | COUNTY         | TOTAL SHEETS     | SHEET NO. |
|-----------------------|---------------|----------------|------------------|-----------|
| 55                    | 100 (1&2) I-9 | WILL           | 59               | 25        |
| STA. 772+00           |               | TO STA. 787+00 |                  |           |
| FED. ROAD DIST. NO. 1 |               | ILLINOIS       | FED. AID PROJECT |           |
| PLN-14 OF 27          |               |                |                  |           |

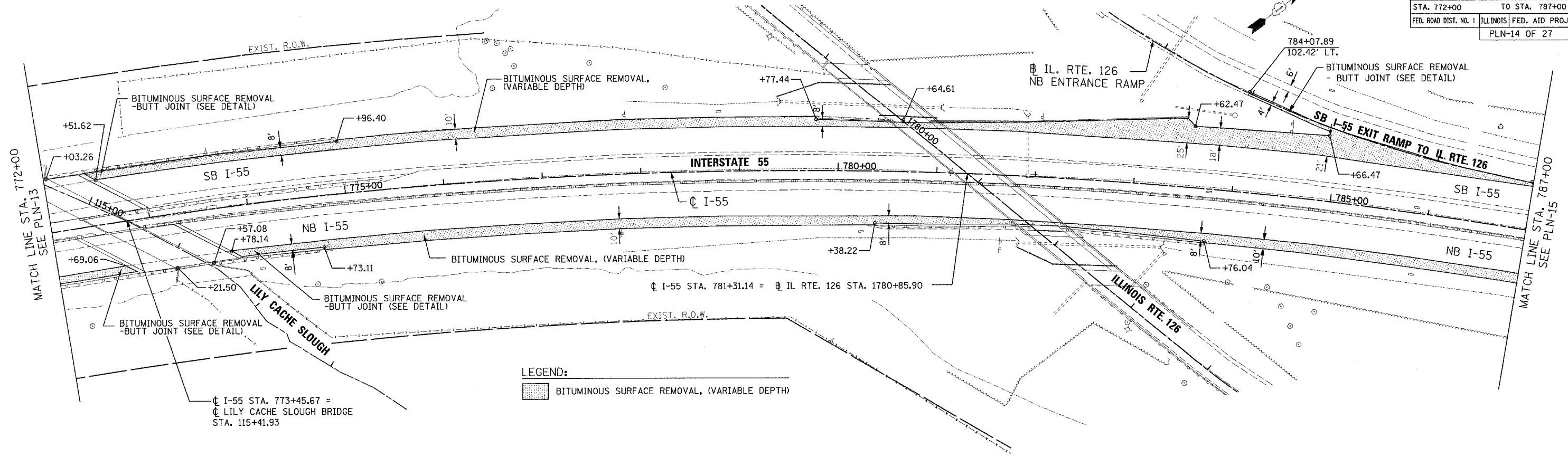

**LEGEND:**  
 BITUMINOUS SURFACE REMOVAL, (VARIABLE DEPTH)

EXISTING CONDITION

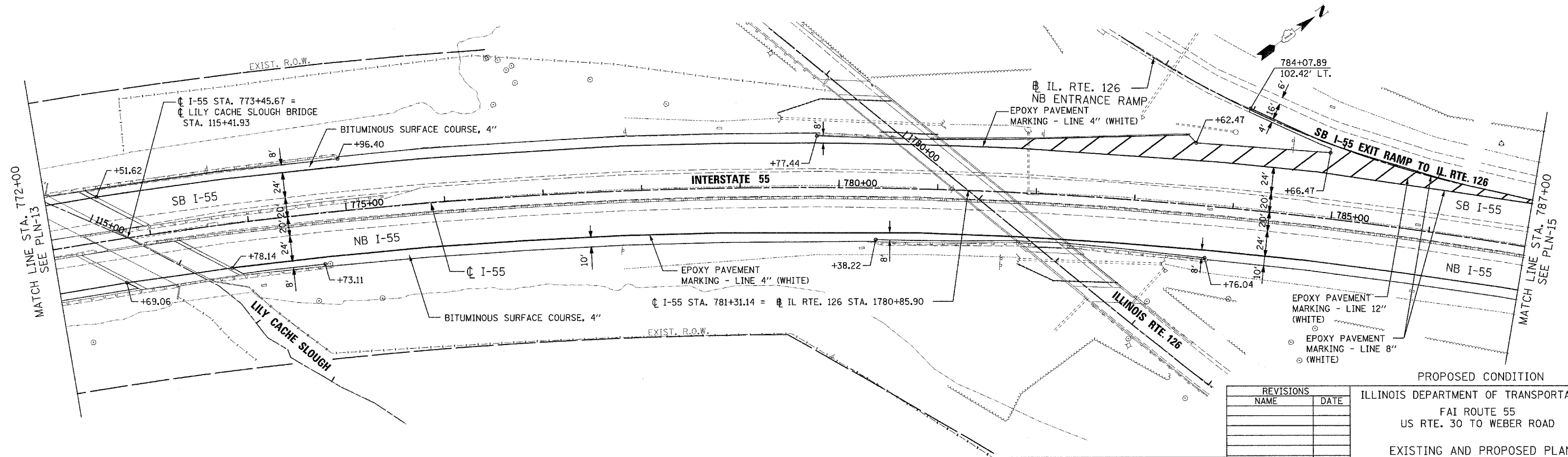

PROPOSED CONDITION

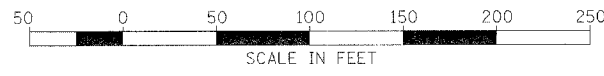

| REVISIONS |      |
|-----------|------|
| NAME      | DATE |
|           |      |
|           |      |
|           |      |
|           |      |
|           |      |
|           |      |
|           |      |
|           |      |
|           |      |
|           |      |

ILLINOIS DEPARTMENT OF TRANSPORTATION  
 FAI ROUTE 55  
 US RTE. 30 TO WEBER ROAD  
 EXISTING AND PROPOSED PLAN

SCALE: 1"=50'  
 DATE: 03-15-06  
 DRAWN BY: ALR  
 CHECKED BY: DM

FINAL