

F.A.I. RTE.	SECTION	COUNTY	TOTAL SHEETS	SHEET NO.
55	99(1&2) I-10	WILL	52	46
STA. TO STA.		ILLINOIS FED. AID PROJECT		
FED. ROAD DIST. NO.				

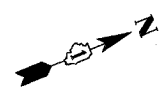
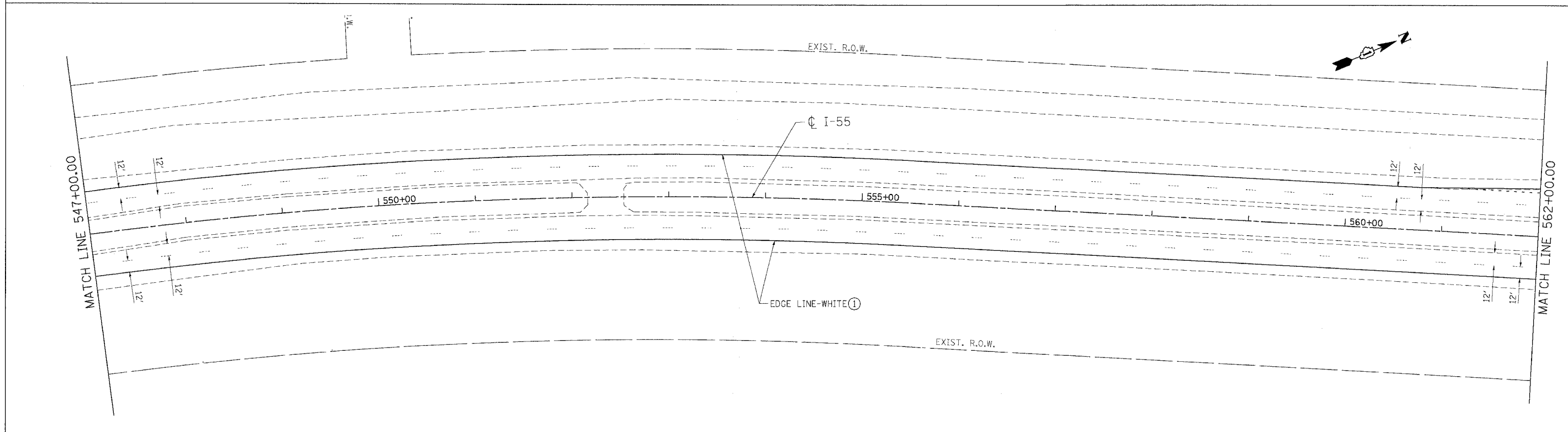
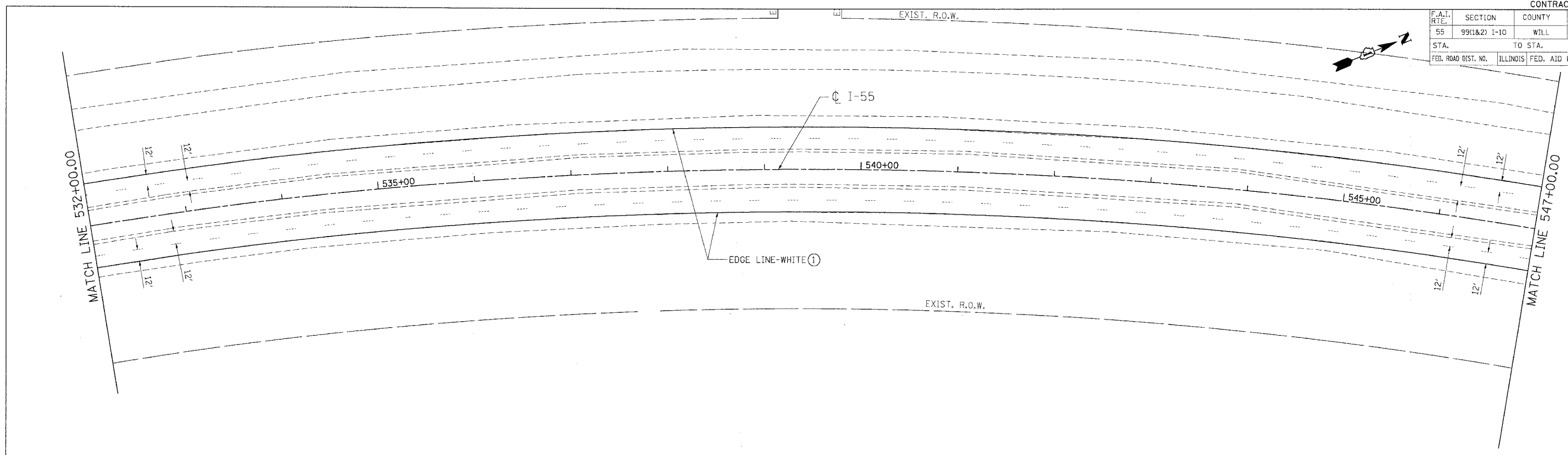
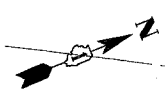

- LEGEND**
- ① EPOXY PAVEMENT MARKING - LINE 4"
  - ② EPOXY PAVEMENT MARKING - LINE 5"
  - ③ EPOXY PAVEMENT MARKING - LINE 8"
  - ④ EPOXY PAVEMENT MARKING - LINE 12"

REVISIONS	
NAME	DATE

ILLINOIS DEPARTMENT OF TRANSPORTATION  
 FAI ROUTE 55 (I-80 TO U.S. 30)  
 SHOULDER MILLING AND RESURFACING

**PAVEMENT MARKING  
 FAI 55  
 STA. 532+00.00 TO STA. 562+00.00**

SCALE: 1"=50'  
 DATE: 03/15/06  
 DRAWN BY: MW  
 CHECKED BY: DDH

**TENG**  
 TENG & ASSOCIATES, INC.  
 ENGINEERS/ARCHITECTS/PLANNERS  
 CHICAGO, ILLINOIS

PLOT DATE = 03/15/06  
 PLOT SCALE = 1"=50'  
 USER NAME = DDH

\\val091a02l.dcn\... \X:\0201ASCA\... \X:\0201ASCA\... \X:\0201ASCA\... \X:\0201ASCA\... \X:\0201ASCA\...  
 3-13-2006, 14:52:55  
 GARCIAZ SANDUCCANT 023616RA\CTVIL\DDH\F051A011.SHT