

F.A.I. RTE.	SECTION	COUNTY	TOTAL SHEETS	SHEET NO.
55	99(1&2) I-10	WILL	52	32
STA.		TO STA.		
FED. ROAD DIST. NO.		ILLINOIS FED. AID PROJECT		

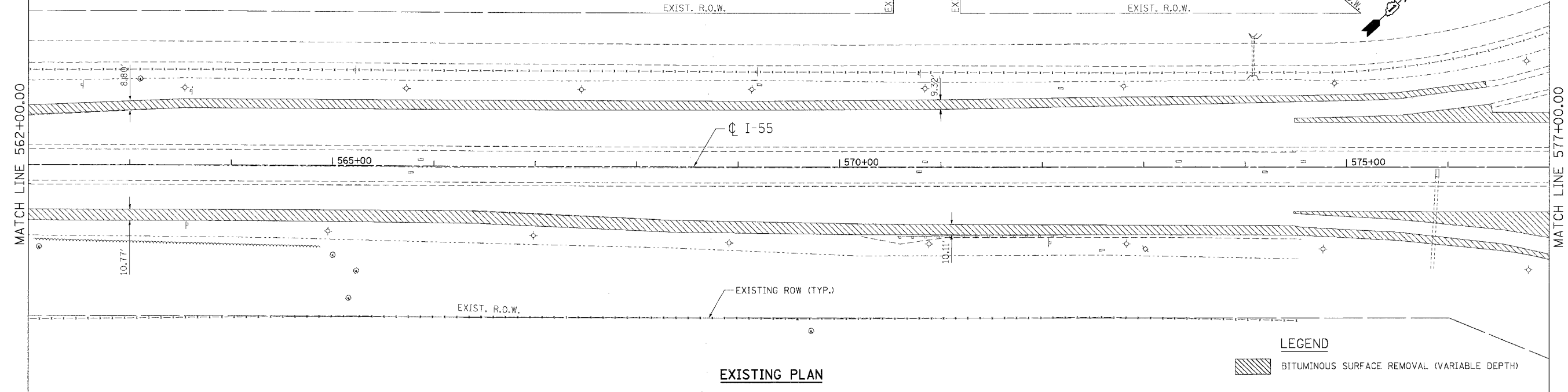

EXISTING PLAN

LEGEND  
 BITUMINOUS SURFACE REMOVAL (VARIABLE DEPTH)

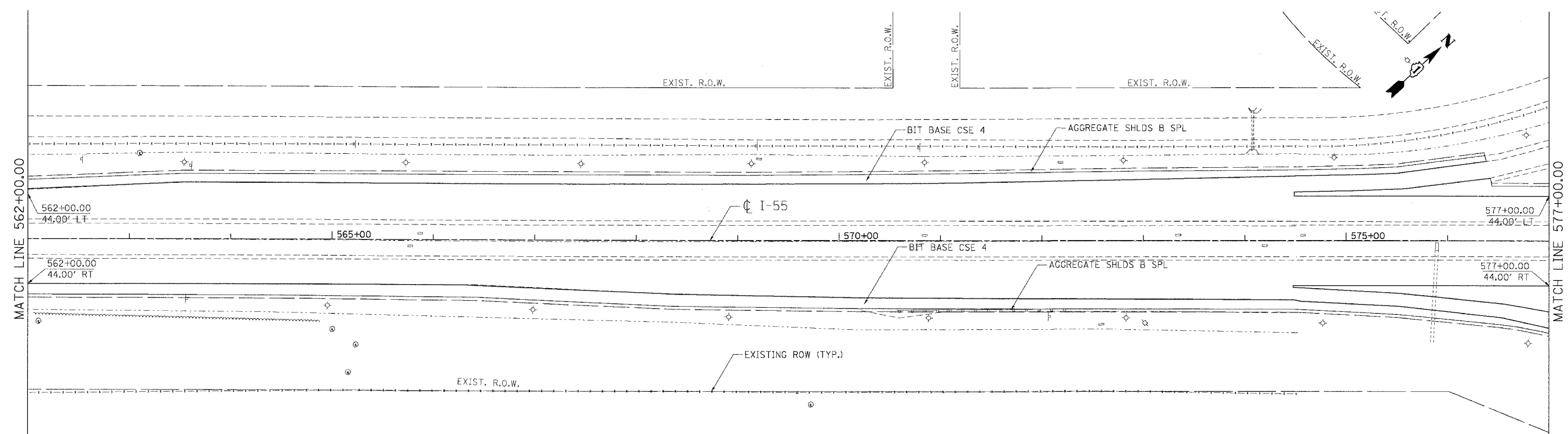

PROPOSED PLAN

REVISIONS	
NAME	DATE

ILLINOIS DEPARTMENT OF TRANSPORTATION  
 FAI ROUTE 55 (I-80 TO U.S. 30)  
 SHOULDER MILLING AND RESURFACING  
**ROADWAY PLAN**  
 FAI 55  
 STA. 562+00.00 TO STA. 577+00.00  
 SCALE: 1"=50'  
 DATE 03/15/06  
 DRAWN BY DP  
 CHECKED BY DDH  
**TENG** TENG & ASSOCIATES, INC.  
 ENGINEERS/ARCHITECTS/PLANNERS  
 CHICAGO, ILLINOIS

PLOT DATE: 03/15/06  
 PLOT SCALE: 1"=50'  
 USER NAME: USER#