

F.A.I. RTE.	SECTION	COUNTY	TOTAL SHEETS	SHEET NO.
55	99(1&2) I-10	WILL	52	30
STA.	TO STA.			
FED. ROAD DIST. NO.	ILLINOIS FED. AID PROJECT			

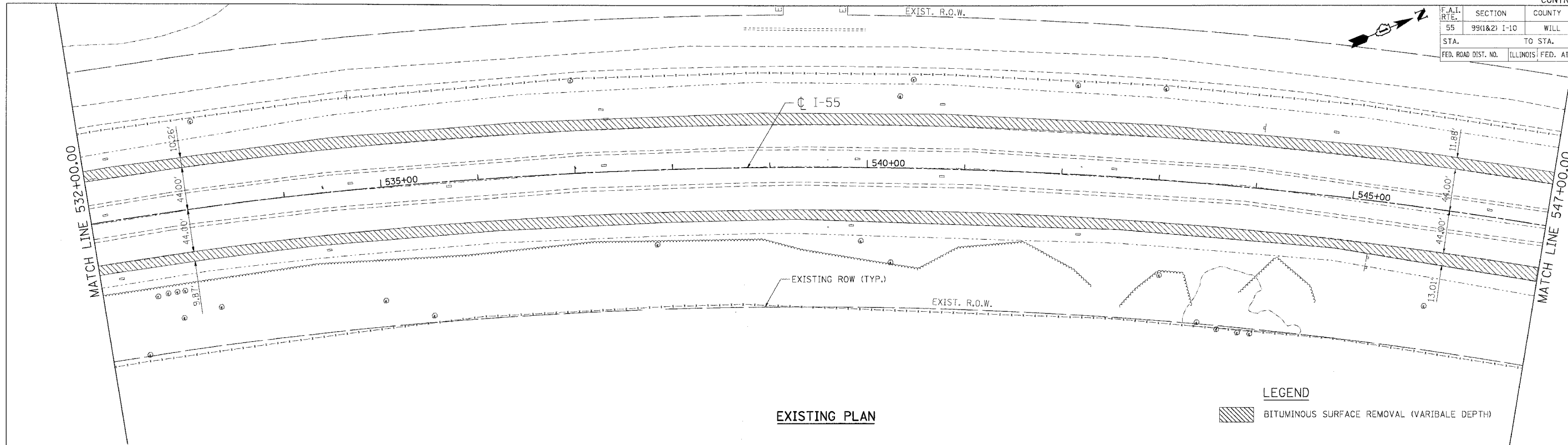

EXISTING PLAN

LEGEND
 BITUMINOUS SURFACE REMOVAL (VARIBALE DEPTH)

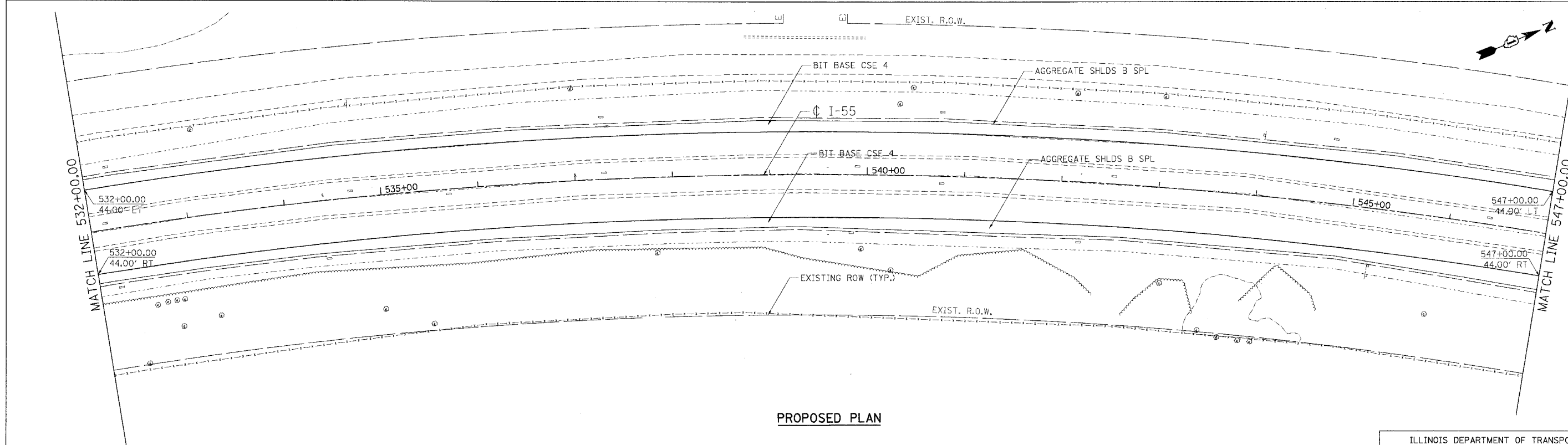

PROPOSED PLAN

PLOT DATE: 03/15/06
 FILE NAME: \\s:\projects\60a68\60a68.dwg
 PLOT SCALE: 1"=50'
 USER NAME: ddh

REVISIONS	
NAME	DATE

ILLINOIS DEPARTMENT OF TRANSPORTATION
 FAI ROUTE 55 (I-80 TO ILS. 30)
 SHOULDER MILLING AND RESURFACING

ROADWAY PLAN
FAI 55
STA. 532+00.00 TO STA. 547+00.00

SCALE: 1"=50'
 DATE: 03/15/06

DRAWN BY: OP
 CHECKED BY: DDH

TENG
 TENG & ASSOCIATES, INC.
 ENGINEERS/ARCHITECTS/PLANNERS
 CHICAGO, ILLINOIS