

F.A.I. RTE.	SECTION	COUNTY	TOTAL SHEETS	SHEET NO.
55	99(1&2) I-10	WILL	52	21
STA. TO STA.		ILLINOIS FED. AID PROJECT		
FED. ROAD DIST. NO.				

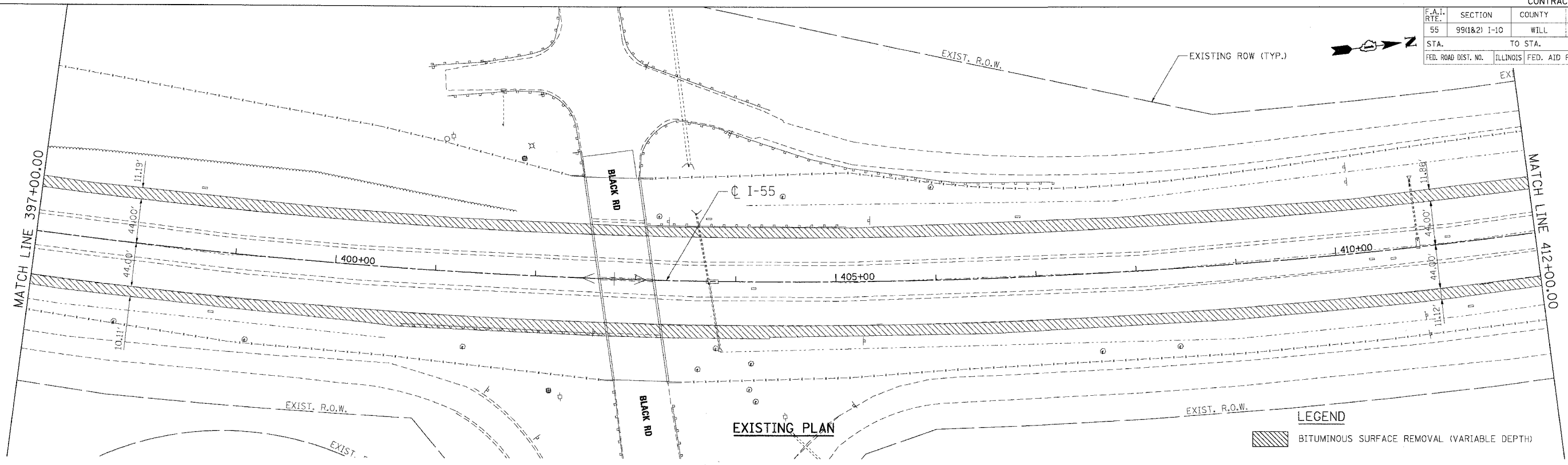

LEGEND

BITUMINOUS SURFACE REMOVAL (VARIABLE DEPTH)

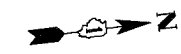
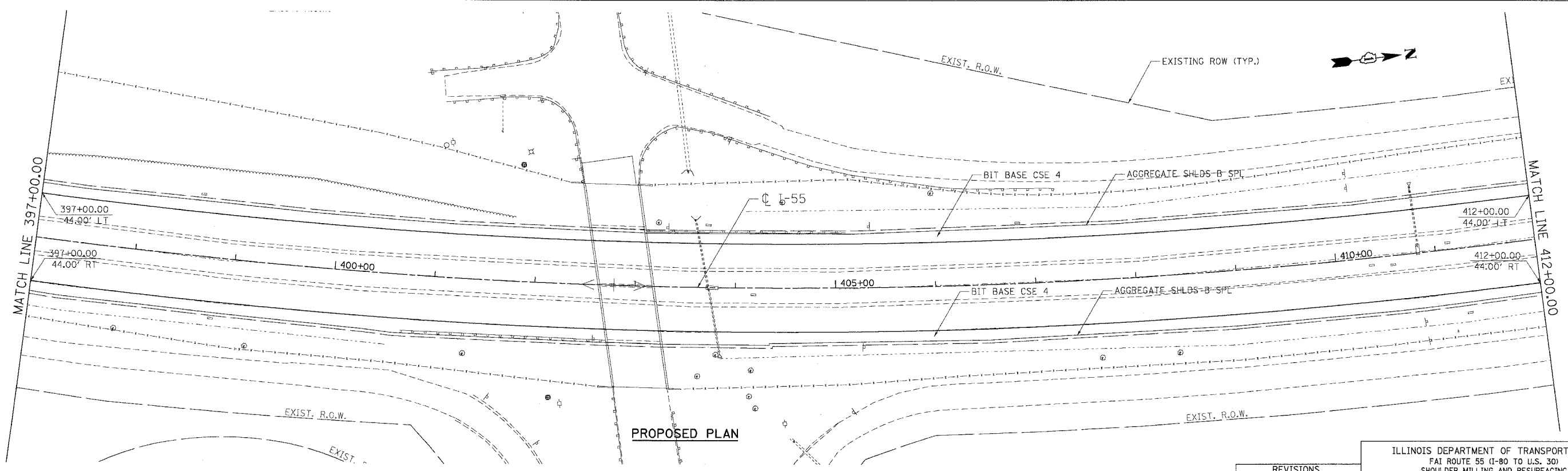

REVISIONS	
NAME	DATE

ILLINOIS DEPARTMENT OF TRANSPORTATION
 FAI ROUTE 55 (I-80 TO U.S. 30)
 SHOULDER MILLING AND RESURFACING

ROADWAY PLAN
 FAI 55
 STA. 397+00.00 TO STA. 412+00.00

SCALE: 1"=50'
 DATE 03/15/06
 DRAWN BY OP
 CHECKED BY DDH

TENG
 TENG & ASSOCIATES, INC.
 ENGINEERS/ARCHITECTS/PLANNERS
 CHICAGO, ILLINOIS

PLOT DATE = 03/15/06
 FILE NAME = 031506.DWG
 PLOT SCALE = 1/4"=1'-0"
 USER NAME = USER
 \\N:\991021\DDN\991021\991021.DWG...
 3-13-2006 14:49:55
 SANDOCUMENT 02381587\CIVIL\DDN\991021.DWG