

| F.A.I. RTE. | SECTION      | COUNTY | TOTAL SHEETS | SHEET NO. |
|-------------|--------------|--------|--------------|-----------|
| 55          | 99(1&2) I-10 | WILL   | 52           | 16        |

| STA.                | TO STA.                   |
|---------------------|---------------------------|
| FED. ROAD DIST. NO. | ILLINOIS FED. AID PROJECT |

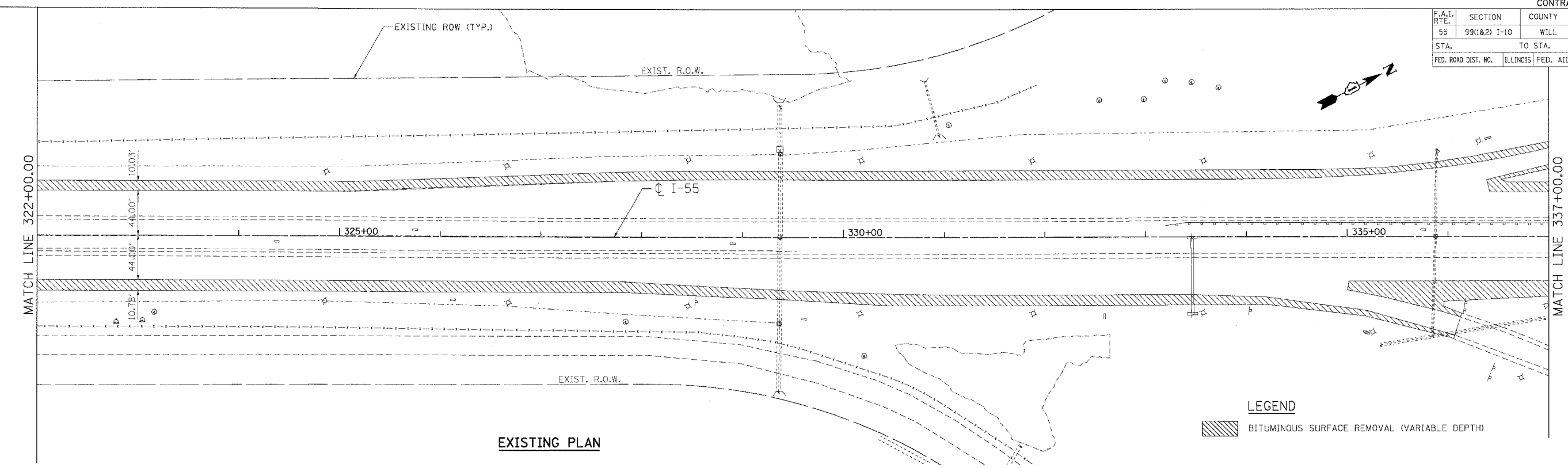
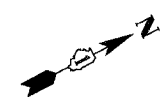

**EXISTING PLAN**

**LEGEND**

BITUMINOUS SURFACE REMOVAL (VARIABLE DEPTH)

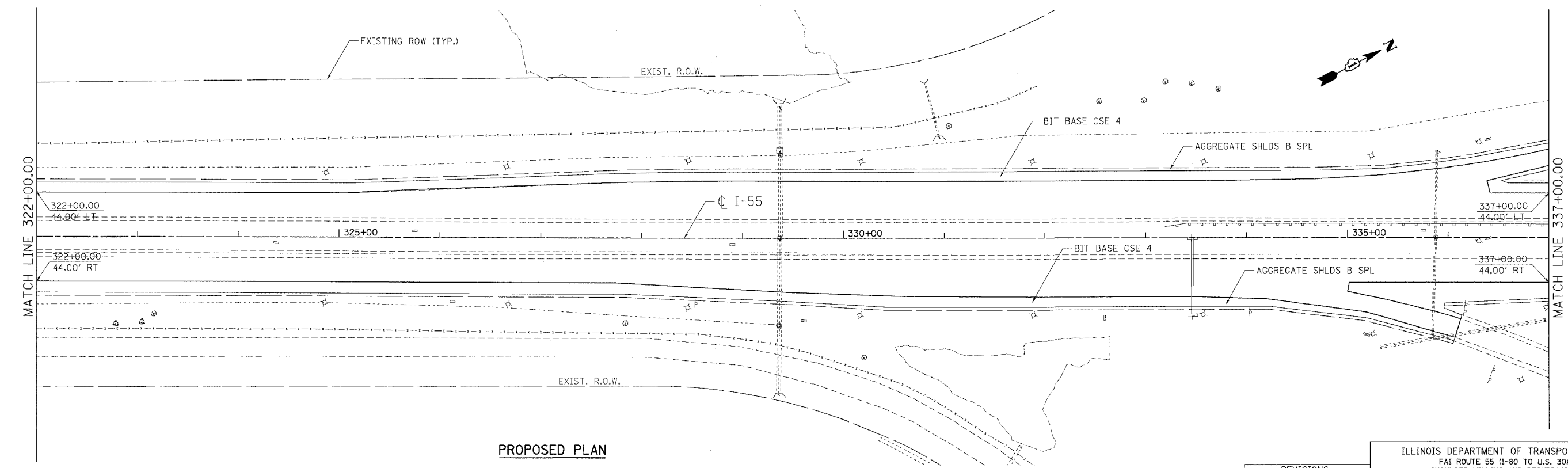

**PROPOSED PLAN**

| REVISIONS |      |
|-----------|------|
| NAME      | DATE |
|           |      |
|           |      |
|           |      |
|           |      |
|           |      |
|           |      |
|           |      |

ILLINOIS DEPARTMENT OF TRANSPORTATION  
 FAI ROUTE 55 (I-80 TO U.S. 30)  
 SHOULDER MILLING AND RESURFACING

**ROADWAY PLAN**  
**FAI 55**  
**STA. 322+00.00 TO STA. 337+00.00**

SCALE: 1"=50'  
 DATE: 03/15/06  
 DRAWN BY: OP  
 CHECKED BY: DDH

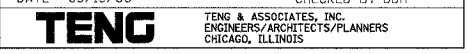

FILE DATE = 03/15/06  
 FILE NAME = 60A68.RVD  
 PLOT SCALE = 1"=50'  
 USER NAME = DDH  
 3-13-2006 14:49:21  
 C:\DOCUMENTS\238152\1\CIVIL\WORK\PLANS\60A68.DWG