

F.A.I. RTE.	SECTION	COUNTY	TOTAL SHEETS	SHEET NO.
55	99(1&2) I-10	WILL	52	4
STA. 240+90.04		TO STA. 586+56.06		
FED. ROAD DIST. NO.		ILLINOIS FED. AID PROJECT		

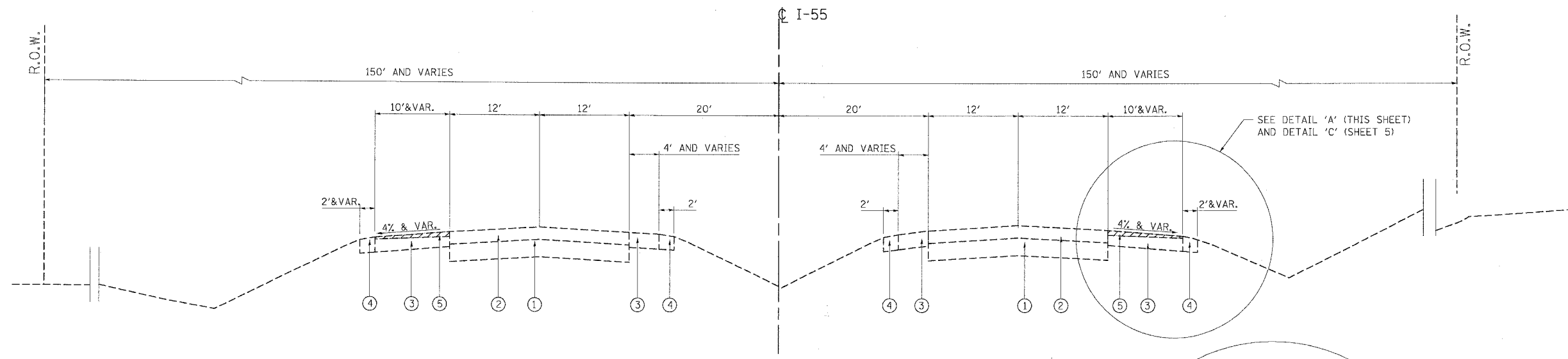

EXISTING ROADWAY TYPICAL SECTION

STA. 240+90.04 TO STA. 586+56.06

EXISTING LEGEND

- ① P.C.C. PAVEMENT
- ② BITUMINOUS RESURFACING
- ③ BITUMINOUS SHOULDER (SEE NOTE 2)
- ④ AGGREGATE SHOULDER
- ⑤ BITUMINOUS SURFACE REMOVAL (VARIABLE DEPTH)

PROPOSED LEGEND

- (A) BITUMINOUS BASE COURSE, 4"
- (B) AGGREGATE SHOULDERS, TYPE B (SPECIAL)
- (C) CLASS D PATCHES, 6" (SEE NOTE 1)

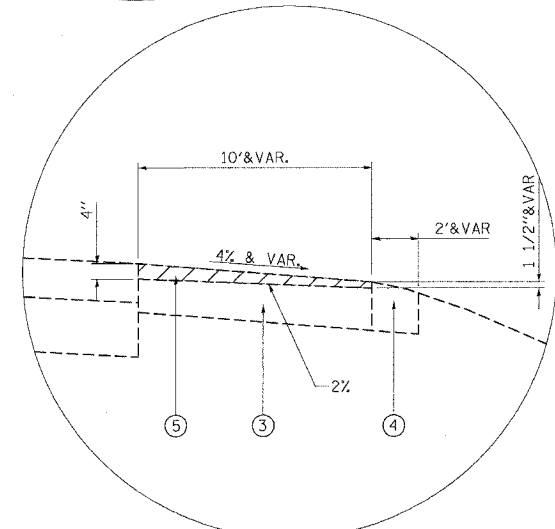

DETAIL 'A'

SEE NOTE 3

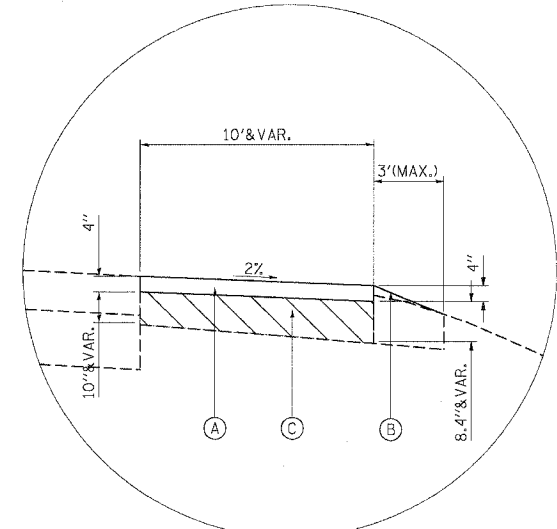

DETAIL 'B'

SEE NOTE 3

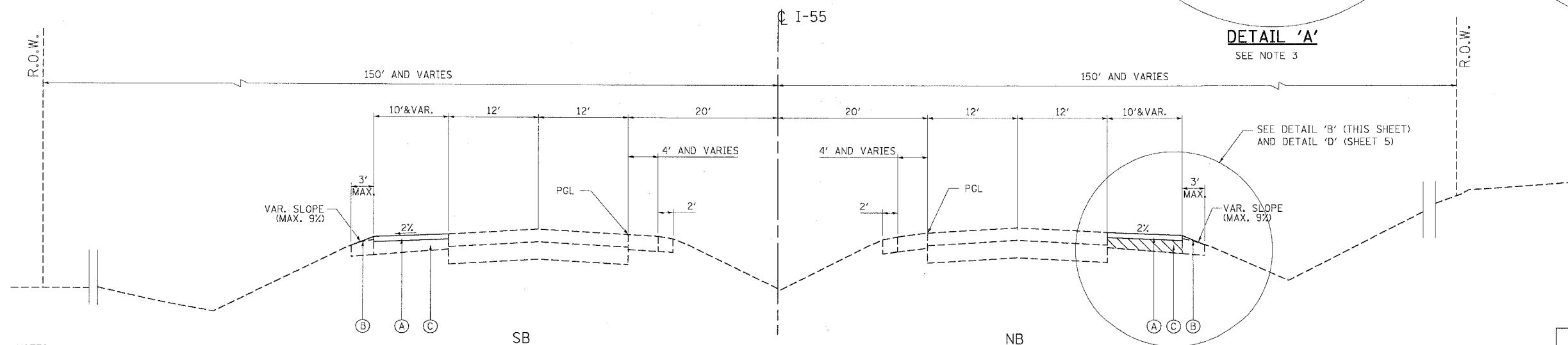

PROPOSED ROADWAY TYPICAL SECTION

STA. 240+90.04 TO STA. 586+56.06

NOTES:

1. CLASS D PATCHES SHALL BE AT LOCATIONS AS DIRECTED BY THE ENGINEER. THE DEPTH OF THE PATCH SHALL BE MEASURED FOR PAYMENT AS SPECIFIED IN THE SPECIAL PROVISIONS.
2. THE EXISTING SHOULDER THICKNESS AVERAGES 10" BASED ON CORES OF THE EXISTING SHOULDER.
3. DETAILS A, B, C AND D ARE DEPICTED FOR THE NB DIRECTION. THE MIRROR IMAGES OF THESE DETAILS APPLY IN THE SB DIRECTION

REVISIONS	
NAME	DATE

ILLINOIS DEPARTMENT OF TRANSPORTATION
FAI ROUTE 55 (I-80 TO U.S. 30)
SHOULDER MILLING AND RESURFACING

TYPICAL SECTIONS
STA. 240+90.04 TO STA. 586+56.06

SCALE: N.T.S. DRAWN BY OP
DATE 03/15/06 CHECKED BY DDH



PLOT DATE = 03/15/06
 FILE NAME = 031506.DWG
 PLOT SCALE = 1/8"=1'-0"
 USER NAME = JGARCIA