

-CABLE INSTALLATION MIN. DEPTH
EXCEPT FOR UNDER PAVEMENT BOTTOM AND
DITCH FLOW LINE=48"
-CABLE INSTALLATION MIN. DEPTH
UNDER PAVEMENT BOTTOM AND
DITCH FLOW LINE=60"

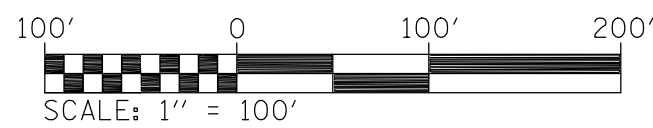
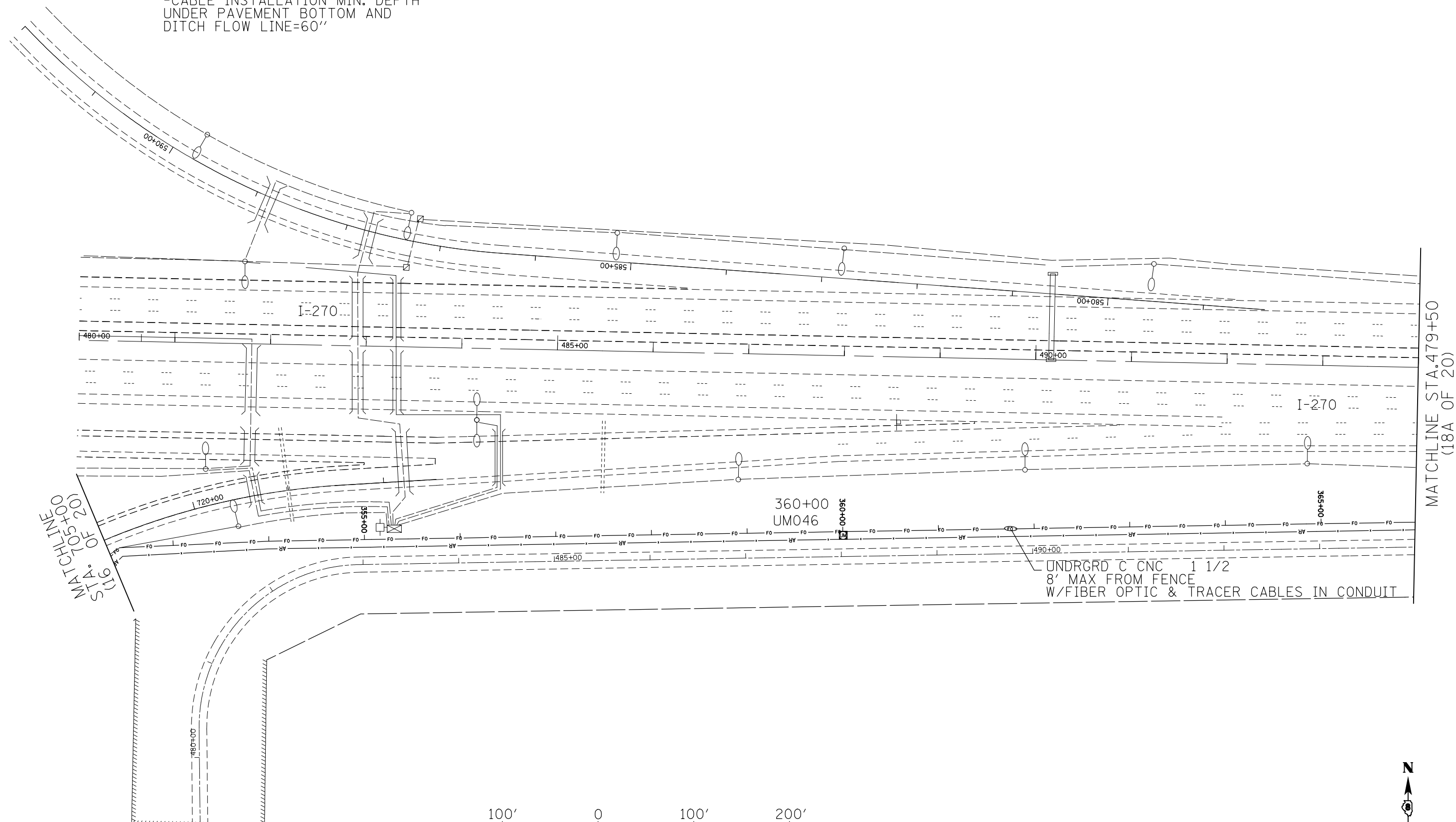

FILE NAME =	USER NAME = prestonme	DESIGNED -	REVISED -
et:\pw\work\p\dot\prestonme\d0298000\d076f77-sht-ITS.dgn		DRAWN -	REVISED -
	PLOT SCALE = 100.0000' / 1in.	CHECKED -	REVISED -
	PLOT DATE = 3/21/2013	DATE -	REVISED -

**STATE OF ILLINOIS
DEPARTMENT OF TRANSPORTATION**

**PLAN SHEET
I-255 RAMP 7 STA. 719+00 TO I-270 STA. 494+00**

SCALE: SHEET NO. OF SHEETS STA. TO STA.

*FAI 270/FAI 255/FAI 55/70 17 OF 20

F.A.I. RTE.	SECTION	COUNTY	TOTAL SHEETS	SHEET NO.
*	DIST 8 ITS 2013-1	MADISON	27	23
CONTRACT NO. 76F77				
FED. ROAD DIST. NO. ILLINOIS FED. AID PROJECT				