

-CABLE INSTALLATION MIN. DEPTH EXCEPT FOR UNDER PAVEMENT BOTTOM AND DITCH FLOW LINE=48"
 -CABLE INSTALLATION MIN. DEPTH UNDER PAVEMENT BOTTOM AND DITCH FLOW LINE=60"

UNDRGRD C CNC 1 1/2
 8' MAX FROM FENCE
 W/FIBER OPTIC & TRACER CABLES IN CONDUIT

UNDRGRD C CNC 1 1/2
 8' MAX FROM FENCE
 W/FIBER OPTIC & TRACER CABLES IN CONDUIT

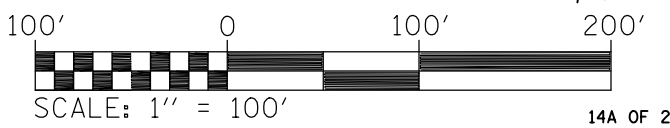
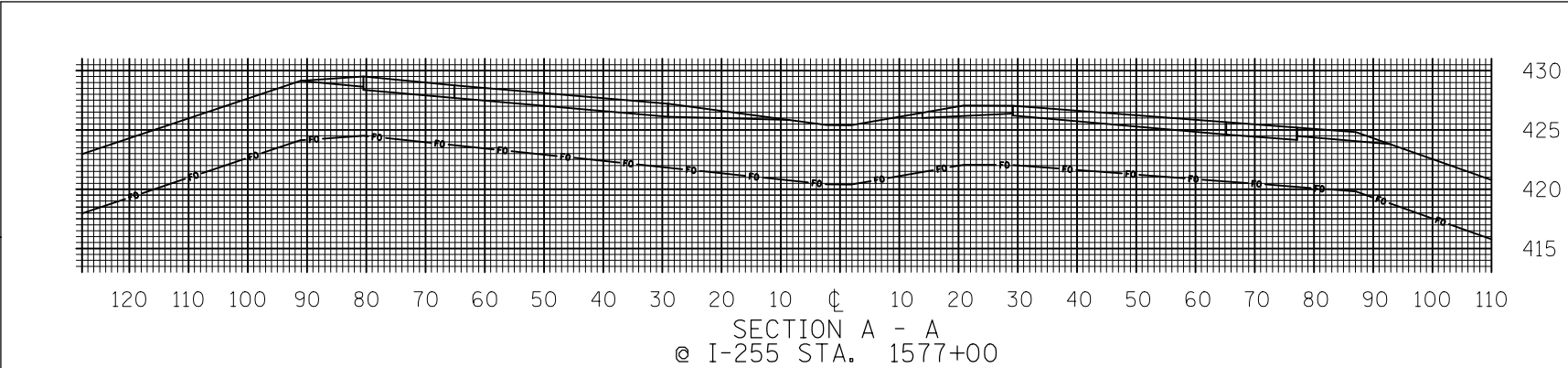
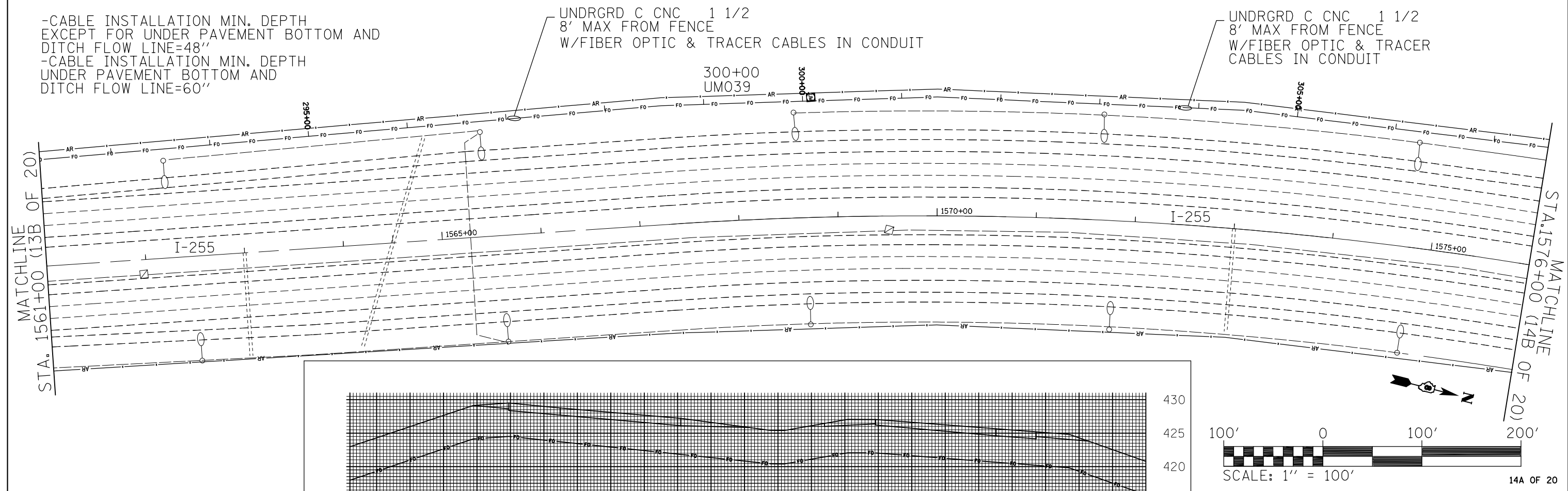

14A OF 20

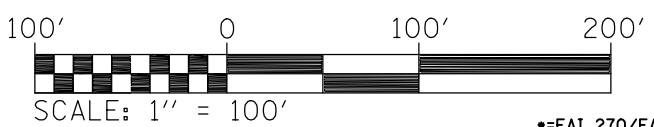
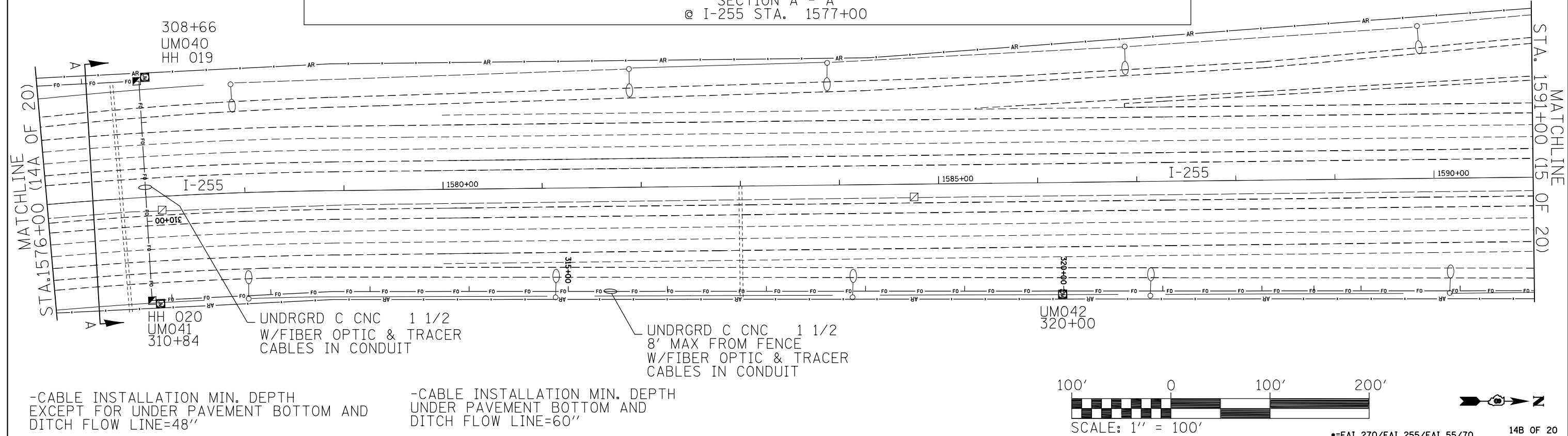

14B OF 20

-CABLE INSTALLATION MIN. DEPTH EXCEPT FOR UNDER PAVEMENT BOTTOM AND DITCH FLOW LINE=48"

-CABLE INSTALLATION MIN. DEPTH UNDER PAVEMENT BOTTOM AND DITCH FLOW LINE=60"

FILE NAME =	USER NAME = prestonme
et:\pwork\p\dot\prestonme\d0298000\d076f77-sht-ITS.dgn	
PLOT SCALE = 100.0000' / 1in.	
PLOT DATE = 3/21/2013	

DESIGNED -	REVISED -
DRAWN -	REVISED -
CHECKED -	REVISED -
DATE -	REVISED -

STATE OF ILLINOIS
 DEPARTMENT OF TRANSPORTATION

PLAN SHEET			
I-255 STA. 1561+00 TO STA. 1576+00			
I-255 STA. 1576+00 TO STA. 1591+00			
SCALE:	SHEET NO.	OF SHEETS	STA. TO STA.

*FAI 270/FAI 255/FAI 55/70			
F.A.I. RTE.	SECTION	COUNTY	TOTAL SHEETS
•	DIST 8 ITS 2013-1	MADISON	27
CONTRACT NO. 76F77			
FED. ROAD DIST. NO. ILLINOIS FED. AID PROJECT			