

-CABLE INSTALLATION MIN. DEPTH
EXCEPT FOR UNDER PAVEMENT BOTTOM AND
DITCH FLOW LINE=48"

-CABLE INSTALLATION MIN. DEPTH
UNDER PAVEMENT BOTTOM AND
DITCH FLOW LINE=60"

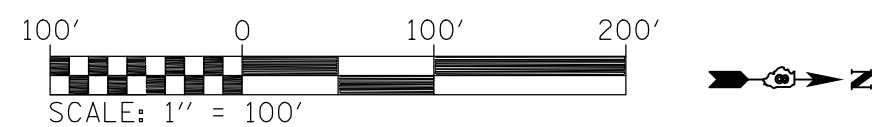
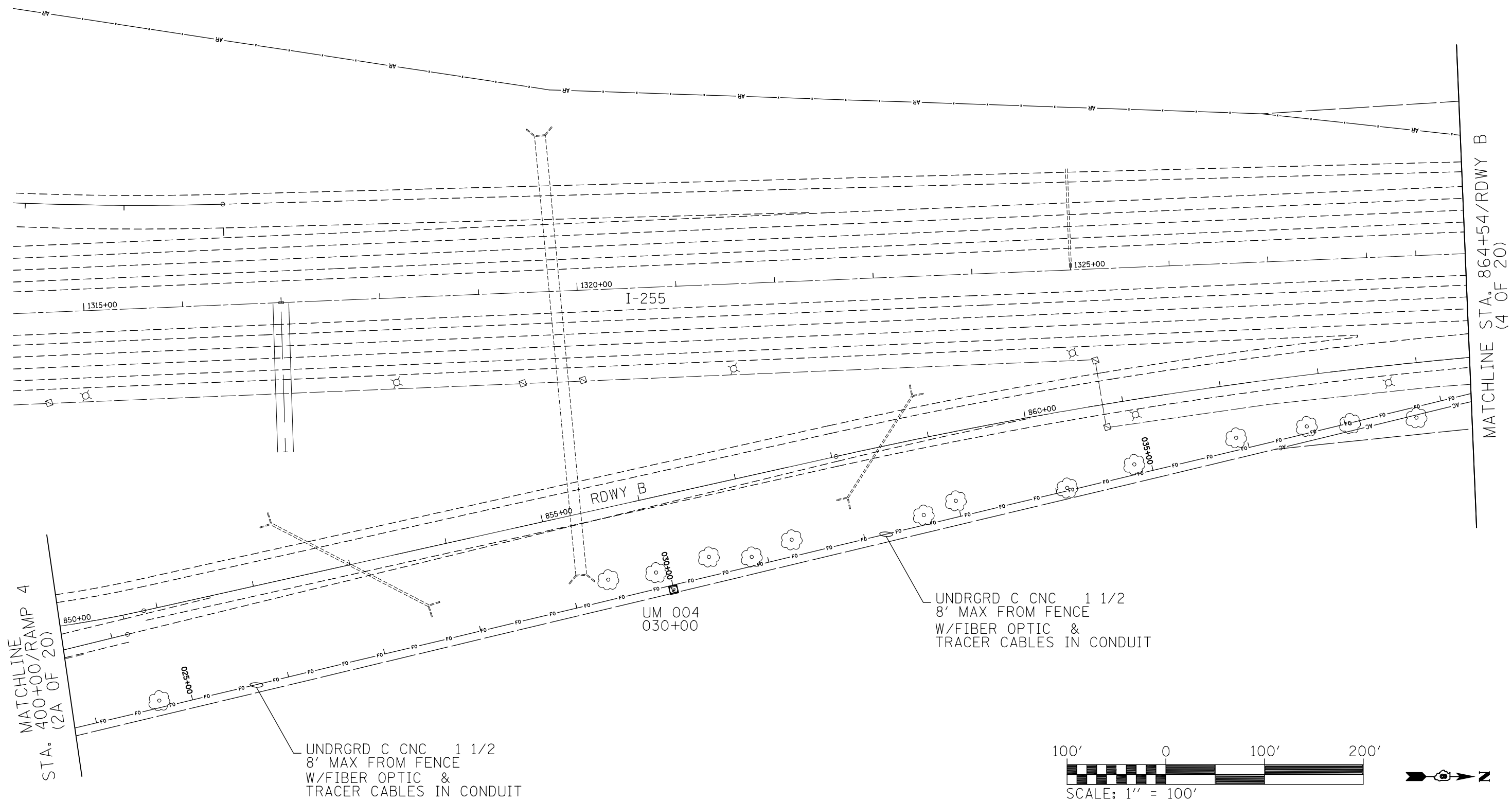

MATCHLINE
400+00/RAMP 4
(2A OF 20)

MATCHLINE STA. 864+54/RDWY B
(4 OF 20)

UNDRGRD C CNC 1 1/2
8' MAX FROM FENCE
W/FIBER OPTIC &
TRACER CABLES IN CONDUIT

UNDRGRD C CNC 1 1/2
8' MAX FROM FENCE
W/FIBER OPTIC &
TRACER CABLES IN CONDUIT

**STATE OF ILLINOIS
DEPARTMENT OF TRANSPORTATION**

**PLAN SHEET
I-255 STA. 400+00/RAMP 4 TO STA. 864+54/RDWY B**

•=FAI 270/FAI 255/FAI 55/70 3 OF 20

FILE NAME =	USER NAME = prestonme	DESIGNED -	REVISED -
et:\pwork\pwork\prestonme\d0298000\d076f77-sht-ITS.dgn		DRAWN -	REVISED -
	PLOT SCALE = 100.0000' / in.	CHECKED -	REVISED -
	PLOT DATE = 3/21/2013	DATE -	REVISED -

F.A.I. RTE.	SECTION	COUNTY	TOTAL SHEETS	SHEET NO.
•	DIST 8 ITS 2013-1	MADISON	27	9
CONTRACT NO. 76F77				
FED. ROAD DIST. NO. ILLINOIS FED. AID PROJECT				

SCALE:	SHEET NO.	OF	SHEETS	STA.	TO	STA.
--------	-----------	----	--------	------	----	------