

- Notes:
- 1.) See sheet B17 for Detail A and View B-B.
 - 2.) Approach slab and parapet concrete shall be paid for as Concrete Superstructure.
 - 3.) Approach footing concrete shall be paid for as Concrete Structures.
 - 4.) Reinforcement shall be paid for as Reinforcement Bars, Epoxy Coated.
 - 5.) For v(E) bar details, see sheet B14 and B15.
 - 6.) The approach footing maximum applied service bearing pressure (Qmax) = 2.0 ksf.
 - 7.) For bar splicer details, see sheet B36.
 - 8.) Cost of excavation for approach footing included with Concrete Structures.
 - 9.) For Porous Granular Embankment (Special) and drainage treatment details, see sheet B2.
 - 10.) For additional parapet details, see sheet B14.

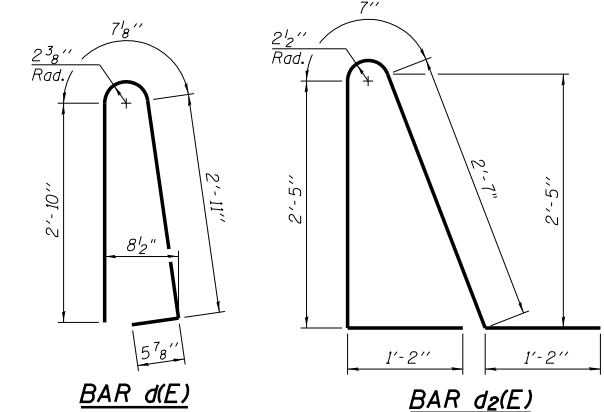
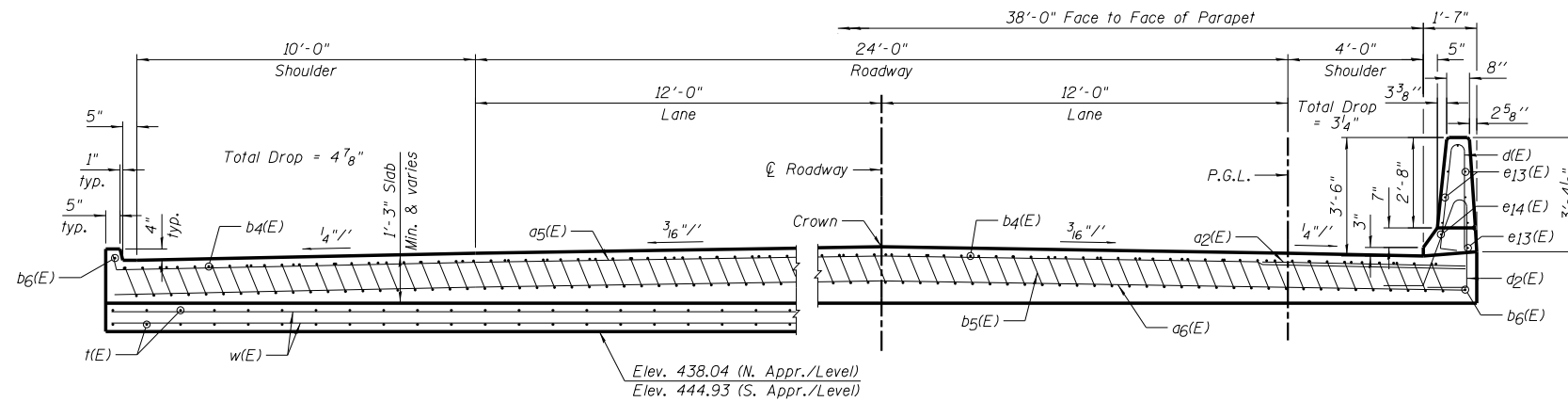

AT APPROACH FOOTING

NEAR ABUTMENT

* Tilt #9 b5(E) bars as required to maintain clearance.
 *** Cost included with Concrete Superstructure.

SECTION D-D

(See Plans for dimensions not shown)

TWO APPROACHES
 BILL OF MATERIAL

Bar	No.	Size	Length	Shape
a2(E)	48	#6	6'-6"	—
a5(E)	50	#4	42'-7"	—
a6(E)	92	#5	42'-0"	—
b4(E)	64	#4	29'-8"	—
b5(E)	190	#9	29'-9"	—
b6(E)	8	#4	14'-8"	—
d(E)	68	#5	6'-10"	U
d2(E)	68	#5	7'-11"	U
e13(E)	32	#4	14'-8"	—
e14(E)	4	#8	14'-8"	—
t(E)	160	#4	10'-3"	—
w(E)	80	#5	42'-0"	—
Concrete Superstructure		Cu. Yd.	127.0	
Concrete Structures		Cu. Yd.	26.2	
Reinforcement Bars, Epoxy Coated		Pound	32,600	

