

STATE OF ILLINOIS
 DEPARTMENT OF TRANSPORTATION
 DIVISION OF HIGHWAYS

**PROPOSED
 HIGHWAY PLANS**

FAP ROUTE 325 (IL 16)
 SECTION (11B-1)BR
 PROJECT F-0325(059)
 BRIDGE REPAIR
 SHELBY COUNTY

C-97-057-13

F.A.P. RTE.	SECTION	COUNTY	TOTAL SHEETS	SHEET NO.
325	(11B-1)BR	SHELBY	32	1
		ILLINOIS	CONTRACT NO. 74615	

D-97-014-13

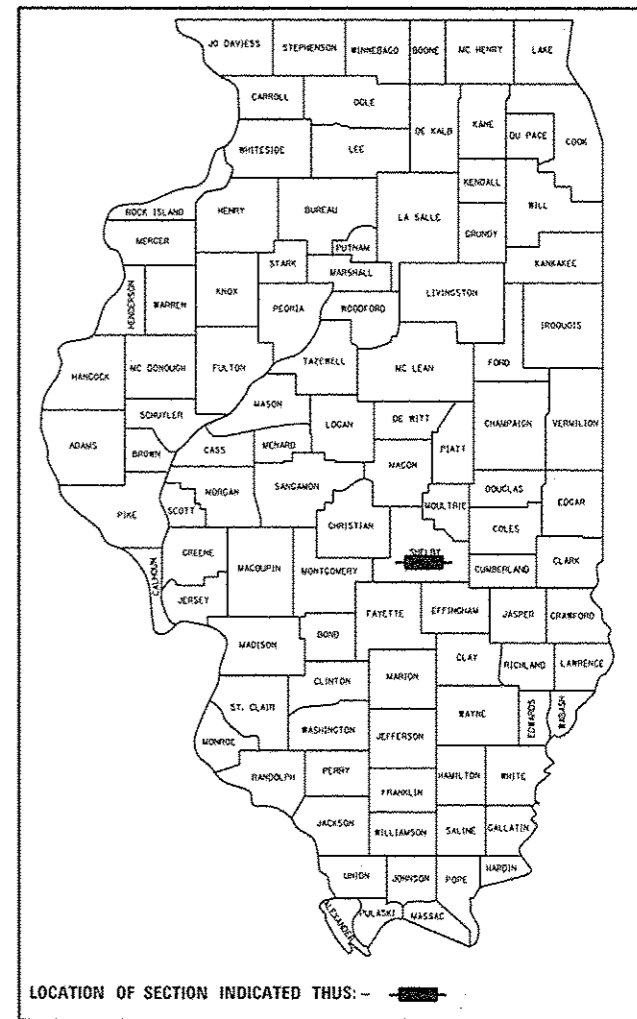

FOR INDEX OF SHEETS, SEE SHEET NO. 2

ADT (2009) = 4,755

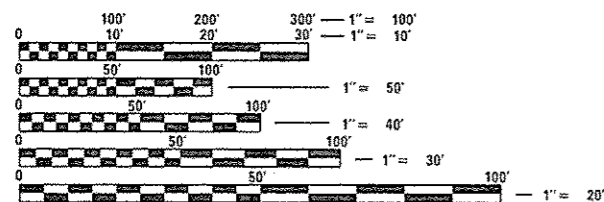

FULL SIZE PLANS HAVE BEEN PREPARED USING STANDARD ENGINEERING SCALES. REDUCED SIZED PLANS WILL NOT CONFORM TO STANDARD SCALES. IN MAKING MEASUREMENTS ON REDUCED PLANS, THE ABOVE SCALES MAY BE USED.

J.U.L.I.E.
 JOINT UTILITY LOCATION INFORMATION FOR EXCAVATION
 1-800-892-0123
 OR 811

S. N. 087-0020
 STA 108+77.95

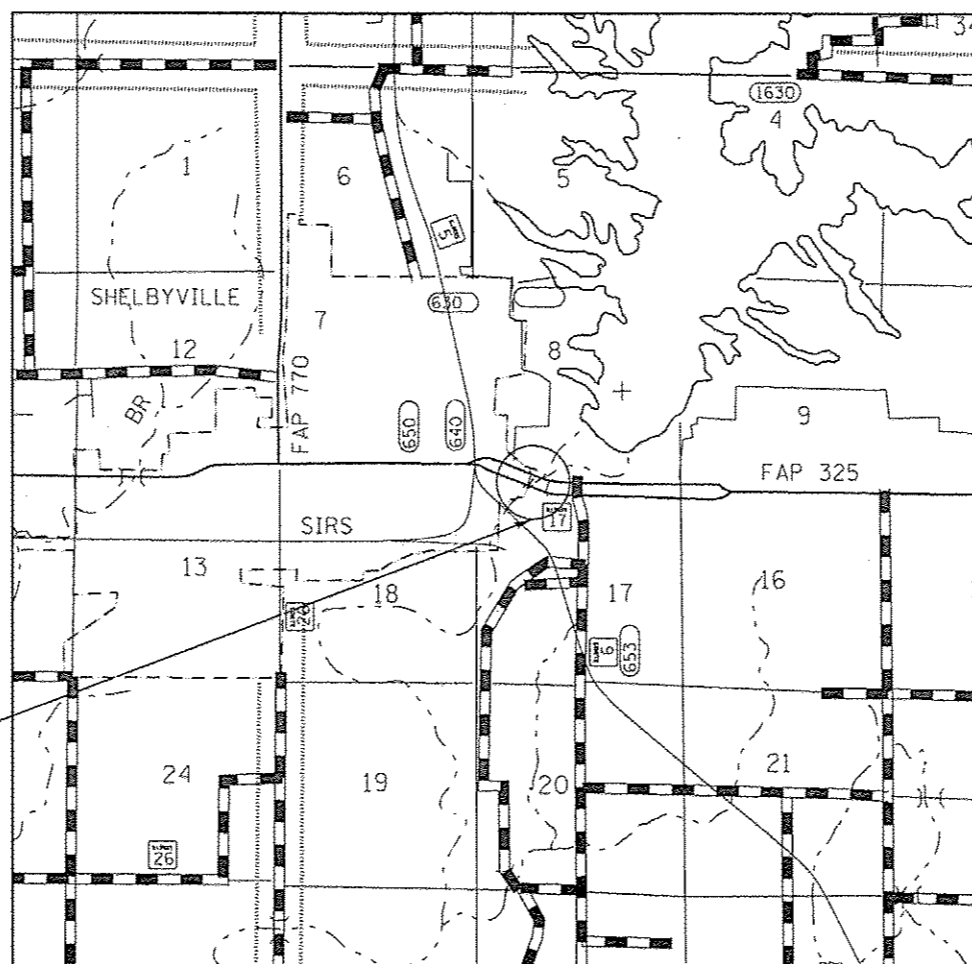

PROJECT ENGINEER: MARK DAUGHERTY
 PROJECT MANAGER: BRIAN BIERMAN

CONTRACT NO. 74615

STATE OF ILLINOIS
 DEPARTMENT OF TRANSPORTATION
 DIVISION OF HIGHWAYS

SUBMITTED March 28 2013
Roger L. Driskell
 DEPUTY DIRECTOR OF HIGHWAYS, REGION ENGINEER

April 26 2013
John D. Baranecchi, P.E.
 ENGINEER OF DESIGN AND ENVIRONMENT

April 26 2013
Cher Osman, P.E.
 DIRECTOR OF HIGHWAYS, CHIEF ENGINEER

**PRINTED BY THE AUTHORITY
 OF THE STATE OF ILLINOIS**