

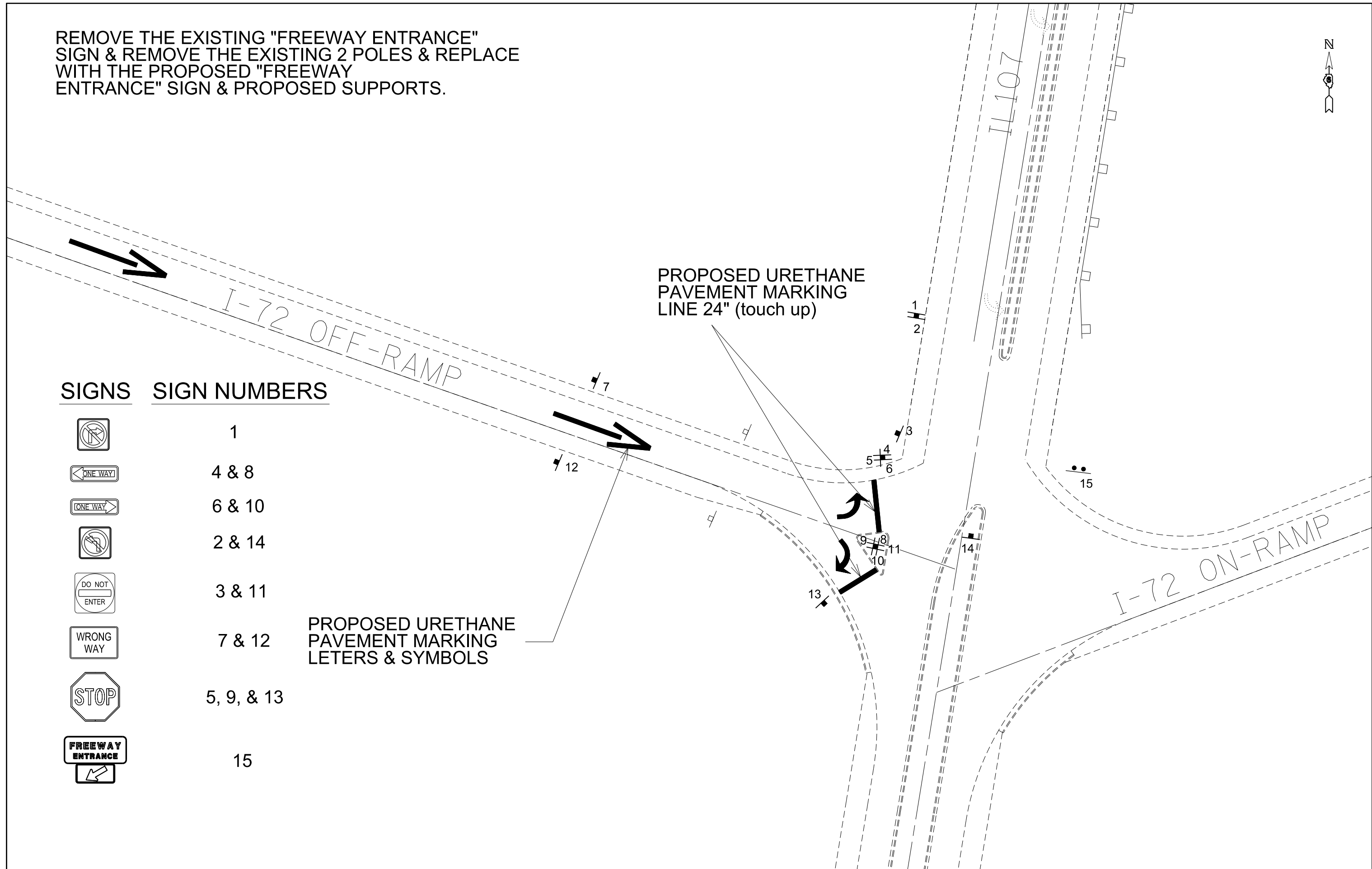







REMOVE THE EXISTING "FREEWAY ENTRANCE" SIGN & REMOVE THE EXISTING 2 POLES & REPLACE WITH THE PROPOSED "FREEWAY ENTRANCE" SIGN & PROPOSED SUPPORTS.

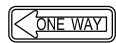
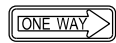

**SIGNS SIGN NUMBERS**

-  1
-  4 & 8
-  6 & 10
-  2 & 14
-  3 & 11
-  7 & 12
-  5, 9, & 13
-  15

PROPOSED URETHANE PAVEMENT MARKING LETTERS & SYMBOLS

PROPOSED URETHANE PAVEMENT MARKING LINE 24" (touch up)

FILE NAME =	USER NAME = sparksgw	DESIGNED -	REVISED -
c:\pwwork\pwwork\sparksgw\10338559\0672009-sht-topo sheets.dgn		DRAWN -	REVISED -
Default	PLOT SCALE = 40.0000' / in.	CHECKED -	REVISED -
	PLOT DATE = Mar-28-2013 03:00:18PM	DATE -	REVISED -

**STATE OF ILLINOIS  
DEPARTMENT OF TRANSPORTATION**

<b>LOCATION 1 EB RAMP</b>			
SCALE:	SHEET	OF SHEETS	STA. TO STA.

F.A. RTE.	SECTION	COUNTY	TOTAL SHEETS	SHEET NO.
	..	.	19	19
			CONTRACT NO. 72G09	
ILLINOIS FED. AID PROJECT				