

**LEGEND**



PERMANENT IMPACTS TO THE WATERS OF THE U.S. = 0.0007 ACRES  
STONE RIPRAP, CLASS A4 (1' THICK) - 2 TONS



TEMPORARY IMPACTS TO THE WATERS OF THE U.S. = 0.009 ACRES

- CP 1 - CUT "X" INTO CENTER OF CONCRETE SPILLWAY  
ELEV = 688.38
- CP 2 - CUT "X" ON TOP OF BARRIER CURB SOUTH OF DRIVEWAY INOT RED LOBSTER  
ELEV = 692.60
- CP 3 - SET REBAR IN NORTH OF CREEK
- BM 1 - "X" AT THE SOUTHWEST FLANGE BOLD  
ELEV = 691.59

NOTE:  
PLACEMENT SHOULD NOT EXCEED  
BOTTOM OF CULVERT OPENING

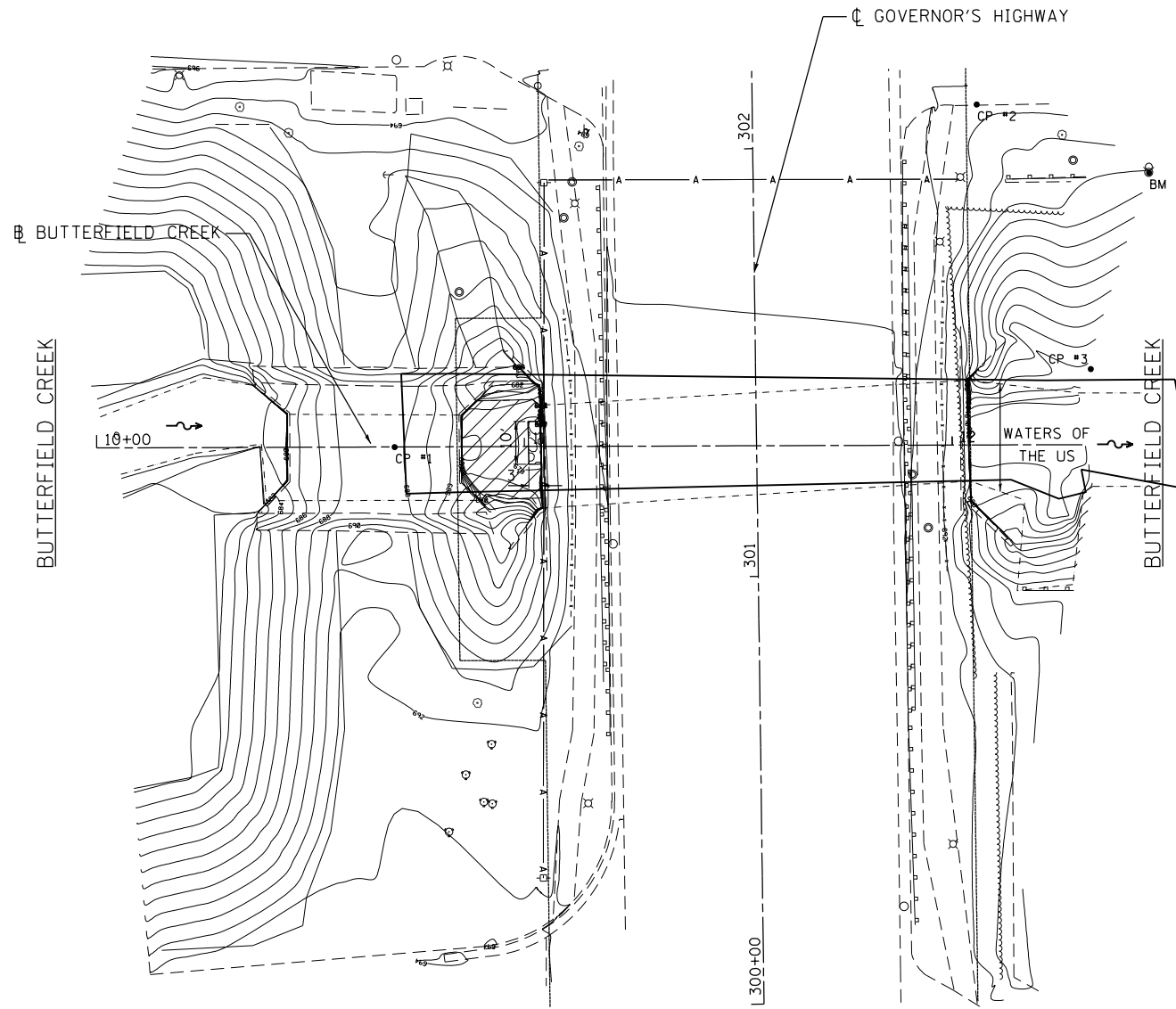

3/12/2013 11:24:33 AM

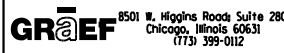

USER NAME = 1485	DESIGNED -	REVISED -
	DRAWN -	REVISED -
PLOT SCALE = 40.0000' / in.	CHECKED -	REVISED -
PLOT DATE = 3/12/2013	DATE - 03/20/2013	REVISED -

**STATE OF ILLINOIS  
DEPARTMENT OF TRANSPORTATION**

**COOK & WILL COUNTY RIP RAP IMPROVEMENTS  
SN 016-2505 GOVERNOR'S HIGHWAY OVER BUTTERFIELD CREEK - EROSION PLAN**

SCALE: 1"=20' SHEET 2 OF 2 SHEETS STA. TO STA.

F.A. RTE.	SECTION	COUNTY	TOTAL SHEETS	SHEET NO.
*	2012-007 I	COOK/WILL	38	15
* VARIOUS ROUTES			CONTRACT NO. 60T53	
ILLINOIS FED. AID PROJECT				