

MATCH LINE STA. 406+00  
SEE DRAWING DE-14

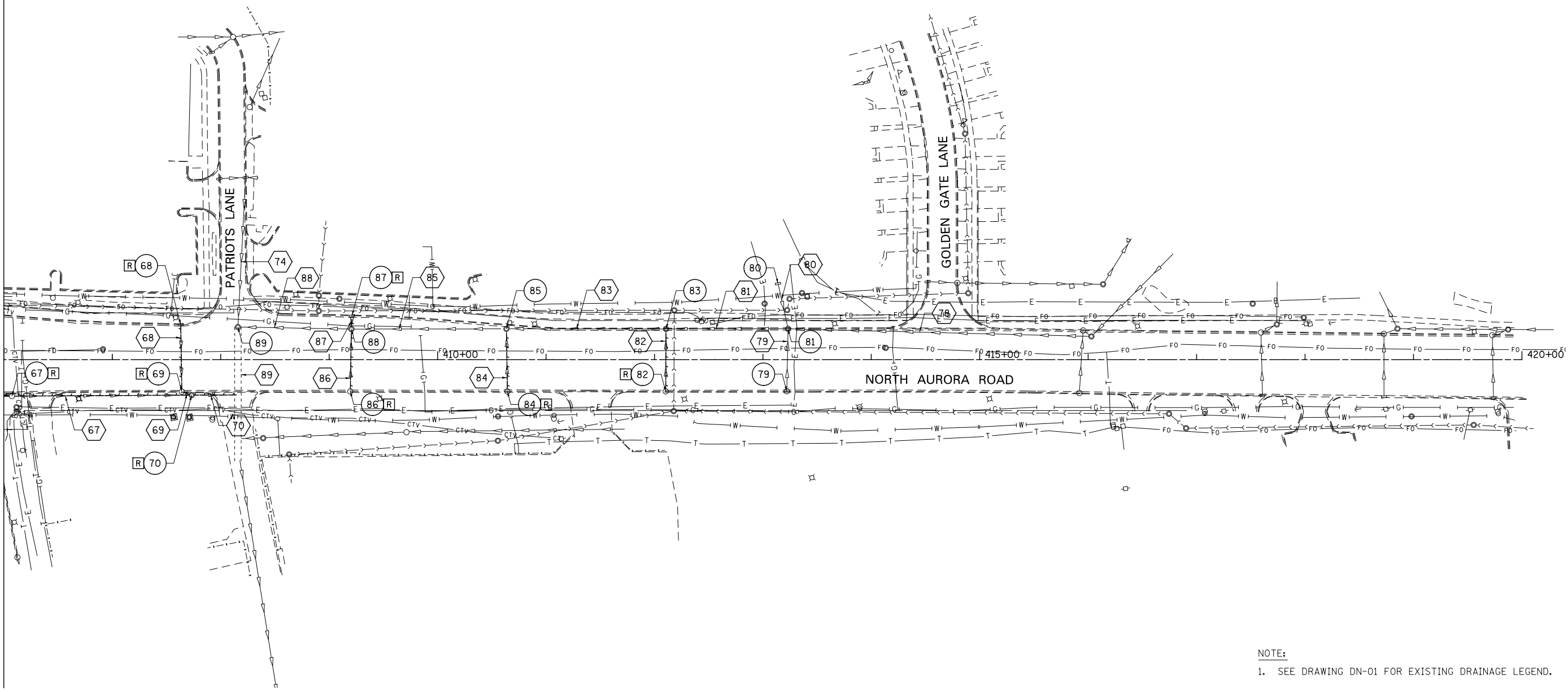

NOTE:  
1. SEE DRAWING DN-01 FOR EXISTING DRAINAGE LEGEND.

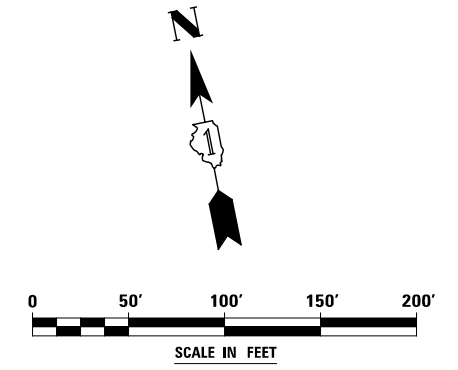

	DESIGNED	PJO	REVISED	-	<b>STATE OF ILLINOIS DEPARTMENT OF TRANSPORTATION</b>	<b>EXISTING DRAINAGE PLAN - NORTH AURORA ROAD</b>			F.A.P. RTE.	SECTION	COUNTY	TOTAL SHEETS	SHEET NO.
	DRAWN	KES	REVISED	-		SCALE: AS SHOWN	SHEET NO. 15 OF 15 SHEETS	STA. 406+00 TO STA. END	338	(112 & 113) WRS-7	DUPAGE	1156	466
	CHECKED	JCM	REVISED	-					<b>DE-15</b>		CONTRACT NO. 60R30		
	DATE	12/14/2012	REVISED	-					ILLINOIS FED. AID PROJECT				