

QUAD CITY INTERNATIONAL AIRPORT  
 RUNWAY 9-27 INLAY, PHASE 1  
 ILL. MLI-3791, QU007  
 SHEET 12 OF 48

TEMPORARY BENCH MARKS		
B.M.	ELEV.	DESCRIPTION
TBM 200	587.10	HUB AT SE COR OF TXY H BORROW AREA, N1742722.2338, E2199623.7550, STATION 107+86.74, LT. 739.58'
TBM K	578.34	TOP OF RCP, S SIDE OF SERVICE RD, N1741508.6290, E2201629.7690, STATION 127+42.16, RT. 424.08'
TBM R	581.52	NE COR CONC BASE ELECT TRAN, S SIDE 9-27, BETWEEN SIGNS [2] - [7] N1741569.4966, E2200420.1701, STATION 115+31.40, RT. 393.12'
TBM T	576.35	CHS. □, SE COR CONC PAD W SIDE GS BLDG, N1741651.7212, E2198675.6748, STATION 97+85.40, RT. 354.03'
TBM U	583.18	CHS. □, HOLD SIGN BASE, NE COR, S SIDE R9, N1741775.92035, E2203365.21359, STATION 144+70.44, RT. 113.99'

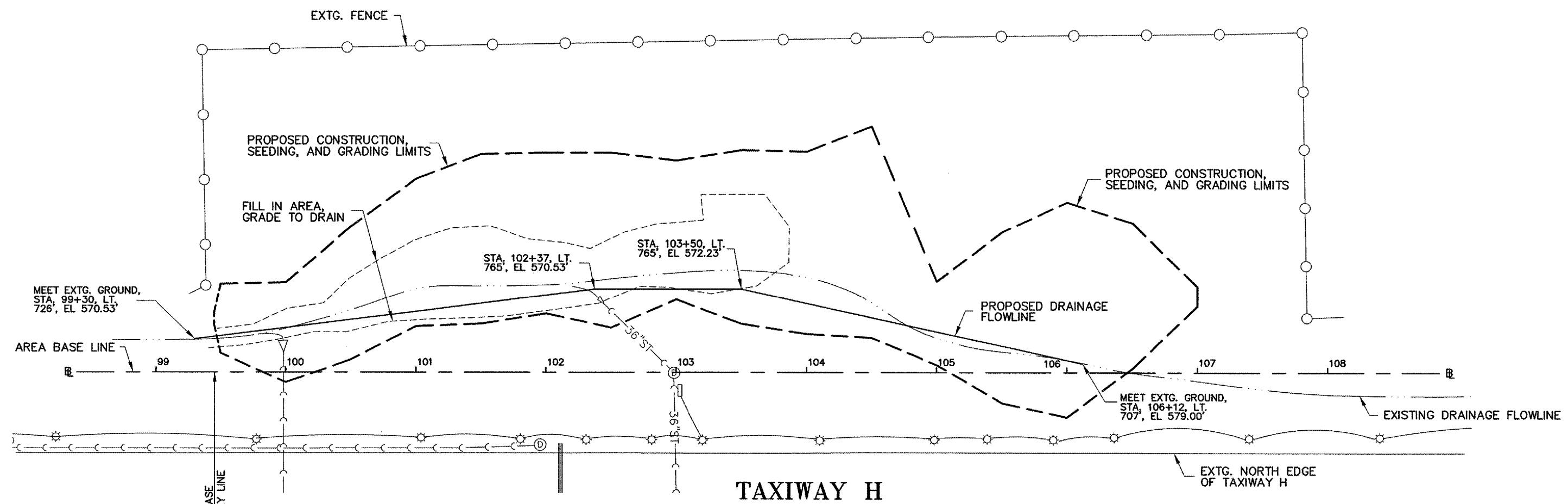
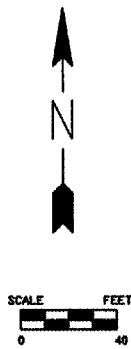

**LEGEND:**

- ⊙ EDGE LIGHT
- ▭ GUIDANCE SIGN
- ELECTRICAL CABLE
- STORM SEWER OR UNDERDRAIN
- ⊞ INLET
- ▽ OUTLET
- ⊙ (D) STORM MANHOLE
- ⊙ (S) SANITARY MANHOLE
- DRAINAGE DITCH
- === CONDUIT OR DUCT BANK

C:\AIRPORT\A07T031-R9 W INLAY\PP.DWG, 4/22/2008 11:53:44 AM, jeffm