

4/23/2008
 K:\Peoria\070610400\Draw\Sheets\019_PLAN_09.dgn

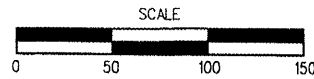

LEGEND

- PROPOSED PAVEMENT EDGE
- - - EXISTING CONTOURS
- - - PROPOSED CONTOURS
- X PROPOSED 10' FENCE
- [Hatched Box] TEMPORARY STRAW BALE DITCH CHECK
- [Square Box] TEMPORARY INLET EROSION PROTECTION
- PROPOSED SILT FENCE
- PROPOSED REINFORCED CONCRETE PIPE
- T EXISTING TELEPHONE
- G EXISTING GAS
- E EXISTING UNDERGROUND ELECTRIC
- W EXISTING WATER
- S EXISTING SANITARY
- SS EXISTING STORM SEWER
- [Square Box] PROPOSED INLET
- [Circle Box] EXISTING INLET

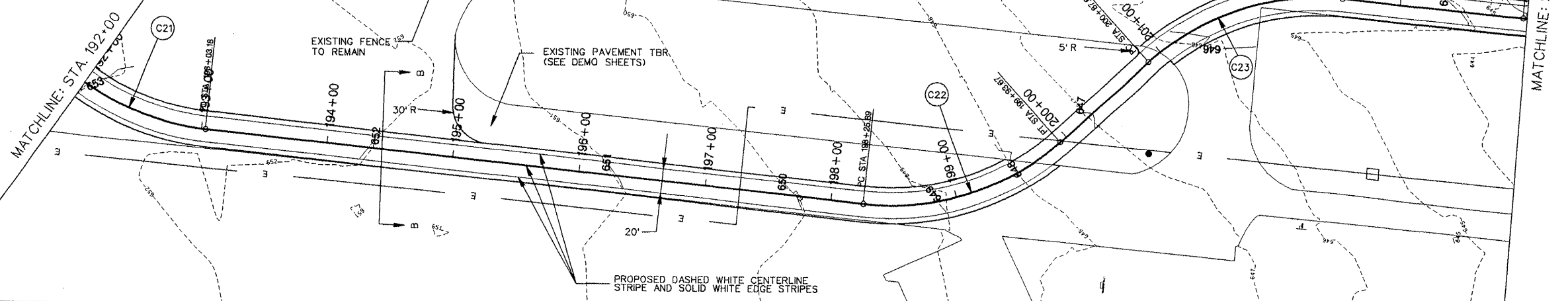

PE086

REVISIONS		
NUMBER	BY	DATE

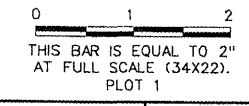

G R E A T E R

Peoria REGIONAL Airport

CONSTRUCT NEW PERIMETER ROAD AND PERIMETER FENCE - PROJECT 1

CMT
 CRAWFORD, MURPHY & TILLY, INC.
 CONSULTING ENGINEERS
© Copyright CMT, Inc.

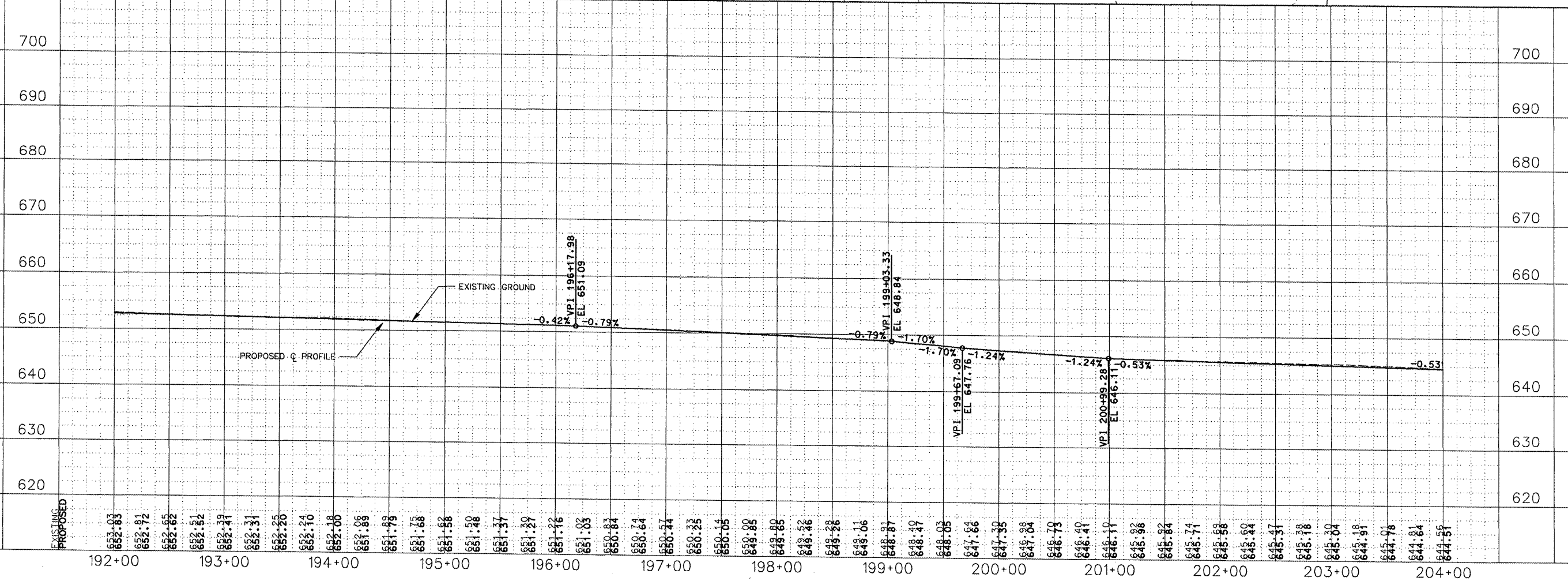

IL PROJECT: PIA-3343
 AIP PROJ: 3-17-0080-XX

FILE: ...Draw\Sheets\019_PLAN_09.dgn

DESIGN BY: TWM, RBL

DRAWN BY: CAG

CHECKED BY: RBL

APPROVED BY: CET

DATE: APRIL 24, 2008

JOB No: 0706104

PLAN AND PROFILE
 SHEET 9 OF 10
 SHEET 19 OF 140 SHEETS