

GENERAL NOTES

- 1.) ALL RUNWAYS, TAXIWAYS AND APRONS SHALL BE KEPT OPEN TO AIRCRAFT TRAFFIC DURING CONSTRUCTION EXCEPT AS NOTED ON THE CONSTRUCTION ACTIVITY PLAN.
- 2.) ALL CONSTRUCTION TRAFFIC OPERATING ON OR CROSSING RUNWAYS, TAXIWAYS AND APRONS OPEN TO AIRCRAFT TRAFFIC SHALL BE UNDER CONTROL BY A FLAGMAN IN RADIO CONTACT WITH FAA AIR TRAFFIC CONTROL TOWER PERSONNEL AT ALL TIMES.
THE CONTRACTOR SHALL PROVIDE HIS OWN RADIOS AND FLAGMEN. ALL VEHICLES SHALL HAVE ORANGE AND WHITE AVIATION FLAGS.
- 3.) REFER TO THE CONSTRUCTION ACTIVITY PLAN AND THE SPECIFICATIONS FOR ADDITIONAL REQUIREMENTS CONCERNING COORDINATION OF CONSTRUCTION ACTIVITIES.
- 4.) WHEN CONFLICTS ARISE BETWEEN CONSTRUCTION ACTIVITIES AND AIRCRAFT OPERATIONS AND SAFETY, AIRCRAFT OPERATIONS AND SAFETY SHALL TAKE PRECEDENCE AND SHALL GOVERN. FINAL AUTHORITY IN THE APPROVAL OF CONSTRUCTION SEQUENCING LIES WITH THE AIRPORT DIRECTOR.
- 5.) THE CONTRACTOR WILL BE PERMITTED TO STORE EQUIPMENT AND MATERIALS ONLY AT THE LOCATIONS SHOWN.
- 6.) BROKEN CONCRETE, BROKEN ASPHALT & OTHER MISCELLANEOUS DEBRIS SHALL BE DISPOSED OF BY THE CONTRACTOR OFF OF AIRPORT PROPERTY.
- 7.) VEHICLES AND EQUIPMENT SHALL NOT BE ALLOWED WITHIN AREAS 100' OF AN ACTIVE TAXIWAY CENTERLINE AND 200' OF AN ACTIVE RUNWAY CENTERLINE.
- 8.) ALL PAVEMENTS, DRIVES OR ANY OTHER AREAS UTILIZED BY THE CONTRACTOR FOR HAUL ROADS OR STORAGE AREAS SHALL BE MAINTAINED AND REPAIRED IN KIND BY THE CONTRACTOR TO THE SATISFACTION OF THE ENGINEER AND AIRPORT DIRECTOR. NO ADDITIONAL COMPENSATION SHALL BE MADE TO THE CONTRACTOR FOR THIS WORK.
- 9.) EXISTING TURF AREAS DISTURBED BY THE CONTRACTOR'S OPERATIONS SHALL BE RESTORED BY HIM AT HIS EXPENSE TO THE SATISFACTION OF THE ENGINEER AND THE AIRPORT DIRECTOR.
- 10.) THE CONTRACTOR SHALL THOROUGHLY CLEAN ALL CONSTRUCTION AREAS WHICH WILL BE OPENED TO AIR TRAFFIC TO THE SATISFACTION OF THE ENGINEER. A POWER BROOM AND OPERATOR SHALL BE ON SITE AT ALL TIMES WHEN ACTIVE PAVEMENTS ARE UTILIZED.
- 11.) THE LOCATION OF UNDERGROUND UTILITIES AS INDICATED ON THE PLANS HAS BEEN OBTAINED FROM EXISTING RECORDS. NEITHER THE OWNER NOR THE ENGINEER ASSUMES ANY RESPONSIBILITY WHATSOEVER IN RESPECT TO THE ACCURACY, COMPLETENESS, OR SUFFICIENCY OF THE INFORMATION. THERE IS NO GUARANTEE, EITHER EXPRESSED OR IMPLIED, THAT THE LOCATIONS, SIZE AND TYPE OF MATERIAL OF EXISTING UNDERGROUND UTILITIES INDICATED ARE REPRESENTATIVE OF THOSE TO BE ENCOUNTERED IN THE CONSTRUCTION.

IT SHALL BE THE CONTRACTOR'S RESPONSIBILITY TO DETERMINE THE ACTUAL LOCATION OF ALL SUCH UTILITIES, INCLUDING SERVICE CONNECTIONS TO UNDERGROUND UTILITIES AND F.A.A. UTILITIES PRIOR TO CONSTRUCTION. THE CONTRACTOR SHALL NOTIFY THE UTILITY COMPANY AND F.A.A. OF HIS OPERATIONAL PLANS. THE CONTRACTOR SHALL MAKE ARRANGEMENTS FOR DETAILED INFORMATION AND ASSISTANCE IN LOCATING UTILITIES. IN THE EVENT AN UNEXPECTED UTILITY INTERFERENCE IS ENCOUNTERED DURING CONSTRUCTION, THE CONTRACTOR SHALL IMMEDIATELY NOTIFY THE UTILITY COMPANY, F.A.A., THE OWNER AND THE ENGINEER. ANY SUCH MAINS AND/OR SERVICES DISTURBED BY THE CONTRACTOR'S OPERATIONS SHALL BE RESTORED IMMEDIATELY AT HIS EXPENSE TO THE SATISFACTION OF THE OWNER AND THE ENGINEER.
- 12.) CONTRACTOR'S ACCESS SHALL BE AS FOLLOWS:
 - A) CONTRACTOR ACCESS STAGING AND STORAGE AREAS SHALL BE AS SHOWN ON THIS SHEET. THE CONTRACTOR SHALL BE RESPONSIBLE FOR COORDINATING ALL ACCESS ROADS WITH THE APPROPRIATE AGENCY RESPONSIBLE FOR THE ROADWAYS.
 - B) CONTRACTOR'S PERSONNEL SHALL PARK IN AREA SHOWN FOR CONTRACTOR'S PERSONNEL PARKING. ALL PERSONNEL WHO WILL BE ON THE AIRFIELD WILL BE REQUIRED TO SUBMIT FOR A FIVE YEAR BACKGROUND CHECK AND FAA SECURITY BADGE PROCESS AS DIRECTED BY AIRPORT DIRECTOR.
 - C) DURING ADVERSE WEATHER THE CONTRACTOR SHALL MAKE PROVISIONS FOR ACCESS TO THE WORK AT NO ADDITIONAL COST TO THE CONTRACT. NO EXTENSION OF CONTRACT TIME WILL BE CONSIDERED FOR DELAYS DUE TO LACK OF ADEQUATE ACCESS TO THE WORK.
 - D) IF THE CONTRACTOR CHOOSES TO LEAVE THE GATE OPEN DURING WORKING HOURS, HE SHALL POST A COMPETENT SECURITY GUARD TO PREVENT UNAUTHORIZED ENTRIES. THE CONTRACTOR SHALL REPLACE ANY UNSATISFACTORY SECURITY GUARDS IF SO DIRECTED BY THE AIRPORT.
 - E) A LIST OF AUTHORIZED PERSONNEL PERMITTED TO USE THE ACCESS GATE SHALL BE PROVIDED BY THE CONTRACTOR TO THE ENGINEER.
 - F) THE CONTRACTOR SHALL PROVIDE A SIGN AT THE ACCESS GATE SAYING "AUTHORIZED PERSONNEL ONLY".
 - G) THE CONTRACTOR SHALL VERIFY THAT THE GATE IS CLOSED AND LOCKED UPON LEAVING THE SITE. KEY SHALL BE PROVIDED TO AIRPORT SECURITY OFFICE.
 - H) THROUGHOUT THE DURATION OF THE CONTRACT, ANY DAMAGE TO THE ACCESS RD., ACCESS GATE OR FENCING ADJACENT TO THE PROJECT SHALL BE REPAIRED BY THE CONTRACTOR TO THE SATISFACTION OF THE OWNER.
 - I) ALL COSTS RELATING TO CONTRACTOR'S ACCESS AND SECURITY SHALL BE THE RESPONSIBILITY OF THE CONTRACTOR.
 - J) THE CONTRACTOR SHALL STORE EQUIPMENT AND MATERIALS IN SUCH A WAY AS TO NOT PENETRATE THE PART 77 SURFACES.
- 13.) THE MAXIMUM CONSTRUCTION EQUIPMENT HEIGHT IS 25'.

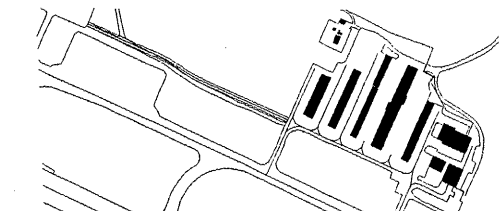
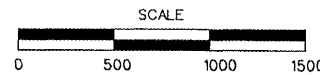

CONTROL POINT DATA

POINT NO.	NORTHING	EASTING	ELEVATION	DESCRIPTION
1	1,456,756.76	2,430,101.04	650.78	IRON PIN
2	1,457,349.42	2,430,659.68	654.05	IRON PIN
3	1,457,239.11	2,431,980.44	659.08	IRON PIN
4	1,456,452.04	2,431,278.26	655.76	IRON PIN
5	1,455,650.09	2,430,583.90	651.76	IRON PIN

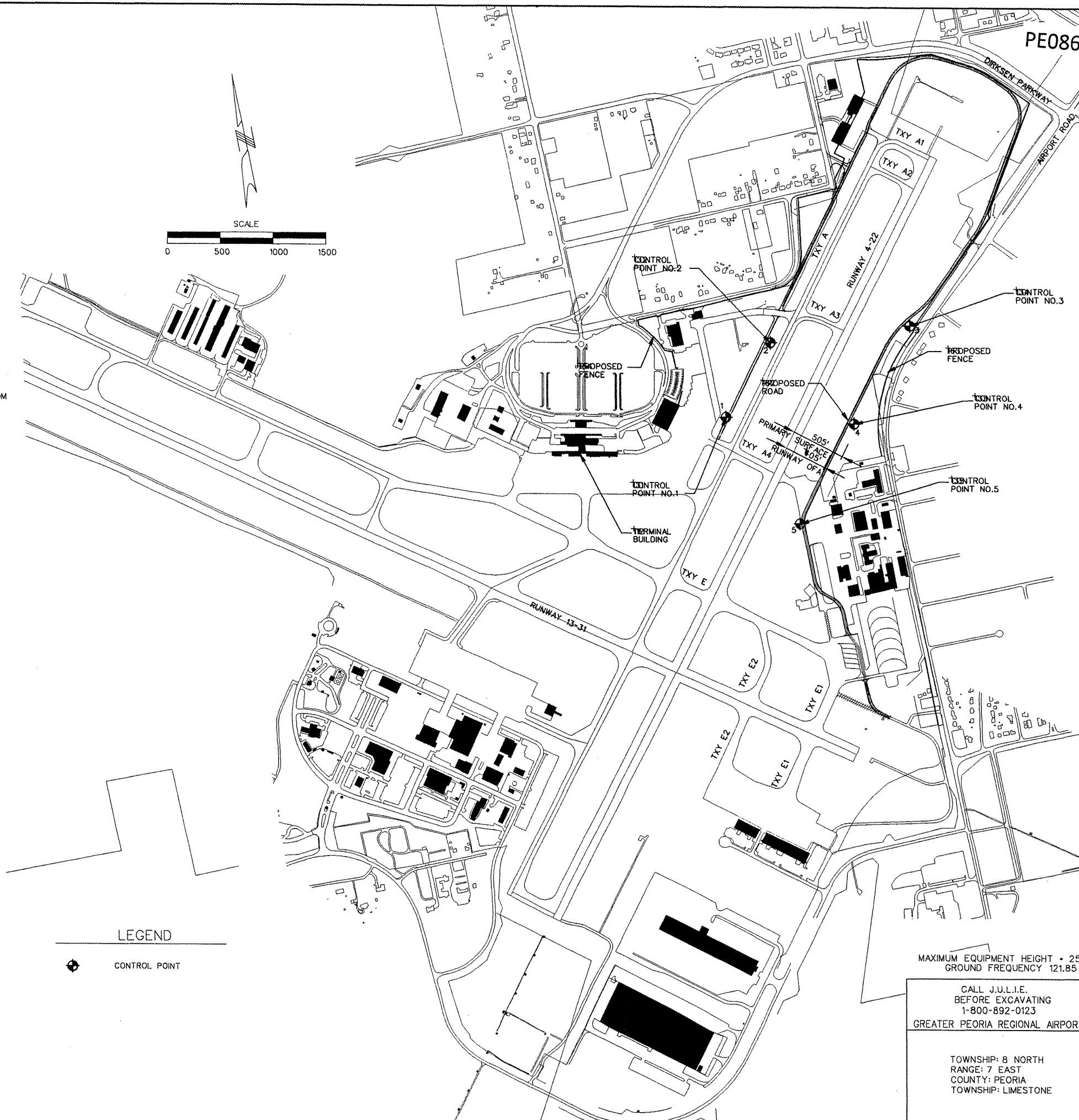

REVISIONS

NUMBER	BY	DATE

0 1 2
THIS BAR IS EQUAL TO 2" AT FULL SCALE (34X22).
PLOT 1

GREATER Peoria REGIONAL Airport

CONSTRUCT NEW PERIMETER ROAD AND PERIMETER FENCE - PROJECT 1

CMT
CRAWFORD, MURPHY & TILLY, INC.
CONSULTING ENGINEERS
©Copyright CMT, Inc.

IL PROJECT: PIA-3343
AP PROJ: 347-0080-XX

FILE: ...Draw\Sheets\003_SitePlan.dgn
DESIGN BY: TWM, RBL
DRAWN BY: CAG
CHECKED BY: RBL
APPROVED BY: CET
DATE: APRIL 24, 2008
JOB No: 0706104

SITE PLAN
SHEET 3 OF 140 SHEETS

MAXIMUM EQUIPMENT HEIGHT = 25'
GROUND FREQUENCY 121.85

CALL J.U.L.I.E.
BEFORE EXCAVATING
1-800-892-0123
GREATER PEORIA REGIONAL AIRPORT

TOWNSHIP: 8 NORTH
RANGE: 7 EAST
COUNTY: PEORIA
TOWNSHIP: LIMESTONE

4/23/2008 K:\Peoria\070610400\Draw\Sheets\003_SitePlan.dgn