

F.A.I. RTE.	SECTION	COUNTY	TOTAL SHEETS	SHEET NO.
74	(48-26HB-4)I	KNOX	54	12
STA. 620+00		TO STA. 635+00		
FED. ROAD DIST. NO.	ILLINOIS	FED. AID PROJECT		

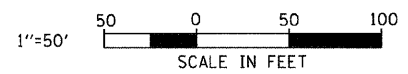

MATCHLINE STA. 620+00

MATCHLINE STA. 635+00

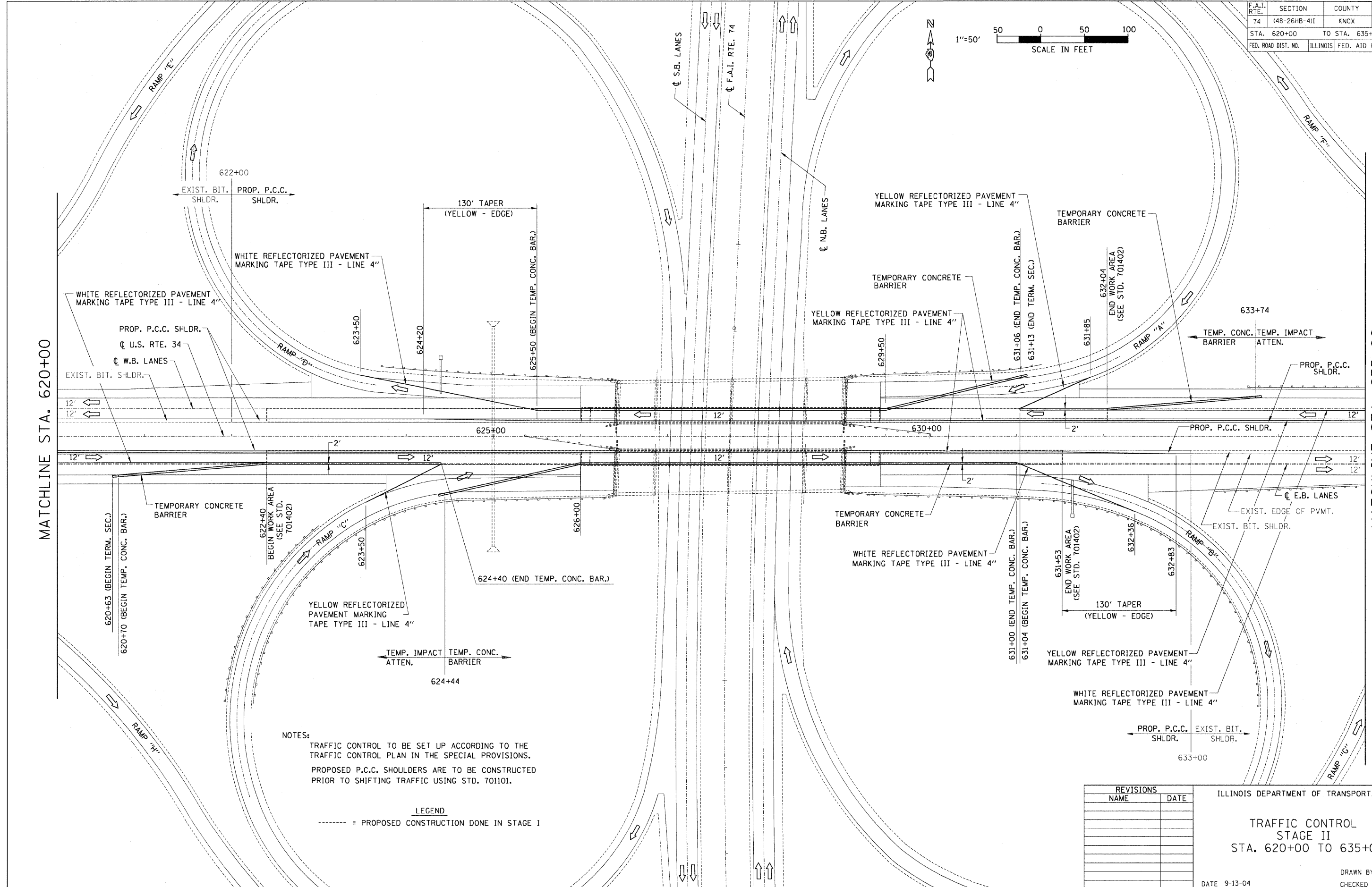

NOTES:
 TRAFFIC CONTROL TO BE SET UP ACCORDING TO THE TRAFFIC CONTROL PLAN IN THE SPECIAL PROVISIONS.
 PROPOSED P.C.C. SHOULDERS ARE TO BE CONSTRUCTED PRIOR TO SHIFTING TRAFFIC USING STD. 701101.

LEGEND
 - - - - - = PROPOSED CONSTRUCTION DONE IN STAGE I

REVISIONS	
NAME	DATE

ILLINOIS DEPARTMENT OF TRANSPORTATION
 TRAFFIC CONTROL
 STAGE II
 STA. 620+00 TO 635+00

DATE 9-13-04
 DRAWN BY SRS
 CHECKED BY ACW