

F.A.P. RTE.	SECTION	COUNTY	TOTAL SHEETS	SHEET NO.
693	*	TAZEWELL	54	36
STA.		TO STA.		
FED. ROAD DIST. NO.		ILLINOIS FED. AID PROJECT		
*10, 15RS-5, 9RS, 13RS-2, 15RS-4				
CONTRACT NO. 68892				

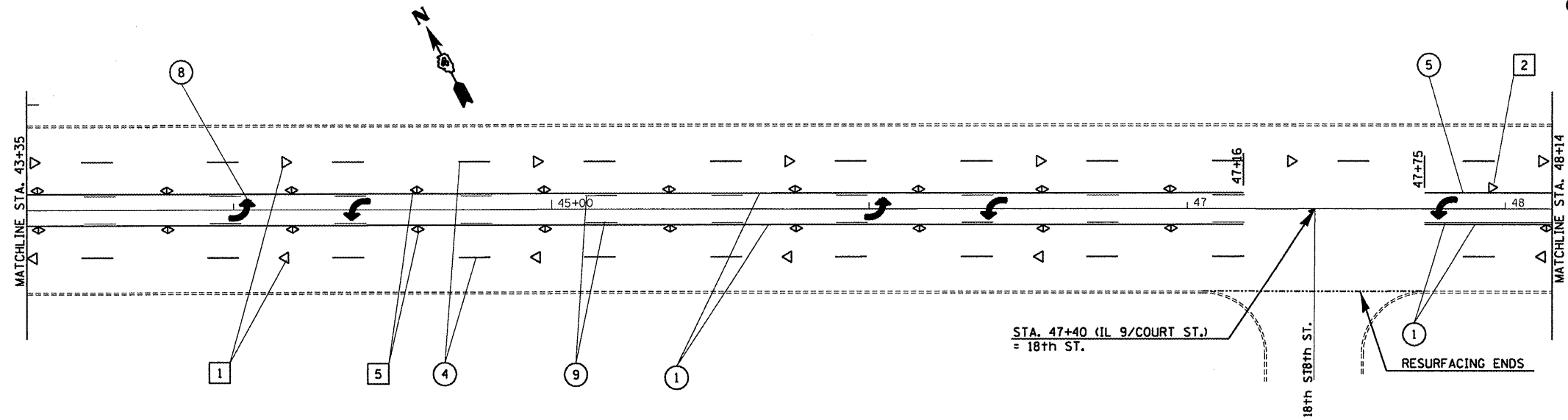

PAVEMENT MARKING LEGEND		RAISED REFLECTIVE PAVEMENT MARKERS (RRPM)	
①	100 (4) SOLID (YELLOW)	①	ONE-WAY CRYSTAL MARKER AT 24.38 m(80') CENTERS
②	100 (4) SOLID (WHITE)	②	ONE-WAY CRYSTAL MARKER AT 12.19 m(40') CENTERS
③	2-150 (6) CROSSWALK @ min. 2 m (6.5') C.C. (WHITE)	③	ONE-WAY CRYSTAL MARKER AT 6.10 m(20') CENTERS
④	2-200 (8) CROSSWALK @ min. 2 m (6.5') C.C. (WHITE)	④	ONE-WAY AMBER MARKER AT 12.19 m(40') CENTERS
⑤	150 (6) SKIP DASH (WHITE)	⑤	TWO-WAY AMBER MARKER AT 12.19 m(40') CENTERS
⑥	200 (8) SOLID (WHITE)	⑥	ONE-WAY CRYSTAL MARKER
⑦	300 (12) DIAGONAL (WHITE)	⑦	ONE-WAY AMBER MARKER
⑧	600 (24) STOP BAR (WHITE)		
⑨	LETTERS AND ARROWS		
⑩	100 (4) SKIP DASH (YELLOW)		
⑪	300 (12) DIAGONAL (YELLOW)		
⑫	100 (4) DOUBLE (YELLOW)		
⑬	400 (16) SOLID (WHITE)		

DELINEATORS	
①	DELINEATOR WITH TWO AMBER REFLECTORS
②	DELINEATOR WITH THREE AMBER REFLECTORS

All dimensions are in millimeters (inches) unless otherwise shown.

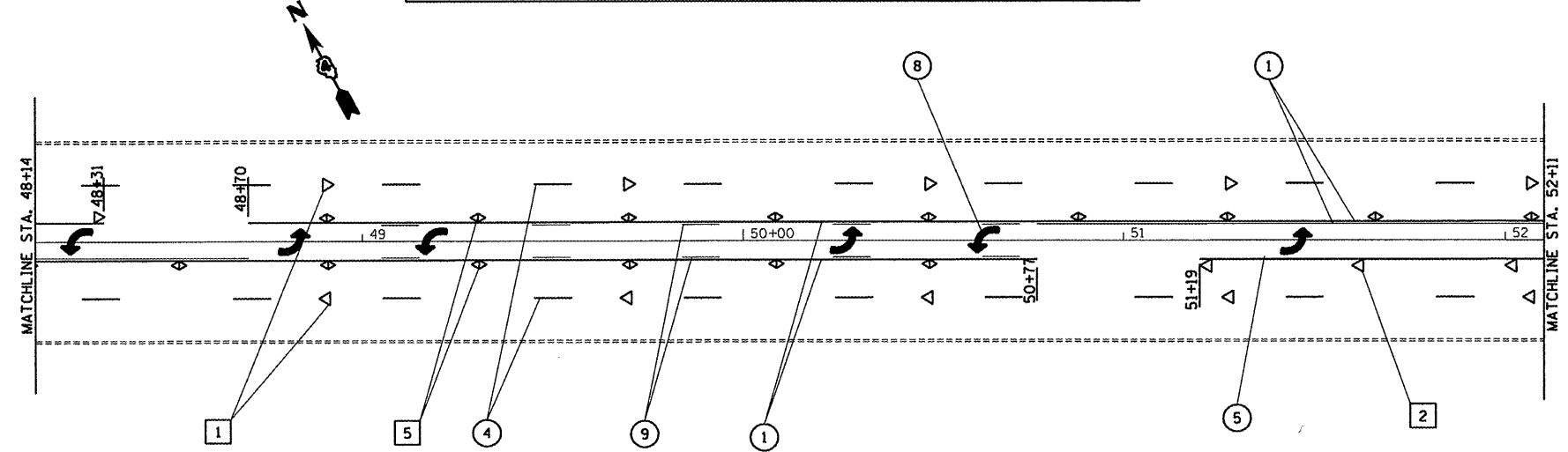
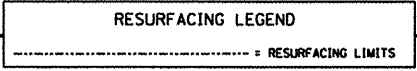
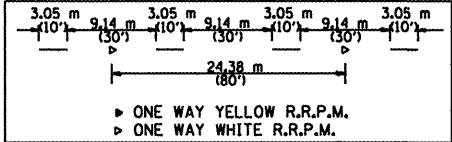

REVISIONS	
NAME	DATE

ILLINOIS DEPARTMENT OF TRANSPORTATION  
**PAVEMENT MARKING  
 DETAILS &  
 RESURFACING LIMITS**  
 COURT ST./IL. 9 43+35 TO STA. 52+11  
 DRAWN BY \_\_\_\_\_  
 CHECKED BY \_\_\_\_\_  
 DATE \_\_\_\_\_

\$\$\$DATE\$\$\$  
 \*DGN-ONLY\*