

F.A.P. RTE.	SECTION	COUNTY	TOTAL SHEETS	SHEET NO.
693		TAZEWELL	54	35
STA. _____		TO STA. _____		
FED. ROAD DIST. NO. _____		ILLINOIS FED. AID PROJECT _____		
(10, 15RS-5, 9RS, 13RS-2, 15RS-4)				
CONTRACT NO. 68892				

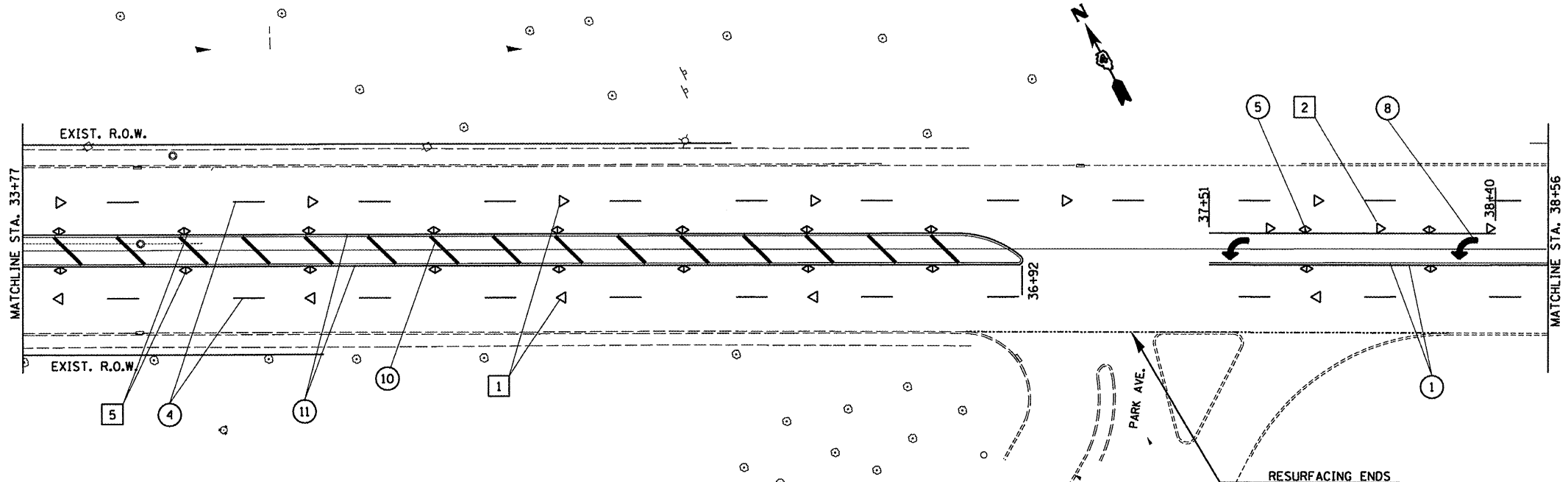

PAVEMENT MARKING LEGEND

- ① 100 (4) SOLID (YELLOW)
- ② 100 (4) SOLID (WHITE)
- ③ 2-150 (6) CROSSWALK @ min. 2 m (6.5') c.c. (WHITE)
- ④ 2-200 (8) CROSSWALK @ min. 2 m (6.5') c.c. (WHITE)
- ⑤ 150 (6) SKIP DASH (WHITE)
- ⑥ 200 (8) SOLID (WHITE)
- ⑦ 300 (12) DIAGONAL (WHITE)
- ⑧ 600 (24) STOP BAR (WHITE)
- ⑨ LETTERS AND ARROWS
- ⑩ 100 (4) SKIP DASH (YELLOW)
- ⑪ 300 (12) DIAGONAL (YELLOW)
- ⑫ 100 (4) DOUBLE (YELLOW)
- ⑬ 400 (16) SOLID (WHITE)

RAISED REFLECTIVE PAVEMENT MARKERS (RRPM)

- 1 ONE-WAY CRYSTAL MARKER AT 24.38 m(80') CENTERS
- 2 ONE-WAY CRYSTAL MARKER AT 12.19 m(40') CENTERS
- 3 ONE-WAY CRYSTAL MARKER AT 6.10 m(20') CENTERS
- 4 ONE-WAY AMBER MARKER AT 12.19 m(40') CENTERS
- 5 TWO-WAY AMBER MARKER AT 12.19 m(40') CENTERS
- 6 ONE-WAY CRYSTAL MARKER
- 7 ONE-WAY AMBER MARKER

DELINEATORS

- 8 DELINEATOR WITH TWO AMBER REFLECTORS
- 9 DELINEATOR WITH THREE AMBER REFLECTORS

All dimensions are in millimeters (inches) unless otherwise shown.

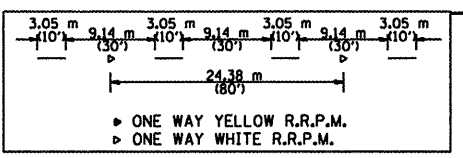

RESURFACING LEGEND

- RESURFACING LIMITS
- ▨ BIT. SURF. REMOVAL VARIABLE DEPTH

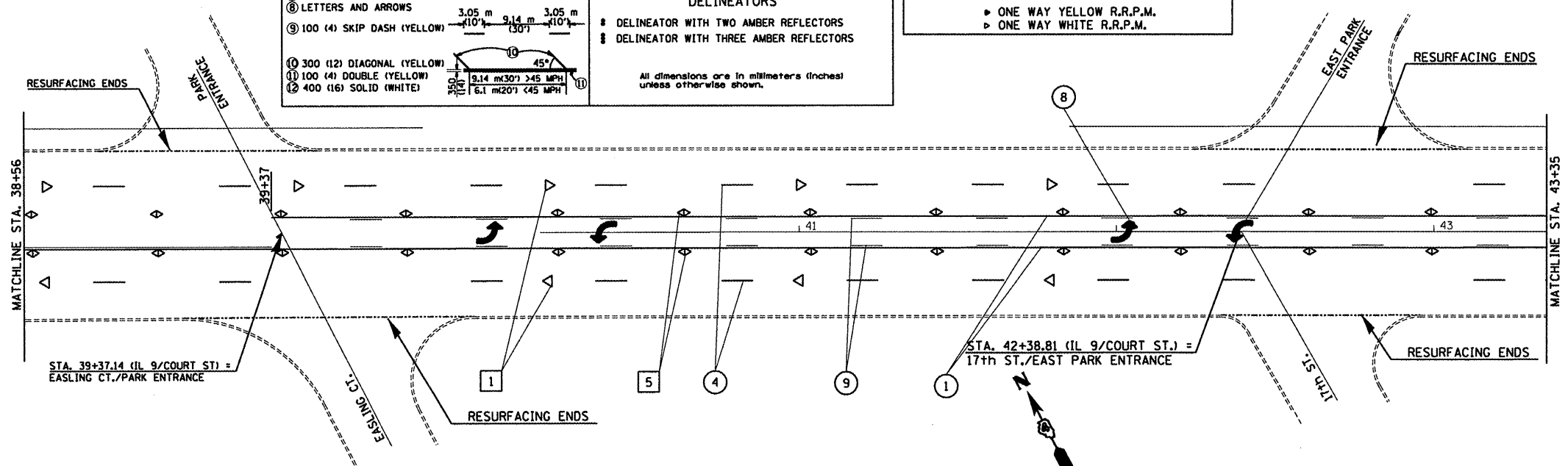

REVISIONS	
NAME	DATE

ILLINOIS DEPARTMENT OF TRANSPORTATION
**PAVEMENT MARKING
 DETAILS &
 RESURFACING LIMITS**
 COURT ST./IL. 9 33+77 TO STA. 43+35
 DRAWN BY _____
 CHECKED BY _____
 DATE _____

\$\$\$DATE\$\$\$
 DGN-ONLY