

F.A.P. RTE.	SECTION	COUNTY	TOTAL SHEETS	SHEET NO.
693		TAZEWELL	54	33
STA. _____		TO STA. _____		
FED. ROAD DIST. NO. _____ ILLINOIS FED. AID PROJECT				
*10, 15RS-5, 9RS, 13RS-2, 15RS-4				
CONTRACT NO. 68892				

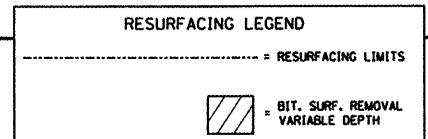
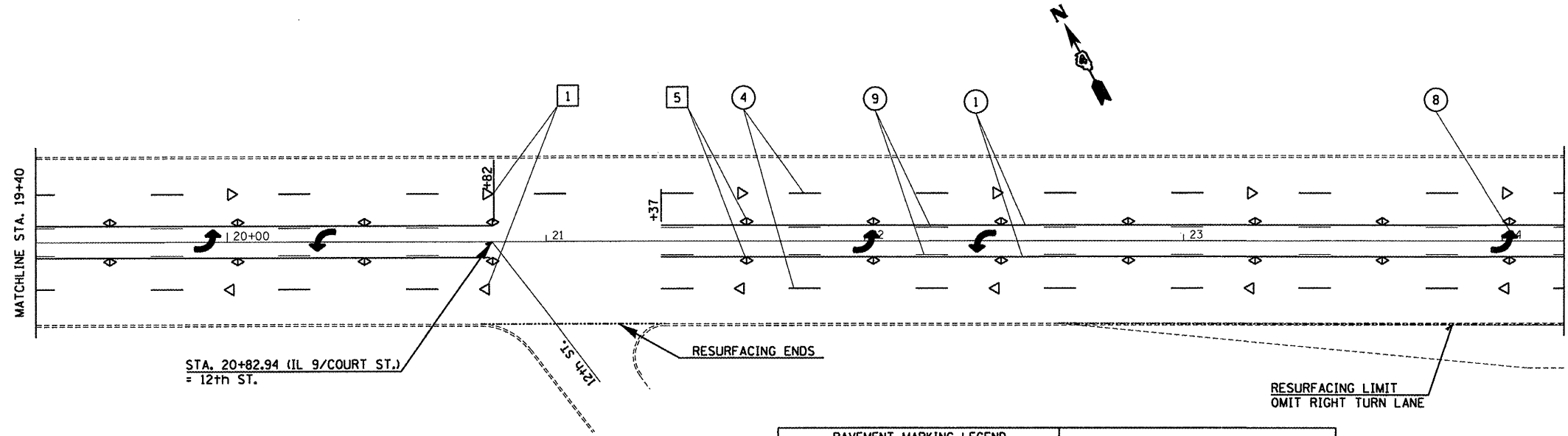

PAVEMENT MARKING LEGEND		RAISED REFLECTIVE PAVEMENT MARKERS (RRPM)	
① 100 (4) SOLID (YELLOW)		1 < ONE-WAY CRYSTAL MARKER AT 24.38 m(80') CENTERS	
② 100 (4) SOLID (WHITE)		2 < ONE-WAY CRYSTAL MARKER AT 12.19 m(40') CENTERS	
③ 2-150 (6) CROSSWALK @ min. 2 m (6.5') c.c. (WHITE)		3 < ONE-WAY CRYSTAL MARKER AT 6.10 m(20') CENTERS	
④ 150 (6) SKIP DASH (WHITE)		4 < ONE-WAY AMBER MARKER AT 12.19 m(40') CENTERS	
⑤ 200 (8) SOLID (WHITE)		5 < TWO-WAY AMBER MARKER AT 12.19 m(40') CENTERS	
⑥ 300 (12) DIAGONAL (WHITE)		< ONE-WAY CRYSTAL MARKER	
⑦ 600 (24) STOP BAR (WHITE)		< ONE-WAY AMBER MARKER	
⑧ LETTERS AND ARROWS			
⑨ 100 (4) SKIP DASH (YELLOW)			
⑩ 300 (12) DIAGONAL (YELLOW)			
⑪ 100 (4) DOUBLE (YELLOW)			

DELINEATORS	
	DELINEATOR WITH TWO AMBER REFLECTORS
	DELINEATOR WITH THREE AMBER REFLECTORS

All dimensions are in millimeters (inches) unless otherwise shown.

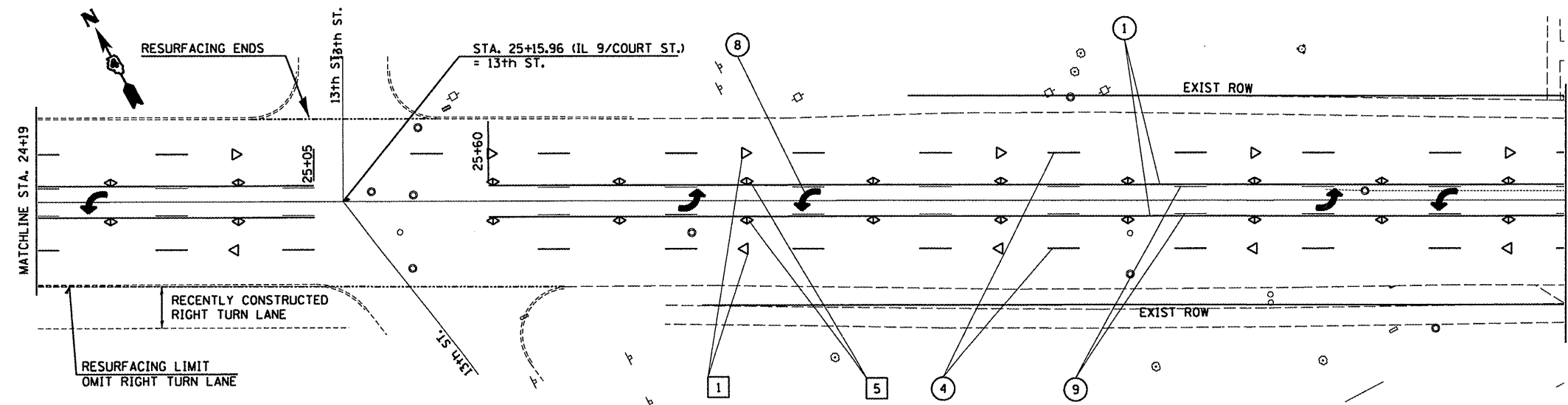
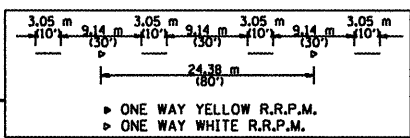

REVISIONS	
NAME	DATE

ILLINOIS DEPARTMENT OF TRANSPORTATION
**PAVEMENT MARKING
 DETAILS &
 RESURFACING LIMITS**
 COURT ST./IL. 9 19+40 TO STA. 28+98
 DRAWN BY _____
 CHECKED BY _____
 DATE _____

\$\$\$DATE\$\$\$
 DCN-ONLY