

IL. RTE. 1
(DIXIE HIGHWAY)

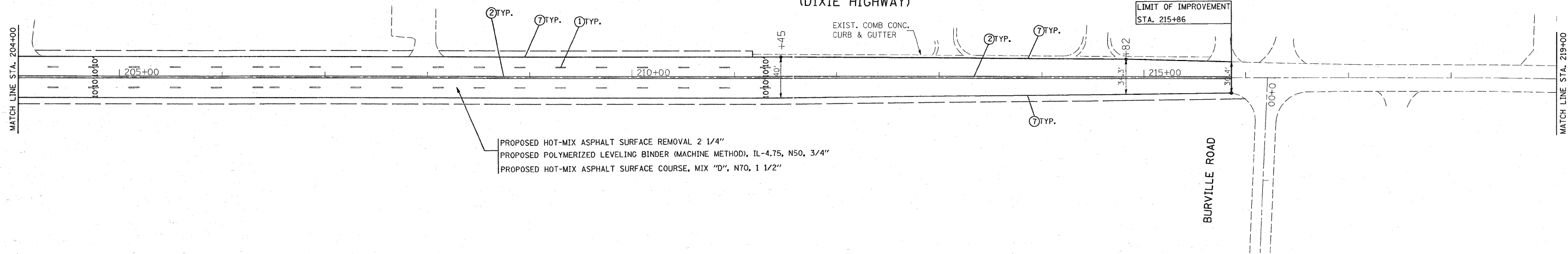

PROPOSED HOT-MIX ASPHALT SURFACE REMOVAL 2 1/4"
 PROPOSED POLYMERIZED LEVELING BINDER (MACHINE METHOD), IL-4.75, N50, 3/4"
 PROPOSED HOT-MIX ASPHALT SURFACE COURSE, MIX "D", N70, 1 1/2"

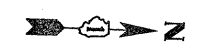

IL. RTE. 1
(DIXIE HIGHWAY)

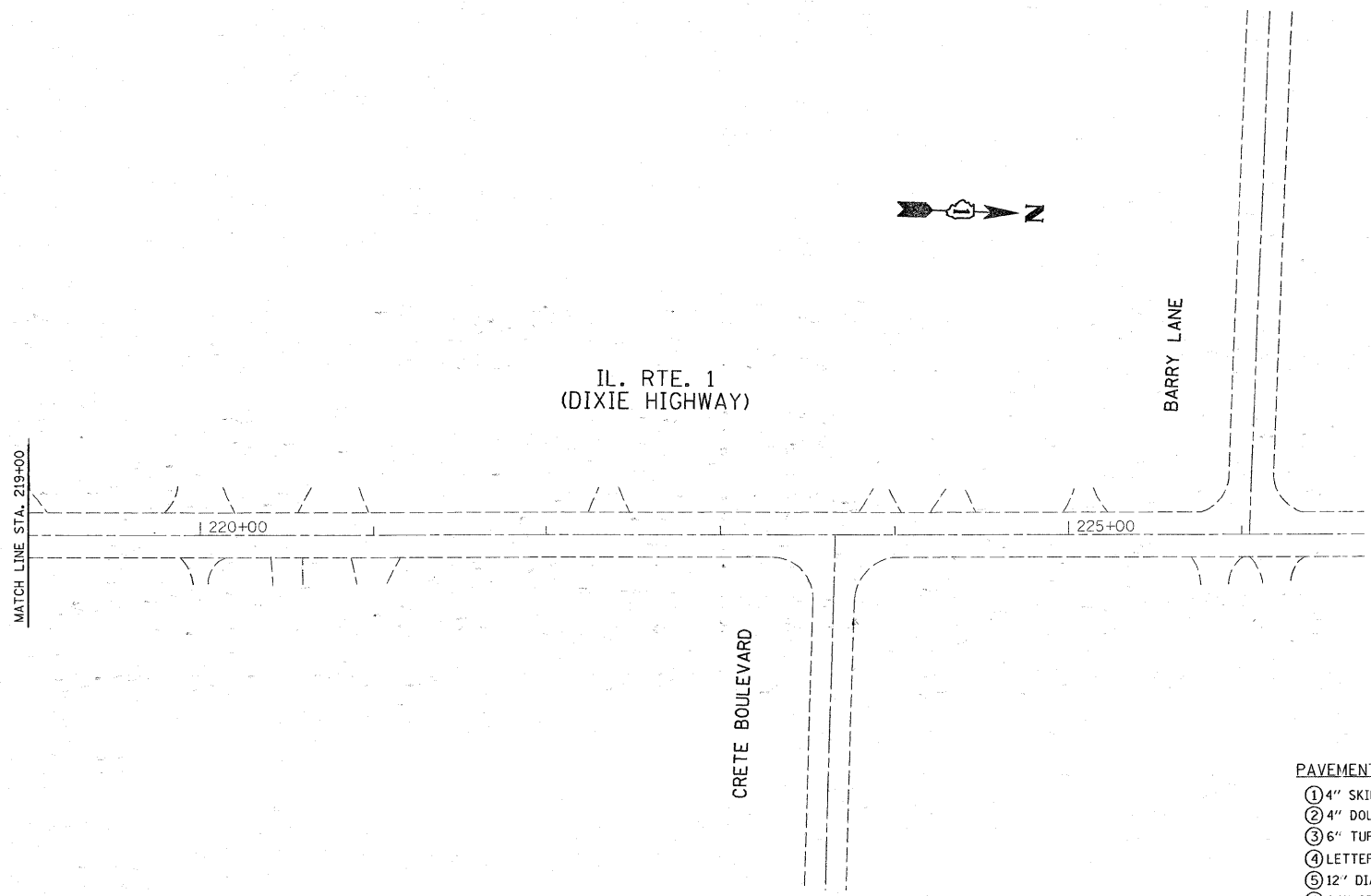

PAVEMENT MARKING LEGEND

- ① 4" SKIP DASH LANE LINE- WHITE
- ② 4" DOUBLE YELLOW
- ③ 6" TURN LANE-WHITE
- ④ LETTERS & SYMBOLS-WHITE
- ⑤ 12" DIAGONALS-YELLOW @ 45°
- ⑥ 24" STOP BAR-WHITE
- ⑦ 4" EDGE LINE-WHITE

NOTES

LIMIT OF RESURFACING ON SIDE-STREETS THROUGH OUT THE IMPROVEMENT SHALL BE TO THE RADIUS OF RETURN OR AS DIRECTED BY THE ENGINEER.

ALL FINAL PAVEMENT MARKINGS SHALL BE THERMOPLASTIC (OF THE EXTRUDED TYPE) AND SHOULD BE PLACED IN ACCORDANCE WITH "DISTRICT ONE TYPICAL PAVEMENT MARKINGS" DETAIL, (TC-13).

ALL RAISED REFLECTIVE PAVEMENT MARKERS SHALL BE PLACED IN ACCORDANCE WITH THE DISTRICT ONE "TYPICAL APPLICATIONS RAISED REFLECTIVE PAVEMENT MARKER DETAIL." (TC-11).

FILE NAME =	USER NAME = abreuah	DESIGNED -	REVISED -	STATE OF ILLINOIS DEPARTMENT OF TRANSPORTATION	IL. ROUTE 1 (MAIN ST./S. DIXIE HIGHWAY) ROADWAY AND PAVEMENT MARKING PLAN		F.A.P. RTE.	SECTION	COUNTY	TOTAL SHEETS	SHEET NO.	
ct:\pw_work\pwwid\abreuah\dms88408\sh...		DRAWN -	REVISED -				876	(9Y&10)RS-5	WILL	23	11	
	PLOT SCALE = 50.0000' / IN.	CHECKED -	REVISED -		SCALE: 1" = 50'		SHEET NO. OF SHEETS		STA. 204+00 TO STA. 225+00		CONTRACT NO. 62657	
	PLOT DATE = 4/14/2009	DATE -	REVISED -		FED. ROAD DIST. NO. 1 ILLINOIS FED. AID PROJECT							