

STRIPING LEGEND

- ① 4" EDGE LINE - WHITE
- ② 4" SKIP DASH CENTERLINE - YELLOW
- ③ 4" SOLID CENTERLINE - YELLOW
- ④ 4" DOUBLE - YELLOW
- ⑤ 6" TURN LANE - WHITE
- ⑥ LETTERS & SYMBOLS - WHITE
- ⑦ 24" STOP BAR - WHITE
- ⑧ 8" ISLAND OUTLINE - WHITE
- ⑨ 12" DIAGONALS - YELLOW

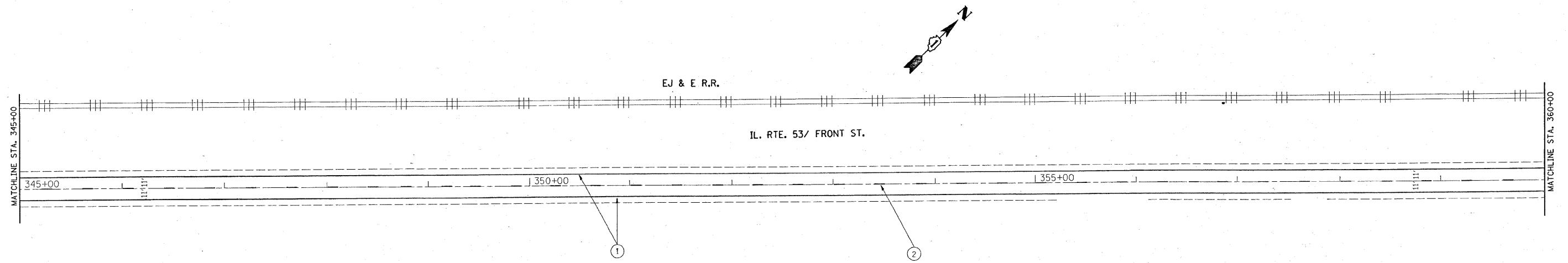

FILE NAME = <small>ca:\pw\work\NPM\DOT\MQSSSE\8118419\sh_rdd.dgn</small>	USER NAME = moisse	DESIGNED -	REVISED -	STATE OF ILLINOIS DEPARTMENT OF TRANSPORTATION	IL. RTE. 53 (FIRST ST. TO WILL COUNTY LINE) ROADWAY PLAN			F.A. RTE. 846	SECTION 5RS-2	COUNTY WILL	TOTAL SHEETS 31	SHEET NO. 16		
	PLOT SCALE = 500.0000 1" / IN.	CHECKED -	REVISED -		SCALE: 1" = 50'	SHEET NO. OF SHEETS	STA. 330+00.00 TO STA. 360+00.00	FED. ROAD DIST. NO. 1 ILLINOIS FED. AID PROJECT						
	PLOT DATE = 3/26/2009	DATE -	REVISED -		CONTRACT NO. 62648									