

CONTRACT NO. 76D61	
F.A. ROUTE	SECTION
999	82-1B-2
FED. AID PROJECT	ILLINOIS
COUNTY	ST. CLAIR
USER NAME = jgj11ff	
PLOT SCALE = #SCALE#	
PLOT DATE = 4/14/2010	
DESIGNED -	HNTB
CHECKED -	CMT
DRAWN -	CMT / HNTB
REVISED -	
REVISED -	
REVISED -	
REVISED -	

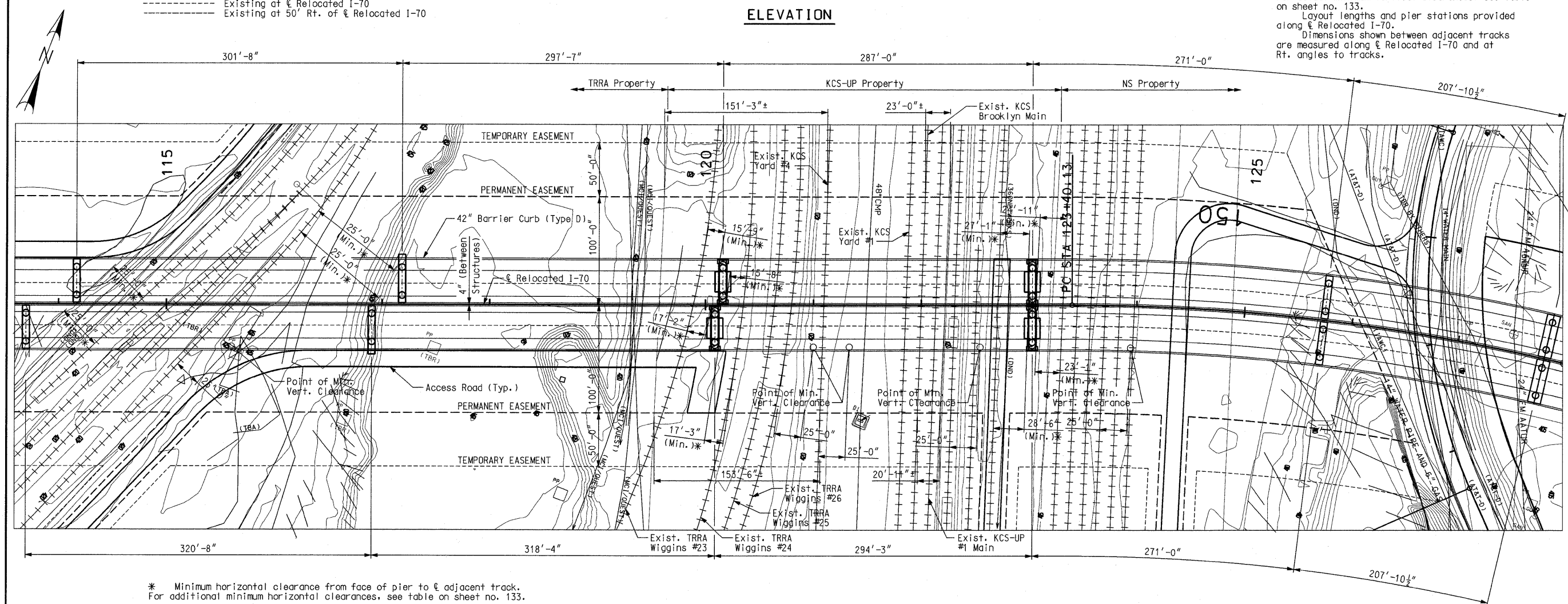
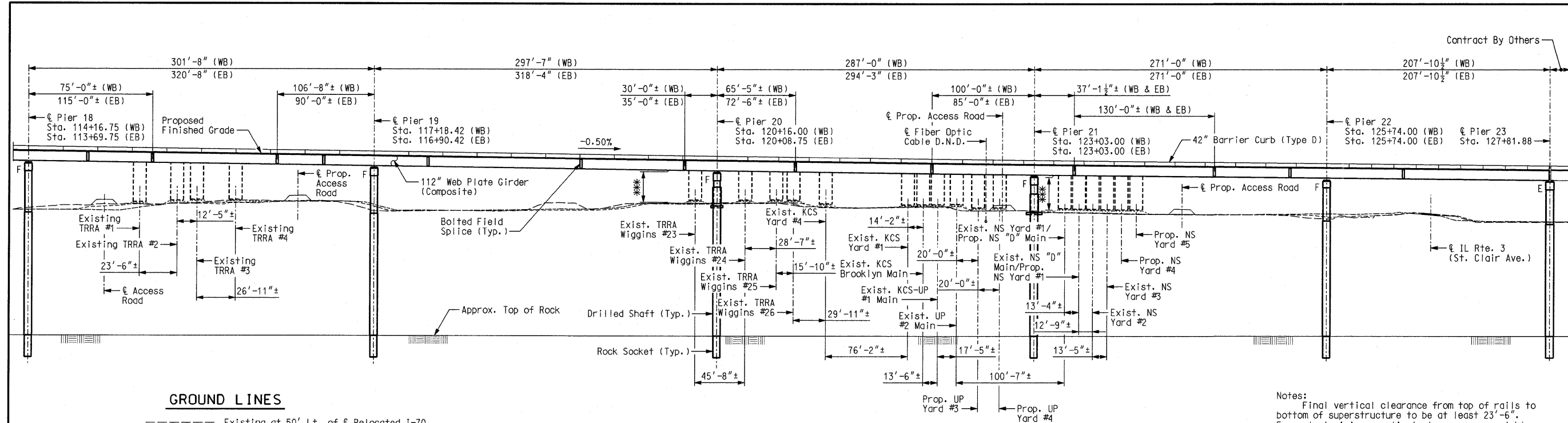

* Minimum horizontal clearance from face of pier to & adjacent track. For additional minimum horizontal clearances, see table on sheet no. 133.
 *** 23'-6" minimum vertical clearance across KCS and UPRR R.O.W.

Detailed JUL 2009
 Checked JUL 2009

Note: This drawing is not to scale. Follow dimensions.

Sheet No. 132 of 152

s:\idot\0906601\draw_idot\cadd_sheets\structural\B_A6500_132-152_J610984C_132.dgn

ILLINOIS APPROACH STRUCTURE
 FOR NEW I-70 MISSISSIPPI RIVER BRIDGE

STATE OF ILLINOIS
 DEPARTMENT OF TRANSPORTATION
 MISSOURI HIGHWAYS
 AND TRANSPORTATION COMMISSION

HNTB
 715 KIRK DRIVE
 KANSAS CITY, MO 64105
 TELEPHONE (816) 472-1201
 CERTIFICATE OF AUTHORITY
 NO. 001270

CMT
 CRAWFORD, MURPHY & TILLY, INC.
 2750 WEST WASHINGTON STREET
 SPRINGFIELD, IL 62702
 TELEPHONE (217) 787-8050
 ENGINEERING CORPORATION - 000631